

NOTES: (POWER PLAN ONLY)

- 1. PROVIDE OUTLETS IN METAL CEILING PANEL ENCLOSURE AS SPECIFIED WITH PROJECTOR MOUNT. COORDINATE EXACT LOCATION WITH ARCHITECTURAL REFLECTED CEILING PLAN. LIGHT FIXTURES, ELECTRICAL USE ONLY MOUNTED DEVICES AND WIRING SHALL BE SHOWN IN THE DETAIL.
- 2. PROVIDE AUDIO VISUAL CONNECTIVITY, PROJECTOR, AND MOUNTING HARDWARE AS SPECIFIED AND SHOWN IN THE DETAIL.
- 3. ROUTE #120, #125, 127C AND MAKE POWER CONNECTION TO EXISTING TEACHERS CORRIDOR CIRCUIT ABOVE CEILING.
- 4. EXISTING 0E, TYPE 40E, 120000V, 30% 40, PANELBOARD.
- 5. EXISTING 0E, TYPE 40E, 207400V, 30% 40, PANELBOARD.
- 6. CONNECT TO EXISTING PANEL INDICATED. PROVIDE A 30 AMP CIRCUIT BREAKER AND #14, #10 CONDUCTORS IN 1/2" CONDUIT AND MAKE ALL CONNECTIONS.

REVISIONS/ISSUANCES		
NO.	DATE	DESCRIPTION

KEYPLAN	
AH&P CONSULTING ENGINEERS AND ARCHITECTS ANDREWS, HAMBROOK & POWELL, INC. 250 Centre Lane, Suite 101 MACON, GEORGIA 31210 FAX (478) 465-8213 WWW.AHPENR.COM	
Manley Spangler Smith Architects A Professional Corporation 525 East Taylor St. P.O. Box 885 Griffin, Georgia 30224 Office 770.227.5473 Fax 770.228.3442	
PROJECT: RENOVATIONS, MODIFICATIONS, & ADDITIONS TO HENRY COUNTY SCHOOLS - GROUP 10 WOODLAND HIGH SCHOOL (ITEM C) CLIENT: HENRY COUNTY BOARD OF EDUCATION SHEET TITLE: ELECTRICAL NEW WORK POWER PLAN - SECTOR "E" SHEET NO.: E208	

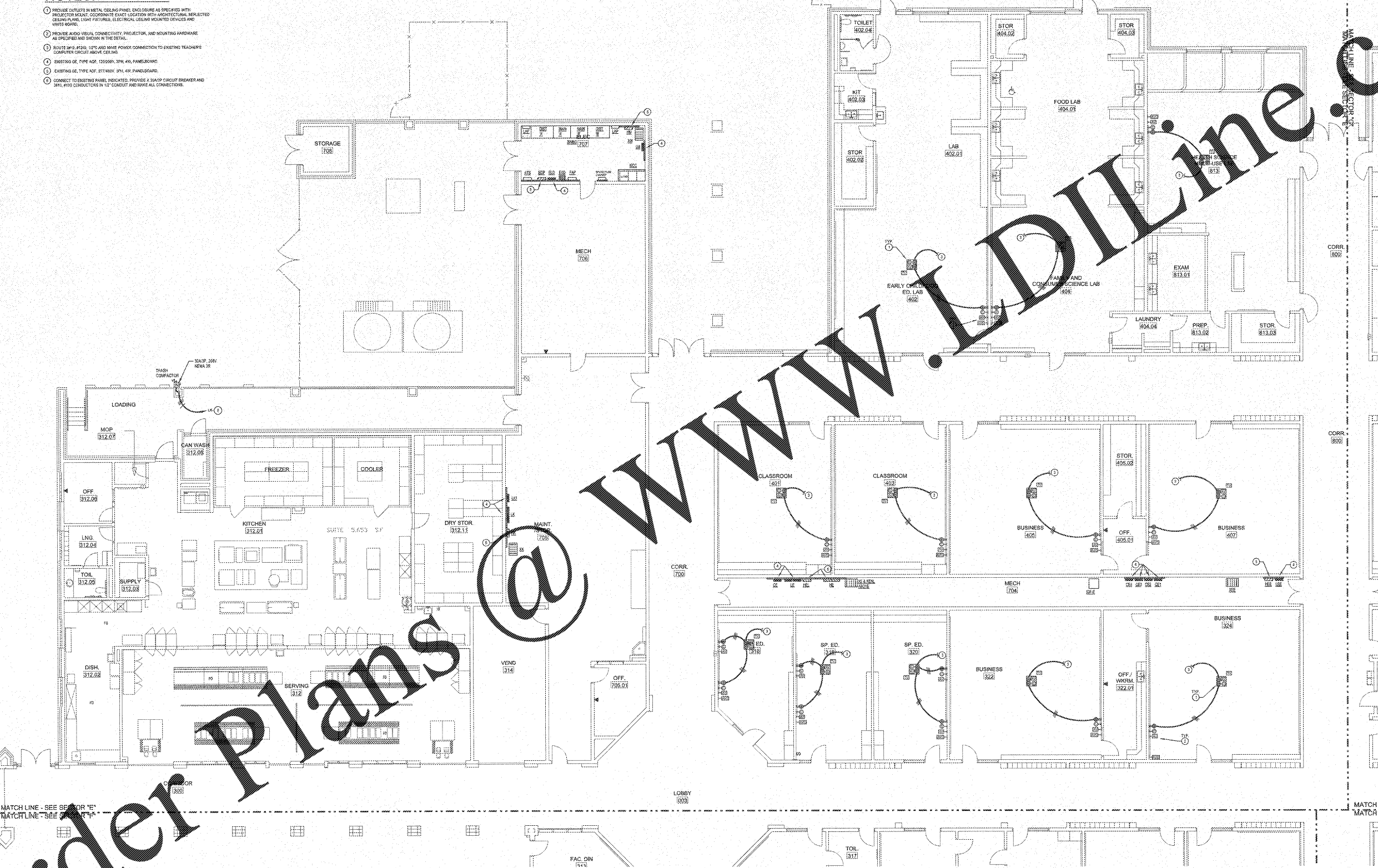

NOTE TO CONTRACTOR CONCERNING PROJECT PHASING:
 THE WORK SHOWN ON THESE DRAWINGS AND SPECIFICATIONS ILLUSTRATES THE COMPLETE PROJECT. THIS PROJECT IS PHASED IN ACCORDANCE WITH THE WORK OF EACH PHASE IS DESCRIBED IN THE ARCHITECTURAL DOCUMENTS AND THE CONTRACTOR SHALL REVIEW THESE DRAWINGS AND SPECIFICATIONS. CONTRACTOR SHALL INQUIRE IN HIS BID ALL COSTS REQUIRED TO ACCOMPLISH THE CONTRACT IN PHASES. THE CONTRACT DOCUMENTS DO NOT CONSTITUTE THE SPECIFIC WORK REQUIRED BY THE CONTRACTOR TO PERFORM THE PROJECT IN PHASES, BUT CONTRACTOR SHALL PREPARE PHASING PLAN AND SUBMIT TO ARCHITECT/SUPPLIER AND HENRY COUNTY MAINTENANCE DEPARTMENT PRIOR TO BEGINNING WORK.

GENERAL NOTES

- WHERE CIRCUITS ARE FOUND (UTG AND CONDUIT TYPES) FOR GROUNDING PATH, THE CONTRACTOR SHALL TEST AND VERIFY CONTINUITY OF THIS GROUNDING PATH IN THE EXISTING GROUNDING PATHS DETERMINED TO BE NON-COMPLIANT. THE CONTRACTOR SHALL REMEDY THAT BY PROVIDING #12 GROUNDING CONDUCTOR IN EXISTING CONDUIT BACK TO PANEL.
- ELECTRICAL INSTALLATIONS ON EXISTING WALLS SHALL HAVE CIRCUITS INSTALLED CONCEALED WITHIN MASONRY. CONTRACTOR SHALL NOT UNDER ANY CIRCUMSTANCES UTILIZE SURFACE METAL RACEWAY TO INSTALL NEW DEVICES (WAVE VOLTAGE ON LOW VOLTAGE). RINGS SHALL BE SET INTO EXISTING MASONRY WITH FLEX CONDUIT FIBER IN EXISTING WALL FROM ABOVE ACCESSIBLE CEILING.
- LOW VOLTAGE SYSTEMS OUTLETS SHOWN FOR INSTALLATION COORDINATION PURPOSES ONLY. SEE APPLICABLE LOW VOLTAGE FLOOR PLAN FOR OTHER REQUIREMENTS.

ELECTRICAL NEW WORK POWER PLAN - SECTOR "E"
 SCALE: 1/8"=1'-0"

Order Plans @

WWW.AJDLINE.COM