

- NOTES: (THIS SHEET ONLY)**
- GENERAL ALL CONDUITS SHALL BE ROUTED CONCEALED IN WALLS AND ABOVE CEILING AS SHOWN.
 - COORDINATE EXACT MOUNTING HEIGHT AND LOCATION OF HAND DRIVER WITH ARCHITECT.
 - IN GROUNDING CONDUCTOR IN 1/2" FROM OF AND PA-1 TO PANEL INDICATED PROVIDE #8 BLACK CONDUCTOR FOR CONNECTIONS.
 - PROVIDE OUTLETS IN METAL CEILING PANEL ENCLOSURE AS SPECIFIED WITH PROTECTOR MOUNT. COORDINATE EXACT LOCATION WITH ARCHITECTURAL REFLECTED CEILING PLANS, LIGHT FIXTURES, ELECTRICAL CEILING MOUNTED DEVICES AND WHITE BOARD.
 - PROVIDE AUDIO VISUAL CONNECTIVITY, PROJECTOR, AND MOUNTING HARDWARE AS SPECIFIED AND SHOWN IN THE DETAIL.
 - PROVIDE A 1/2"x1/2" JUNCTION BOX AT 5' 0" A.F.F. ADJACENT BLEACHERS DISCONNECT. COORDINATE EXACT LOCATION WITH BLEACHERS INSTALLER.
 - ALL RACEWAY BELOW 16 A.F.F. SHALL BE CONCEALED IN WALL IN THE GYMNASIUM.
 - PROVIDE OUTLET NECESSARY WITHIN FIRST STEP RISE OF THE FOLDING BLEACHERS. SECURE CONDUITORS IN FLEXIBLE RACEWAY TO UNDERSEAT OF BLEACHER SECTION. COORDINATE WITH BLEACHER INSTALLER.
 - SMOKE DAMPER INTERFACE RELAY FURNISHED WITH FIRE ALARM SYSTEM. MAKE CONNECTIONS TO AND THROUGH RELAY AS SHOWN.
 - MOUNT JUNCTION BOX AT 5' 0" A.F.F. TO ACCEPT CONTROL SWITCHES FROM MANUFACTURER.
 - PROVIDE EQUIPMENT OVER CONTROLS. PROVIDE ALL SUPPORT OUTLETS TO BE COORDINATE EXACT LOCATION WITH MANUFACTURER.
 - GENERAL ELECTRICAL EQUIPMENT REQUIREMENTS ARE SHOWN IN THE SCHEDULED EQUIPMENT SECTION.
 - PROVIDE 1/2" RIGID NON-METAL REFRIGERANT CONDUIT WITH 3/4" IN MEAN I ENCLASURE. COORDINATE EXACT LOCATION WITH BLEACHERS INSTALLER.

REVISIONS/ISSUANCES		
NO.	DATE	DESCRIPTION

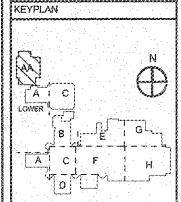

AH&P
 CONSULTING ENGINEERS
 ANDREWS, HAINBROOK & POWELL, INC.
 251 Chatham Lane
 Suite 150
 MACON, GEORGIA 31210
 MACON (478) 455-6391
 FAX (478) 455-8219
 WWW.AHPENR.COM



Manley Spangler Smith Architects
 A Professional Corporation

625 East Taylor St.
 P.O. Box 895
 Griffin, Georgia 30224
 Office 770.227.5473
 Fax 770.228.3442

PROJECT: RENOVATIONS, MODIFICATIONS, & ADDITIONS TO HENRY COUNTY SCHOOLS - GROUP 10 WOODLAND HIGH SCHOOL (ITEM C)

CLIENT: HENRY COUNTY BOARD OF EDUCATION

SHEET TITLE: ELECTRICAL NEW WORK POWER PLAN - SECTOR "AA"

11.18.86
 P.E. # 1387
 FACILITY CODE: 475-6408
 © 2018 Manley Spangler Smith Architects, P.C.
 PROJECT NUMBER: 2017010
 DATE: 08.07.18
 SCALE: 1/8"=1'-0"
 DRAWN BY: AJS
 CHECKED BY: NHT

NOTE TO CONTRACTOR CONCERNING PROJECT PHASING:
 THE WORK SPECIFIED ON THE DRAWINGS AND SPECIFICATIONS ILLUSTRATES THE COMPLETED CONTRACTUAL REQUIREMENTS. THIS PROJECT IS PHASED IN MULTIPLE PHASES. THE AREA OF EACH PHASE IS DESCRIBED IN THE ARCHITECTURAL DOCUMENTS AND THE CONTRACTOR SHALL REVIEW THESE PHASING REQUIREMENTS. CONTRACTOR SHALL INCLUDE IN HIS BID ALL COSTS REQUIRED TO ACCOMPLISH THE CONTRACT IN PHASES. THE CONTRACT DOCUMENTS DO NOT DESCRIBE THE SPECIFIC WORK REQUIRED BY THE CONTRACTOR TO PERFORM THE PROJECT IN PHASES, BUT CONTRACTOR SHALL PREPARE PHASING PLAN AND SUBMIT TO ARCHITECT/ENGINEER AND HENRY COUNTY MAINTENANCE DEPARTMENT PRIOR TO BEGINNING WORK.

ELECTRICAL NEW WORK POWER PLAN - SECTOR "AA"
 SCALE: 1/8"=1'-0"

Order Plans @ WWW.LDILine.com

WWW.LDILine.com