

REVISIONS/ISSUANCES		
NO.	DATE	DESCRIPTION

**NOTES: (POWER PLAN ONLY)**

- ① PROVIDE OUTLETS IN METAL CEILING PANEL ENCLOSURE AS SPECIFIED WITH PROJECTOR MOUNT. COORDINATE EXACT LOCATION WITH ARCHITECTURAL REFLECTED CEILING PLANS, LIGHT FIXTURES, ELECTRICAL CEILING MOUNTED DEVICES AND WIRE BUNDLES.
- ② PROVIDE EXACT VERTICAL CONNECTIVITY, PROJECTOR, AND MOUNTING HARDWARE AS SPECIFIED AND SHOWN IN THE DETAIL.
- ③ CONTRACTOR SHALL ROUTE 2015, #100 IN 1/2" O.D. AND MAKE CONNECTION TO EXISTING TEACHERS COMPUTER CORDOUT ABOVE CEILING.
- ④ EXISTING 60, TYPE KCF, 1200REV, 3PH, 4W, PANELBOARD.
- ⑤ EXISTING 60, TYPE ASF, 2714REV, 3PH, 4W, PANELBOARD.

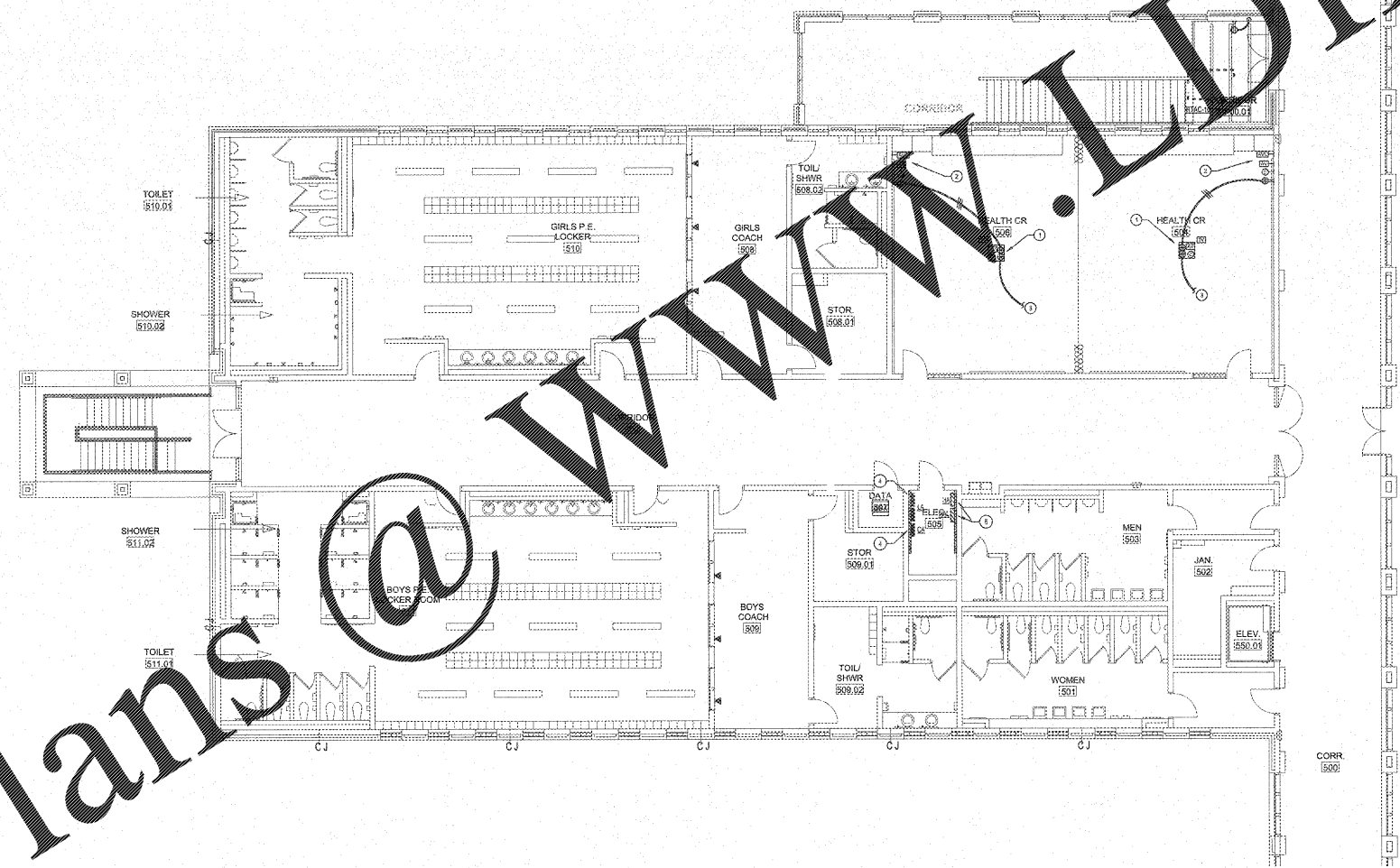

**ELECTRICAL NEW WORK POWER PLAN - SECTOR "A" UPPER LEVEL**

SCALE: 1/8"=1'-0"

**GENERAL NOTES**

1. WHERE CIRCUITS ARE FOUND UTILIZING CONDUIT SYSTEM FOR GROUNDING PATH, THE CONTRACTOR SHALL TEST AND VERIFY CONTINUITY OF THIS GROUNDING PATH. IF THE EXISTING GROUNDING PATH IS DETERMINED TO BE NON-CONTINUOUS, THE CONTRACTOR SHALL REQUEST THAT BY PROVIDING THE GROUNDING CONDUCTOR IN EXISTING CONDUIT BACK TO PANEL.
2. ELECTRICAL INSTALLATIONS ON EXISTING WALLS SHALL HAVE CIRCUITS INSTALLED CONCEALED WITHIN MASONRY. CONTRACTOR SHALL NOT UNDER ANY CIRCUMSTANCES UTILIZE SURFACE METAL RACEWAY TO INSTAL NEW DEVICES (E.G. VOLTAGE OR LOW VOLTAGE). RACES SHALL BE CUT INTO EXISTING MASONRY WITH FLEX CONDUIT RISHED IN EXISTING WALL FROM ABOVE ACCESSIBLE CEILING.
3. LOW VOLTAGE SYSTEMS OUTLETS SHOWN FOR INSTALLATION COORDINATION PURPOSES ONLY. SEE APPLICABLE LOW VOLTAGE FLOOR PLAN FOR OTHER REQUIREMENTS.

**NOTE TO CONTRACTOR CONCERNING PROJECT PHASING:**

THE WORK SHOWN ON THE DRAWINGS AND SPECIFICATIONS ILLUSTRATES THE COMPLETED CONTRACTUAL REQUIREMENTS. THIS PROJECT IS PHASED IN MULTIPLE PHASES. THE AREA OF EACH PHASE IS DESCRIBED IN THE ARCHITECTURAL CONDITIONS AND THE CONTRACTOR SHALL REVIEW THESE PHASING REQUIREMENTS. CONTRACTOR SHALL INCLUDE IN HIS BID ALL COSTS REQUIRED TO ACCOMPLISH THE PROJECT IN PHASES. THE CONTRACT DOCUMENTS DO NOT DESCRIBE THE SPECIFIC WORK REQUIRED BY THE CONTRACTOR TO PROGRESS THE PROJECT IN PHASES, BUT CONTRACTOR SHALL PREPARE PHASING PLAN AND SUBMIT TO ARCHITECT/ENGINEER AND HENRY COUNTY MAINTENANCE DEPARTMENT PRIOR TO BEGINNING WORK.

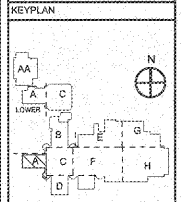

**AH&P CONSULTING ENGINEERS**  
 ANDREWS, HAMBROCK & POWELL, INC.  
 250 Duval Lane  
 Suite 100  
 MACON, GEORGIA 31210  
 MACON (478) 405-8301  
 FAX (478) 405-8210  
 WWW.AHPENGR.COM



**Manley Spangler Smith Architects**  
 A Professional Corporation

525 East Taylor St.  
 P.O. Box 880  
 Griffin, Georgia 30224  
 Office 770.227.5473  
 Fax 770.225.3442

PROJECT:  
 RENOVATIONS,  
 MODIFICATIONS, &  
 ADDITIONS TO HENRY  
 COUNTY SCHOOLS -  
 GROUP 10  
 WOODLAND HIGH SCHOOL  
 (ITEM C)

CLIENT:  
 HENRY COUNTY  
 BOARD OF EDUCATION

SHEET TITLE:  
 ELECTRICAL NEW WORK  
 POWER PLAN - SECTOR  
 "A" UPPER LEVEL

1/11/18  
 P.T.E. - 11897  
 FACILITY CODE: 875-6408  
 © 2018 Manley Spangler Smith Architects, P.C.  
 PROJECT NUMBER: 201751C  
 DATE: 06.07.18  
 SCALE: 1/8"=1'-0"  
 DRAWN BY: JAS  
 CHECKED BY: NRD

SHEET NO.: E201

Order Plans @ [www.dlLine.com](http://www.dlLine.com)