

REVISIONS/ISSUANCES		
NO.	DATE	DESCRIPTION

NOTES: (THIS SHEET ONLY)

- 1. GENERAL: ALL EMERGENCY EGRESS LIGHT FIXTURES, 50V NORMAL POWER SENSING CIRCUIT, AND EXIT SIGNS SHALL BE UNWITCHED.
- 2. GENERAL: CLASSROOM LIGHTS SHALL SWITCH FRONT TWO ROWS OF LIGHTS, CLOSEST TO MARKER BOARD AND INTERACTIVE PROJECTOR. ON ONE SWITCH AND BACK ROW OF LIGHTS ON OTHER FOR CLASSROOM BY MODE LIGHTING. EXISTING LIGHTING FIXTURES ARE AS SHOWN IN CLASSROOMS.
- 3. INTERCEPT EXISTING LIGHTING CIRCUITS IN ABOVE CEILING LIGHTING JUNCTION BOXES TO PROVIDE ROW SWITCHING AS NOTED. UTILIZE 40A, #12, 120°C TO EXTEND AND MAKE CONNECTION TO EXISTING 277V LIGHTING CIRCUIT.
- 4. PROVIDE NEW SWITCHES IN EXISTING RECESSED SWITCH LOCATION. OUT, PATCH AND PAINT WALLS TO INSTALL NEW KEY-LINE SWITCH BOX FOR ADDITIONAL SWITCH IN EXISTING WALLS. UTILIZE EXISTING IN WALL RACEWAY SYSTEM TO ROUTE NEW CONDUCTORS FOR ROW SWITCHING.
- 5. PROVIDE NEW LIGHT SWITCH CONDUCTOR IN EXISTING 1/2" RACEWAY FOR ROW SWITCHING IN THE NEW CONDUCTOR SHALL BE ROLLED INTO THE EXISTING CONDUCTORS TO REMAIN IN PLACE. PROTECT EXISTING CONDUCTORS DURING INSTALLATION.
- 6. PROVIDE LINE VOLTAGE OCCUPANCY SENSOR AS SHOWN. INTERCEPT EXISTING CIRCUIT. 40A, #12, 120°C. MAKE ALL CONNECTIONS.

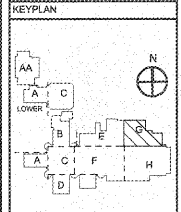

AH&P
ANDREWS, HANCOCK & POWELL, INC.
 250 Charlie Lane
 Suite 100
 MACON, GEORGIA 31210
 MACON (478) 485-8311
 FAX (478) 485-8210
 WWW.AHPENGR.COM



Manley Spangler Smith Architects
 A Professional Corporation

525 East Taylor St.
 P.O. Box 140
 Griffin, Georgia 30224
 Office 770.227.6473
 Fax 770.228.3442

PROJECT: RENOVATIONS, MODIFICATIONS, & ADDITIONS TO HENRY COUNTY SCHOOLS - GROUP 10 WOODLAND HIGH SCHOOL (ITEM C)

CLIENT: HENRY COUNTY BOARD OF EDUCATION

SHEET TITLE: ELECTRICAL NEW WORK LIGHTING PLAN - SECTOR "G"

1.11.18
 P.T.E. - 1.897
 FACILITY CODE: 675-6408
 © 2018 Manley Spangler Smith Architects, PC
 PROJECT NUMBER: 2017101
 DATE: 08.07.18
 SCALE: 1/8"=1'-0"
 DRAWN BY: AJS
 CHECKED BY: NHO
 SHEET NO.: E110

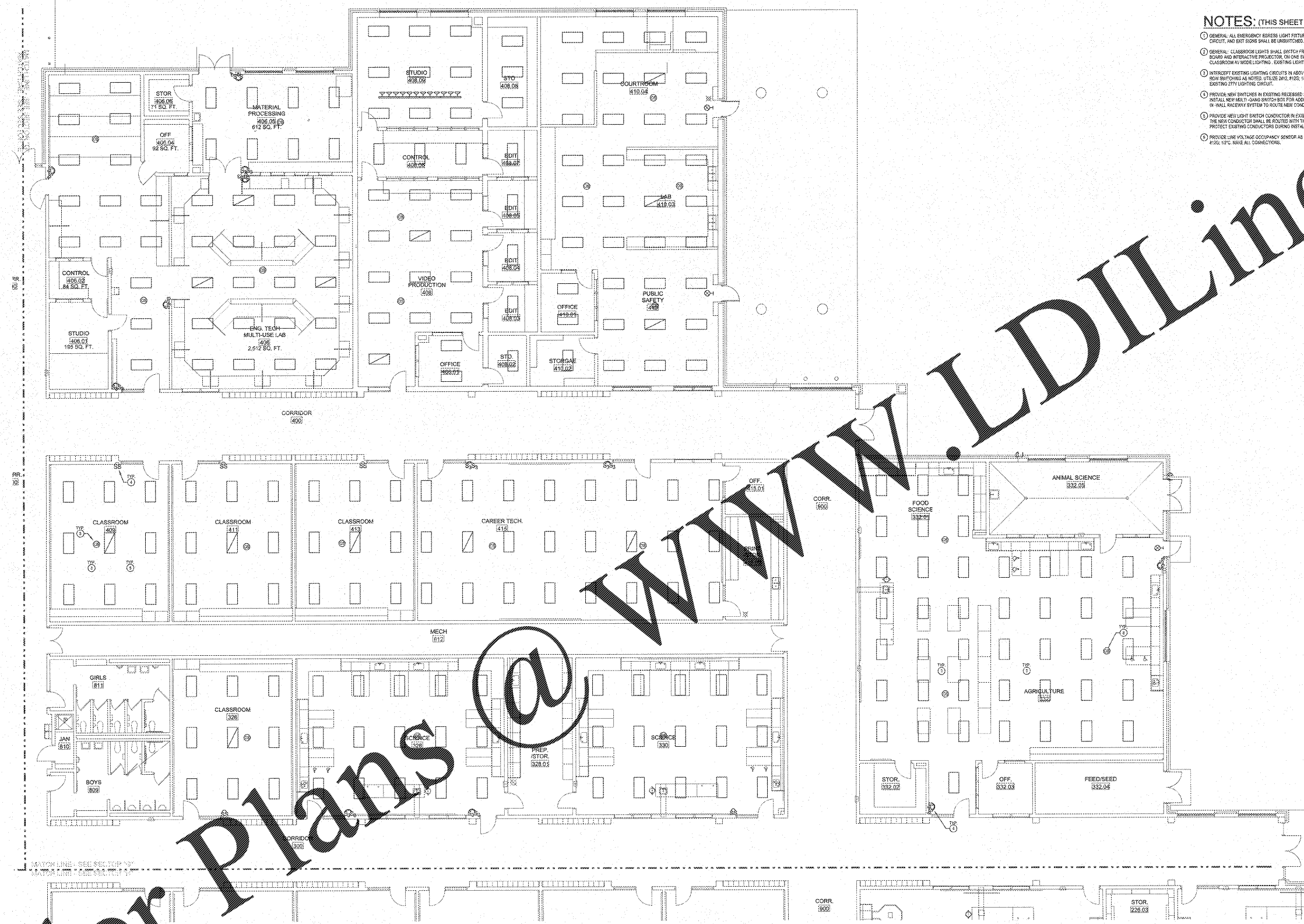

NOTE TO CONTRACTOR CONCERNING PROJECT PHASING:
 THE WORK SPECIFIED ON THE DRAWINGS AND SPECIFICATIONS ILLUSTRATES THE COMPLETED CONTRACTUAL REQUIREMENTS. THIS PROJECT IS PHASED IN MULTIPLE PHASES. THE AREA OF EACH PHASE IS DESCRIBED IN THE ARCHITECTURAL DOCUMENTS AND THE CONTRACTOR SHALL FURNISH THESE PHASING REQUIREMENTS. CONTRACTOR SHALL INCLUDE IN HIS BID ALL COSTS REQUIRED TO ACCOMPLISH THE PROJECT IN PHASES. THE CONTRACT DOCUMENTS DO NOT DESCRIBE THE SPECIFIC WORK REQUIRED BY THE CONTRACTOR TO PERFORM THE PROJECT IN PHASES. THE CONTRACTOR SHALL FURNISH PHASING PLAN AND SUBMIT TO ARCHITECT/ENGINEER AND HENRY COUNTY MAINTENANCE DEPARTMENT PRIOR TO BEGINNING WORK.

GENERAL LIGHTING NOTE
 UNDER THIS PROJECT OCCUPANCY SENSORS SHALL BE INSTALLED. EXISTING 277V LIGHTING CIRCUITS WITHIN BUILDING SHALL BE UTILIZED TO POWER EXISTING LIGHTING. SOME AREAS REQUIRING REVERSE OF LIGHTING CIRCUIT WITHIN SPACES SHALL BE CONNECTED DIRECTLY TO EXISTING SWITCHES. EXISTING CONDUIT AND WIRING MAY BE UTILIZED WHERE IT MEETS THIS SPECIFICATION.

ELECTRICAL NEW WORK LIGHTING PLAN - SECTOR "G"
 SCALE: 1/8"=1'-0"

Order Plans @ WWW.LDILine.com