

REVISIONS/ISSUANCES		
NO.	DATE	DESCRIPTION

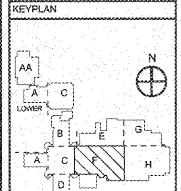

AH&P
ANDREWS, HANCOCK & POWELL, INC.
 CONSULTING ENGINEERS
 250 Charter Lane
 Suite 103
 MARIETTA, GEORGIA 30067
 PHONE (478) 485-4301
 FAX (478) 485-4213
 WWW.AHPENG.COM



Manley Spangler Smith Architects
 A Professional Corporation
 525 East Taylor St.
 P.O. Box 959
 Griffin, Georgia 30224
 Office 770.227.5473
 Fax 770.228.3442

PROJECT: RENOVATIONS, MODIFICATIONS, & ADDITIONS TO HENRY COUNTY SCHOOLS - GROUP 10 WOODLAND HIGH SCHOOL (ITEM C)

CLIENT: HENRY COUNTY BOARD OF EDUCATION

SHEET TITLE: ELECTRICAL NEW WORK LIGHTING PLAN - SECTOR "F"

DATE: 06.07.18
 SCALE: 1/8"=1'-0"
 DRAWN BY: AJS
 CHECKED BY: NHC

SHEET NO.: E109

- NOTES: (THIS SHEET ONLY)**
- GENERAL: ALL EMERGENCY EXIT LIGHT FIXTURES, ELCU NORMAL POWER SENSING CIRCUIT, AND EXIT SIGNS SHALL BE UNSWITCHED.
 - GENERAL: CLASSROOM LIGHTS SHALL SWITCH FRONT TWO ROWS OF LIGHTS. CLOSEST TO MARKER BOARD AND INTERACTIVE PROJECTOR. ON ONE SWITCH AND BACK ROW OF LIGHTS ON OTHER FOR CLASSROOMS WITH MOBILE LIGHTING. EXISTING LIGHTING FIXTURES ARE AS SHOWN IN CLASSROOMS.
 - INTERCEPT EXISTING LIGHTING CIRCUITS IN ABOVE CEILING LIGHTING JUNCTION BOXES TO PROVIDE NEW SWITCHING AS NOTED. UTILIZE 3/16", #10; 1/2" TO EXTEND AND MAKE CONNECTION TO EXISTING JTY LIGHTING CIRCUIT.
 - PROVIDE NEW SWITCHES IN EXISTING RECESSED SWITCH LOCATION. CUT, PATCH AND PAINT WALLS TO INSTALL NEW 1/2" GANG SWITCH BOX FOR ADDITIONAL SWITCH IN EXISTING WALLS. UTILIZE EXISTING IN-WALL RACEWAY SYSTEM TO ROUTE NEW CONDUCTORS FOR NEW SWITCHING.
 - PROVIDE NEW LIGHT SWITCH CONDUCTOR IN EXISTING LYP RACEWAY FOR NEW SWITCHING AS NOTED. THE NEW CONDUCTOR SHALL BE ROUTED WITH THE EXISTING CONDUCTORS TO REMAIN IN PLACE. PROTECT EXISTING CONDUCTORS DURING INSTALLATION.
 - PROVIDE LINE VOLTAGE OCCUPANCY SENSOR AS SHOWN. INTERCEPT EXISTING CIRCUIT UTILIZING #12, #10, VECO. MAKE ALL CONNECTIONS.

GENERAL LIGHTING NOTE

UNDER THIS PROJECT OCCUPANCY SENSORS SHALL BE INSTALLED. EXISTING JTY LIGHTING CIRCUITS WITHIN BUILDING SHALL BE UTILIZED TO POWER EXISTING LIGHTING. SOME AREAS REQUIRING REMOVAL OF LIGHTING CIRCUIT WITHIN SPACES WHILE OTHERS MAY CONNECT CORRECTLY TO EXISTING SWITCHED CIRCUITS. EXISTING CONDUIT AND RACING MAY BE UTILIZED WHERE IT MEETS THE SPECIFICATION.

NOTE: CONTRACTOR CONCERNING PROJECT PHASING:

THE WORK SHOWN ON THESE PLANS AND SPECIFICATIONS ILLUSTRATES THE COMPLETE CONTRACT REQUIREMENTS. THIS PROJECT IS PHASED IN MULTIPLE PHASES. THE AREA OF EACH PHASE IS DESCRIBED IN THE ARCHITECTURAL DOCUMENTS AND THE CONTRACTOR SHALL REVIEW THESE PHASING AND SEQUENCE. CONTRACTOR SHALL INCLUDE IN HIS ALL COSTS NEEDED TO ACCOMPLISH THE CONTRACT IN PHASES. THE CONTRACTOR SHALL NOT INCUR THE SPECIFIC WORK REQUIRED BY THE CONTRACTOR TO PERFORM THE PROJECT IN PHASES, BUT CONTRACTOR SHALL PREPARE PHASING PLAN AND SUBMIT TO ARCHITECT/ENGINEER AND HENRY COUNTY MAINTENANCE DEPARTMENT PRIOR TO BEGINNING WORK.

