

Order Plans @ www.LDILine.com

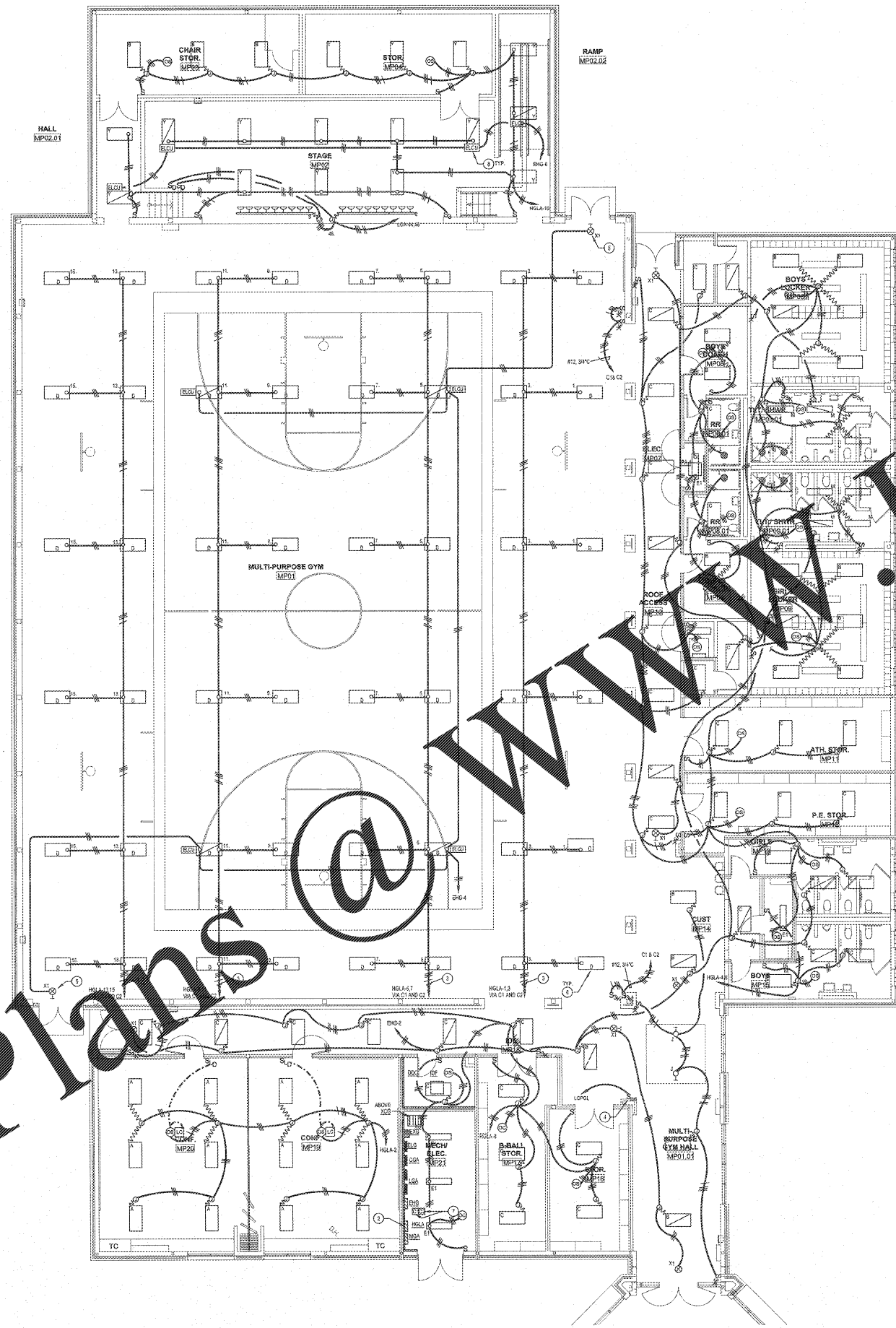

- NOTES: (THIS SHEET ONLY)**
- GENERAL: ALL EMERGENCY EGRESS LIGHT FIXTURES, EMERGENCY LIGHTING CONTROL UNITS (ELCU), AND EXIT SIGNS SHALL BE INDENTED.
 - ROUTE ALL LIGHTING CIRCUITS TO THIS PANEL VIA ASSOCIATED LIGHTING CONTROL PANEL.
 - ROUTE ONE CIRCUIT VIA C1 AND THE OTHER VIA C2.
 - MOUNT PANEL HEAD OVERDRIVE SWITCH SPECIFIED IN THE LIGHTING CONTROLS SECTION AT 48" AFF. AT THIS LOCATION, SWITCH SHALL BE FLUSH MOUNTED. PROVIDE A LABEL TO READ AS FOLLOWS: "LIGHTING CONTROL OVERDRIVE SWITCH".
 - PROVIDE WIRE GUARD FOR THIS FIXTURE.
 - CONNECT FIXTURE TO DRAYOUT BACKIN AT EACH FIXTURE. ALTERNATE CONNECTION FOR LOWER LIGHTING LEVELS SWITCHING SCHEMES. HAVE ALL CONNECTIONS MADE FOR LOWER LIGHTING LEVELS SWITCHING SCHEMES. HAVE ALL CONNECTIONS MADE FOR LOWER LIGHTING LEVELS SWITCHING SCHEMES.
 - PROVIDE MECHANICALLY HELD AND ELECTRICALLY OPERATED SINGLE LIGHTING CONTACTOR WITH TWO WIRE CONTROL RELAY IN NEMA 1 ENCLOSURE.
 - PROVIDE EMERGENCY LIGHTING CONTROL SYSTEM FOR THIS ROOM. THE WATTSTOPPER RELAY SHALL REQUIRE UNWITCHED "STOP" POSITION. LIGHTING CIRCUIT IN ROOMS FOR EMERGENCY LIGHTING SHALL NOT BE AFFECTED BY THIS FIXTURE.

REVISIONS/ISSUANCES		
NO.	DATE	DESCRIPTION

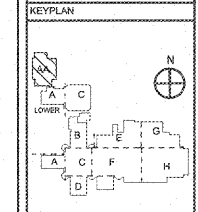

AH&P
CONSULTING ENGINEERS

ANDREWS, HAMMOCK & POWELL, INC.
250 Charter Lane
Suite 101
Macon, Georgia 31210
Macon (478) 405-4301
FAX (478) 405-8219
WWW.AHPENGR.COM



Manley Spangler Smith Architects
A Professional Corporation

525 East Taylor St.
P.O. Box 800
Griffin, Georgia 30224
Office 770.227.5473
Fax 770.228.3442

PROJECT:
RENOVATIONS,
MODIFICATIONS,
&
ADDITIONS TO HENRY
COUNTY SCHOOLS -
GROUP 10
WOODLAND HIGH SCHOOL
(ITEM C)

CLIENT:
HENRY COUNTY
BOARD OF EDUCATION

SHEET TITLE:
ELECTRICAL NEW WORK
LIGHTING PLAN -
SECTOR "AA"

LLJ, BS
P.T.E. 1,687
FACILITY CODE: 075-0408
© 2019 Manley Spangler Smith Architects, PC
PROJECT NUMBER: 201731C
DATE: 06.07.19
SCALE: 1/8"=1'-0"
DRAWN BY: AJS
CHECKED BY: NHC
SHEET NO.: E103

GENERAL NOTES

- LOCATION OF REFERRED CEILING LUMINAIRES SHALL BE AS INDICATED ON ARCHITECTURAL REFLECTED CEILING PLANS. THIS CONTRACTOR SHALL VERIFY ALL FIXTURE QUANTITIES. SHOULD QUANTITY DISCREPANCIES OCCUR, CONTRACTOR SHALL PROVIDE FOR THE GREATER VALUE.
- PROVIDE 4-16V DIMMING CABLES FROM ROOM LIGHT CONTROLLER TO EACH FIXTURE SHOWN IN A SPACE WITH LOW VOLTAGE DIGITAL DIMMER. THE CABLES SHALL BE SUPPORTED BY MDSX SYSTEM.

ELECTRICAL NEW WORK LIGHTING PLAN - SECTOR "AA"
SCALE: 1/8"=1'-0"