

Order Plans @ www.dlLine.com

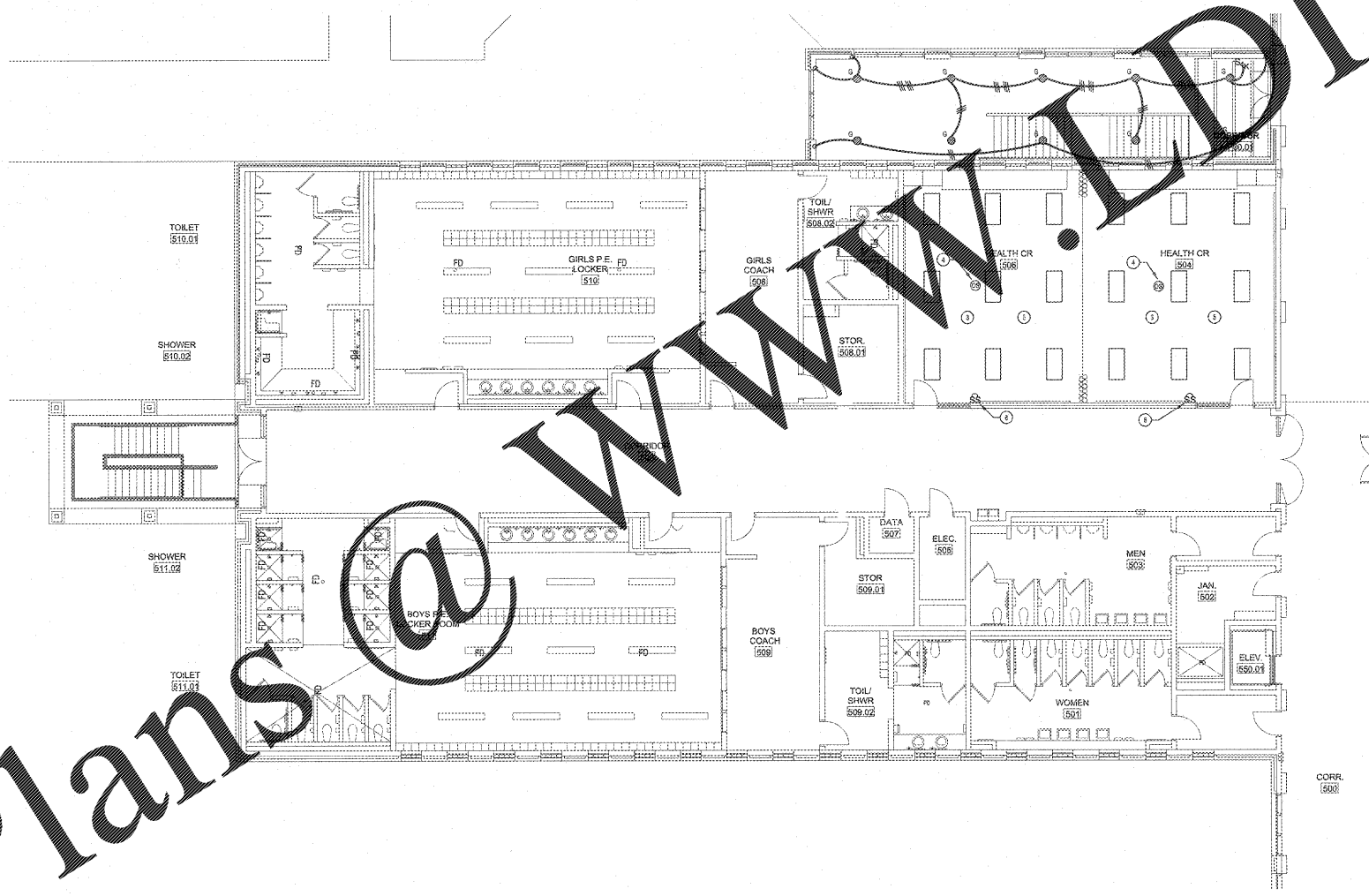

ELECTRICAL NEW WORK LIGHTING PLAN - SECTOR "A" UPPER LEVEL
SCALE: 1/8"=1'-0"

NOTES: (THIS SHEET ONLY)

1. GENERAL: ALL EMERGENCY EGRESS LIGHT FIXTURES, ELCU NORMAL POWER SENSING CIRCUIT, AND EXIT SIGNS SHALL BE UNSWITCHED.
2. GENERAL: CLASSROOM LIGHTS SHALL SWITCH FRONT TWO ROWS OF LIGHTS, CLOSEST TO DASHBOARD AND INTERACTIVE PROJECTOR, ON ONE SWITCH AND BACK ROW OF LIGHTS ON OTHER FOR CLASSROOM AVANCE LIGHTING. EXISTING LIGHTING FIXTURES ARE AS SHOWN IN CLASSROOMS.
3. INTERCEPT EXISTING LIGHTING CIRCUITS IN ABOVE CEILING LIGHTING JUNCTION BOXES TO PROVIDE ROW SWITCHING AS NOTED. UTILIZE 2#14, #10, 1/2" TO EXTEND AND MAKE CONNECTION TO EXISTING 277V LIGHTING CIRCUIT.
4. PROVIDE ONE VOLTAGE OCCUPANCY SENSOR AS SHOWN. INTERCEPT EXISTING CIRCUIT UTILIZING #10, 1/2" TO MAKE ALL CONNECTIONS.
5. PROVIDE NEW LIGHT SWITCH CONDUCTOR IN EXISTING 1/2" RACEWAY FOR ROW SWITCHING AS NOTED. THE NEW CONDUCTOR SHALL BE ROUTED WITH THE EXISTING CONDUCTORS TO REMAIN IN PLACE. PROTECT EXISTING CONDUCTORS DURING INSTALLATION.
6. PROVIDE NEW SWITCHES IN EXISTING RECESSED SWITCH LOCATION. CUT, PATCH AND PAINT WALLS TO MATCH EXISTING. PROVIDE NEW MULTI-GANG SWITCH BOX FOR ADDITIONAL SWITCH IN EXISTING WALLS. UTILIZE EXISTING IN-WALL RACEWAY SYSTEM TO ROUTE NEW CONDUCTORS FOR NEW SWITCHING.

REVISIONS / ISSUANCES		
NO.	DATE	DESCRIPTION

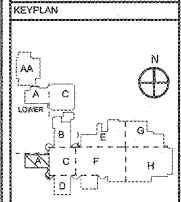

AH&P
CONSULTING ENGINEERS
ANDREWS, HARRICK & POWELL, INC.
255 Charter Lane
Suite 103
MACON, GEORGIA 31210
MACON (478) 405-8301
FAX (478) 405-8210
WWW.AHPENGR.COM



Manley Spangler Smith Architects
A Professional Corporation

525 East Taylor St.
P.O. Box 680
Griffin, Georgia 30224
Office 770.227.5473
Fax 770.228.5442

PROJECT: RENOVATIONS, MODIFICATIONS, & ADDITIONS TO HENRY COUNTY SCHOOLS - GROUP 19 WOODLAND HIGH SCHOOL (ITEM C)

CLIENT: HENRY COUNTY BOARD OF EDUCATION

SHEET TITLE: ELECTRICAL NEW WORK LIGHTING PLAN - SECTOR "A" UPPER LEVEL

1/11/18
P.T.E. - 1,587
FACILITY CODE: 475-6408

© 2018 Manley Spangler Smith Architects, P.C.
PROJECT NUMBER: 201731C
DATE: 06.07.18
SCALE: 1/8"=1'-0"
DRAWN BY: JAS
CHECKED BY: NHO

SHEET NO. E101

NOTE TO CONTRACTOR CONCERNING PROJECT PHASING:
THE WORK SPECIFIED ON THE DRAWINGS AND SPECIFICATIONS ILLUSTRATED THE COMPLETED CONTRACTUAL REQUIREMENTS. THIS PROJECT IS PHASED IN MULTIPLE PHASES. THE AREA OF EACH PHASE IS DESCRIBED IN THE ARCHITECTURAL DOCUMENTS AND THE CONTRACTOR SHALL REVIEW THESE PHASING REQUIREMENTS. CONTRACTOR SHALL INCLUDE IN HIS BID ALL COSTS REQUIRED TO ACCOMPLISH THE CONTRACT PHASES. THE CONTRACT DOCUMENTS DO NOT REQUIRE THE SPECIFIC WORK REQUIRED BY THE CONTRACTOR TO PERFORM THE PROJECT IN PHASES, BUT CONTRACTOR SHALL PREPARE PHASING PLAN AND SUBMIT TO REGISTERED ENGINEER AND HENRY COUNTY MAINTENANCE DEPARTMENT PRIOR TO BEGINNING WORK.

GENERAL LIGHTING NOTE
UNLESS OTHERWISE NOTED, ALL LIGHTING SHALL BE INSTALLED IN ACCORDANCE WITH THE NATIONAL ELECTRICAL CODE (NEC) AND THE NATIONAL FIRE PROTECTION ASSOCIATION (NFPA) 70-2017. EXISTING CONDUIT AND WIRING MAY BE UTILIZED WHERE IT MEETS THIS SPECIFICATION.