

Order Plans @ WWW.LDLine.com

MATCH LINE - SEE SECTOR "AA"
 MATCH LINE - SEE SECTOR "A"

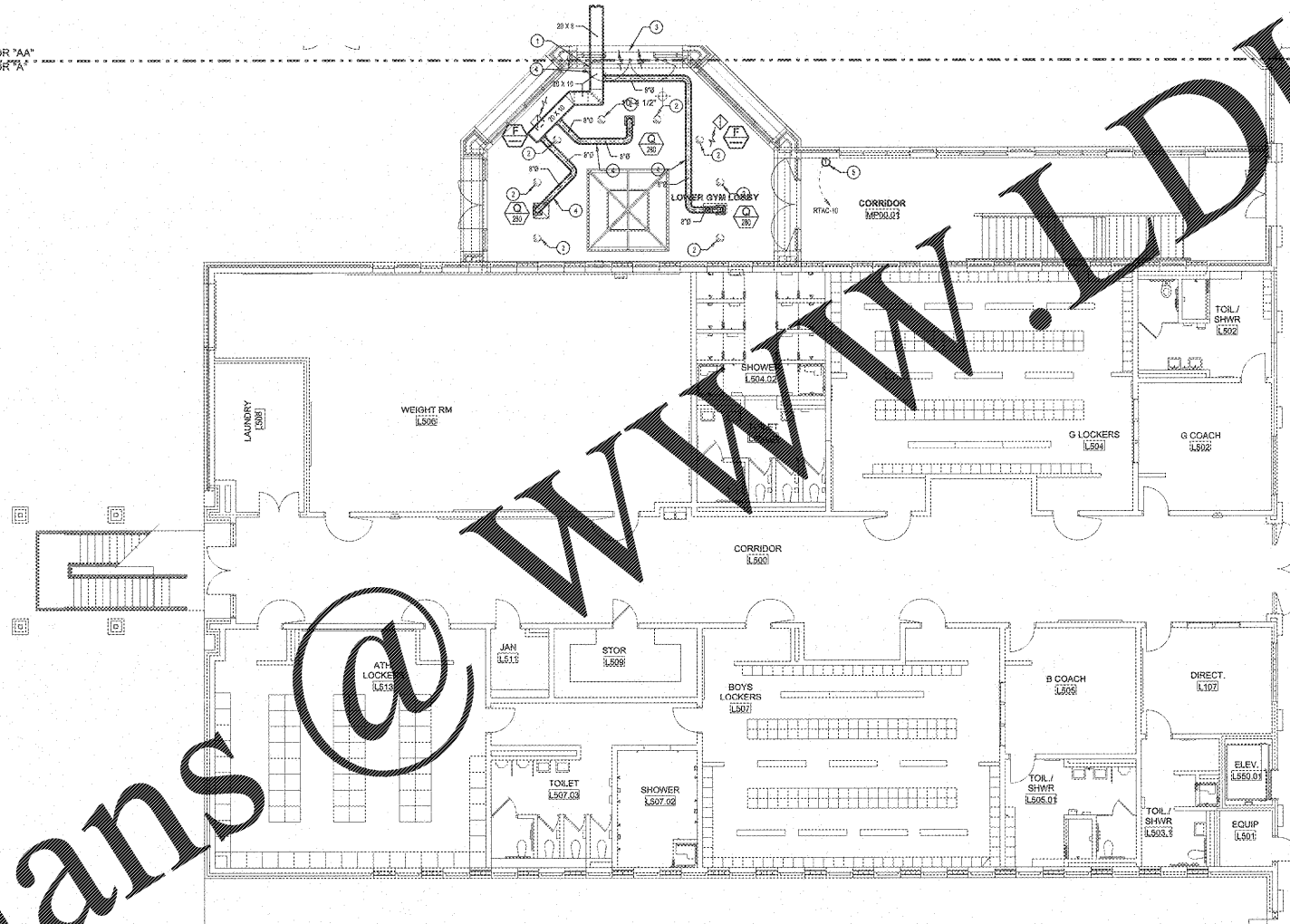

MECHANICAL FLOOR PLAN - SECTOR "A" LOWER LEVEL
 SCALE: 1/8"=1'-0"

- NOTES: (MECHANICAL FLOOR PLAN ONLY)
- 20 x 4 DUCT TRANSITIONS TO 20 x 10 AFTER PASSING OVER PRECAST BEAM AND ENTERING SPACE ABOVE LOWER GYM LOBBY CEILING.
 - RECESSED LIGHT FIXTURES. SEE ELECTRICAL FOR EXACT LOCATION.
 - RETURN AIR PASSES THRU CEILING TRANSFER GRILLES AND ABOVE CLEAR OPENING ABOVE PRECAST CONCRETE BEAM.
 - CONTRACTOR IS WARNED THAT SPACE ABOVE LOBBY CEILING IS SEVERELY LIMITED, AND ONLY APPROXIMATELY 1" CLEAR EXISTS. FIELD VERIFY EXACT CLEAR DIMENSION AND OFFSET DUCT AS REQUIRED TO MISS LIGHT FIXTURES AND OTHER ITEMS. CONTRACTOR SHALL COORDINATE WITH SPRINKLER CONTRACTOR AND ELECTRICAL CONTRACTOR TO ENSURE CONDUIT AND SPRINKLER PIPE ARE NOT INSTALLED AT AN ELEVATION THAT BLOCKS THE DUCT FROM BACKWARDS OR BEING INSTALLED ABOVE THE CEILING OF THE LOBBY.
 - MOUNT TEMPERATURE SENSOR AT 7'-0" A.F.F.

REVISIONS / ISSUANCES		
NO.	DATE	DESCRIPTION

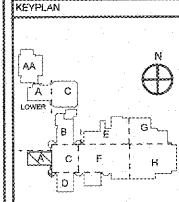

AH&P
 CONSULTING ENGINEERS
 ANDREWS, HAMMOCK & PINNELL, INC.
 Suite 100
 MACON, GEORGIA 31210
 MACON (478) 405-8321
 FAX (478) 405-8210
 WWW.AHPENGR.COM



Manley Spangler Smith Architects
 A Professional Corporation

525 East Taylor St.
 P.O. Box 880
 Griffin, Georgia 30224
 Office 770.227.8473
 Fax 770.228.3442

PROJECT:
 RENOVATIONS,
 MODIFICATIONS, &
 ADDITIONS TO HENRY
 COUNTY SCHOOLS -
 GROUP 10
 WOODLAND HIGH SCHOOL
 (ITEM C)

CLIENT:
 HENRY COUNTY
 BOARD OF EDUCATION

SHEET TITLE:
 MECHANICAL FLOOR
 PLAN - SECTOR "A"
 LOWER LEVEL

I.U. : 88
 P.T.E. : 1,387
 FACILITY CODE: 878-0408
 © 2018 Manley Spangler Smith Architects, PC
 PROJECT NUMBER: 201751C
 DATE: 08.07.18
 SCALE: 1/8"=1'-0"
 DRAWN BY: WSS
 CHECKED BY: JCR

SHEET NO.: M102