

Order Plans

@

WWW.LDILine.com

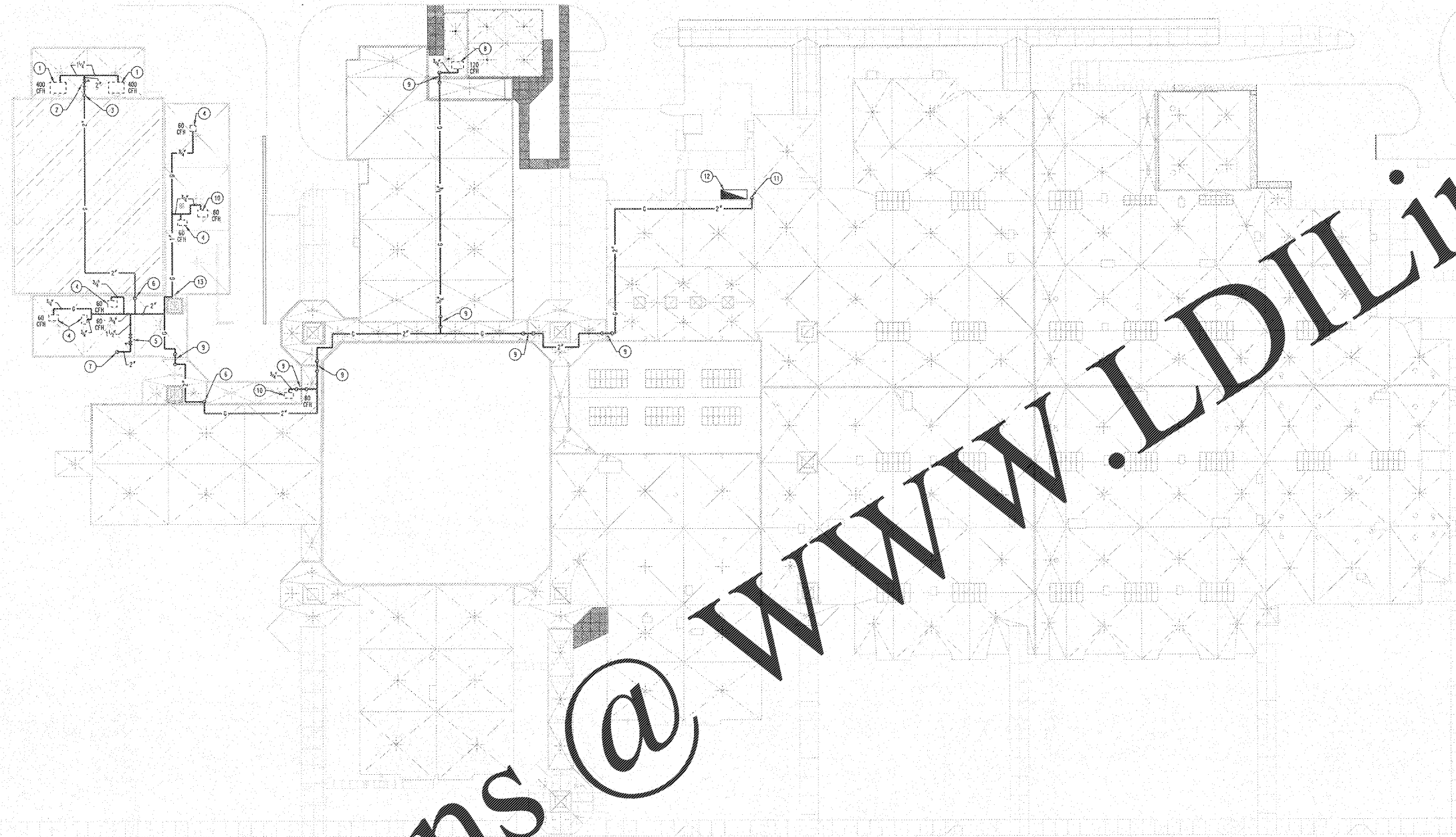

PLUMBING ROOF PLAN - GAS PIPING
SCALE: 1" = 30'-0"

GENERAL NOTE:
ALL NEW GAS PIPING ON ROOF SHALL BE SUPPORTED USING SUPPORTS AS DETAILED ON SHEET P401 AND AS SPECIFIED. ALSO, ALL NEW GAS PIPING ON ROOF SHALL BE CLEANED, PRIMED AND PAINTED IN ACCORDANCE WITH DIVISION 9.

GAS LOAD BREAKDOWN CHART

LOAD TYPE	CFH
SPACE HEATING	15,380 CFH
WATER HEATING	2,390 CFH
EMERGENCY GENERATOR	360 CFH
COOKING EQUIPMENT	1,190 CFH
SCIENCE LAB EQUIPMENT	180 CFH
CLOTHES DRYER	280 CFH
GREENHOUSE	160 CFH
TOTAL LOAD	20,780 CFH

NOTES: (THIS SHEET ONLY)

- 1 CONNECT 1/2" GAS PIPING TO RTAC UNIT AT THIS APPROXIMATE LOCATION ON ROOF. SEE MECHANICAL DRAWINGS FOR EXACT LOCATION OF UNIT AND APPROVED EQUIPMENT SUBMITTALS FOR EXACT LOCATION OF GAS CONNECTION. CONTRACTOR SHALL PROVIDE A REGULATOR CAPABLE OF REGULATING 800 CFH OF NATURAL GAS FROM 2 PSI TO 1" W.C. PRESSURE.
- 2 CONTRACTOR SHALL PROVIDE A REGULATOR CAPABLE OF REGULATING 800 CFH OF NATURAL GAS FROM 2 PSI TO 1" W.C. PRESSURE.
- 3 OFFSET GAS PIPING AS REQUIRED TO GO FROM HIGH ROOF AREA DOWN TO LOW ROOF AREA. COORDINATE PIPE DROP WITH GUTTER ON THIS END OF THE BUILDING. ROUTE PIPING DOWN TO LOW ROOF ADJACENT TO DOWNSPUT ON THIS APPROXIMATE LOCATION. SEE ARCHITECTURAL DRAWINGS FOR EXACT LOCATION OF DOWNSPUT.
- 4 CONNECT 1/2" GAS PIPING TO RTAC UNIT AT THIS APPROXIMATE LOCATION ON ROOF. SEE MECHANICAL DRAWINGS FOR EXACT LOCATION OF UNIT AND APPROVED EQUIPMENT SUBMITTALS FOR EXACT LOCATION OF GAS CONNECTION. CONTRACTOR SHALL PROVIDE A REGULATOR CAPABLE OF REGULATING 800 CFH OF NATURAL GAS FROM 2 PSI TO 1" W.C. SEE TYPICAL GAS CONNECTION TO RTAC UNIT DETAIL ON SHEET P401.
- 5 CONTRACTOR SHALL PROVIDE A REGULATOR CAPABLE OF REGULATING 400 CFH OF NATURAL GAS FROM 2 PSI TO 1" W.C. PRESSURE.
- 6 OFFSET GAS PIPING AS REQUIRED TO GO FROM HIGH ROOF DOWN TO LOW ROOF. DROP PIPING ALONG MILLION IN WINDOWS WHERE WINDOWS ARE PRESENT.
- 7 2" GAS PIPING DOWN THRU PIPE BOX ASSEMBLY INTO BUILDING. SEE SHEET P101 FOR PIPING CONTINUATION. SEE PIPE BOX ASSEMBLY DETAIL ON SHEET P401.
- 8 CONNECT 1/2" GAS PIPING TO RTAC UNIT AT THIS APPROXIMATE LOCATION ON ROOF. SEE MECHANICAL DRAWINGS FOR EXACT LOCATION OF UNIT AND APPROVED EQUIPMENT SUBMITTALS FOR EXACT LOCATION OF GAS CONNECTION. CONTRACTOR SHALL PROVIDE A REGULATOR CAPABLE OF REGULATING 120 CFH OF NATURAL GAS FROM 2 PSI TO 1" W.C. SEE TYPICAL GAS CONNECTION TO RTAC UNIT DETAIL ON SHEET P401.
- 9 OFFSET GAS PIPING AS REQUIRED TO CROSS ROOF EXPANSION JOINT.
- 10 CONNECT 1/2" GAS PIPING TO RTAC UNIT AT THIS APPROXIMATE LOCATION ON ROOF. SEE MECHANICAL DRAWINGS FOR EXACT LOCATION OF UNIT AND APPROVED EQUIPMENT SUBMITTALS FOR EXACT LOCATION OF GAS CONNECTION. CONTRACTOR SHALL PROVIDE A REGULATOR CAPABLE OF REGULATING 80 CFH OF NATURAL GAS FROM 2 PSI TO 1" W.C. PRESSURE.
- 11 ROUTE 2" GAS PIPING EXPOSED DOWN BUILDING WALL TO EXISTING GAS METER SET. CONNECT PIPING TO THE 7 PSI SECTION OF GAS PIPING ON THE BUILDING SIDE OF THE METER. PROVIDE A VALVE AS SPECIFIED AT THIS CONNECTION.
- 12 EXISTING 2 PSI GAS METER SET LOCATION. CONTRACTOR SHALL CONTACT LOCAL UTILITY AND MAKE ARRANGEMENTS FOR AN ADDITIONAL LOAD OF 1,200 CFH AT 2 PSI. THE ADDITIONAL LOAD BREAKS DOWN AS FOLLOWS: SPACE HEATING = 1,380 CFH; WATER HEATING 400 CFH. CONTRACTOR SHALL PAY ALL COSTS.
- 13 CONTRACTOR SHALL ROUTE GAS PIPING BETWEEN HIGH WALL OF GYM AND SKYLIGHT.

REVISIONS/ISSUANCES		
NO.	DATE	DESCRIPTION

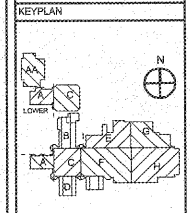

AH&P
CONSULTING ENGINEERS
ANDREWS, HAMMOCK & POWELL, INC.
256 Charter Lane
Suite 100
MACON, GEORGIA 31210
MACON (478) 405-8301
FAX (478) 405-8210
WWW.AHPENR.COM



Manley Spangler Smith Architects
A Professional Corporation

655 East Taylor St.
P.O. Box 880
Gresham, Georgia 30224
Office 770.227.5473
Fax 770.225.3442

PROJECT:
RENOVATIONS, MODIFICATIONS, & ADDITIONS TO HENRY COUNTY SCHOOLS - GROUP 10 WOODLAND HIGH SCHOOL (ITEM C)

CLIENT:
HENRY COUNTY BOARD OF EDUCATION

SHEET TITLE:
PLUMBING ROOF PLAN - GAS PIPING

LU: 88
FY: 1,887
FACILITY CODE: 675-0408
© 2018 Manley Spangler Smith Architects, PC
PROJECT NUMBER: 201731C
DATE: 06.07.18
SCALE: AS SHOWN
DRAWN BY: JAC
CHECKED BY: JAC

SHEET NO.: **P201**