

NOTES: (THIS SHEET ONLY)

- 1 4" STORM DRAIN PIPING DOWN IN CHASE TO BELOW FLOOR.
- 2 SEE CIVIL DRAWINGS FOR PIPING CONTINUATION.
- 3 CONTRACTOR SHALL REMOVE EXISTING CLEARDOUT AND INSTALL NEW 4" FLOOR CLEARDOUT AS SPECIFIED TO BE FLOOR WITH FINISHED FLOOR.

| REVISIONS/ISSUANCES |      |             |
|---------------------|------|-------------|
| NO.                 | DATE | DESCRIPTION |
|                     |      |             |
|                     |      |             |
|                     |      |             |

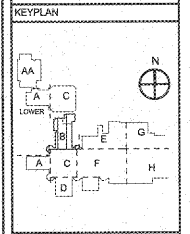

**AH&P**  
CONSULTING ENGINEERS  
ANDREWS, HAMMOCK & POWELL, INC.  
250 Charter Lane  
Suite 100  
Macon, Georgia 31210  
Macon (478) 405-8301  
FAX (478) 405-8210  
WWW.AHPENR.COM



**Manley Spangler Smith Architects**  
A Professional Corporation

535 East Taylor St.  
P.O. Box 880  
Griffin, Georgia 30224  
Office 770.227.5473  
Fax 770.228.3422

PROJECT:  
RENOVATIONS, MODIFICATIONS, & ADDITIONS TO HENRY COUNTY SCHOOLS - GROUP 10 WOODLAND HIGH SCHOOL (ITEM C)

CLIENT:  
HENRY COUNTY BOARD OF EDUCATION

SHEET TITLE:  
PLUMBING FLOOR PLAN - SECTOR "B"

1.11.18  
P.T.E. 1,187  
FACILITY CODE: 675-0408  
© 2018 Manley Spangler Smith Architects, PC  
PROJECT NUMBER: 2017SIC  
DATE: 08.07.18  
SCALE: 1/8"=1'-0"  
DRAWN BY: JMC  
CHECKED BY: JMC

SHEET NO.: P104

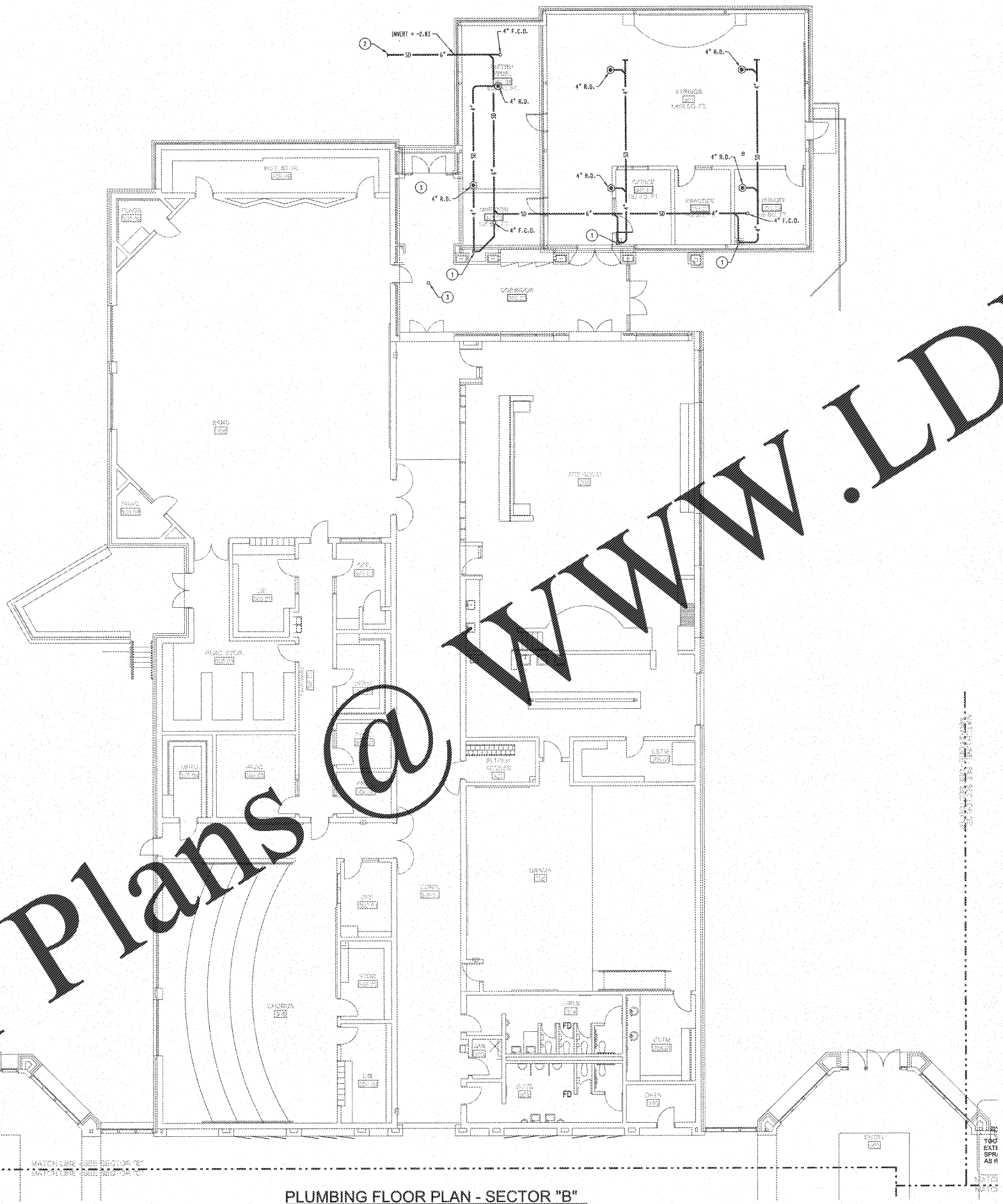

PLUMBING FLOOR PLAN - SECTOR "B"  
SCALE: 1/8"=1'-0"

Order Plans @

WWW.LDILine.com