

Order Plans @

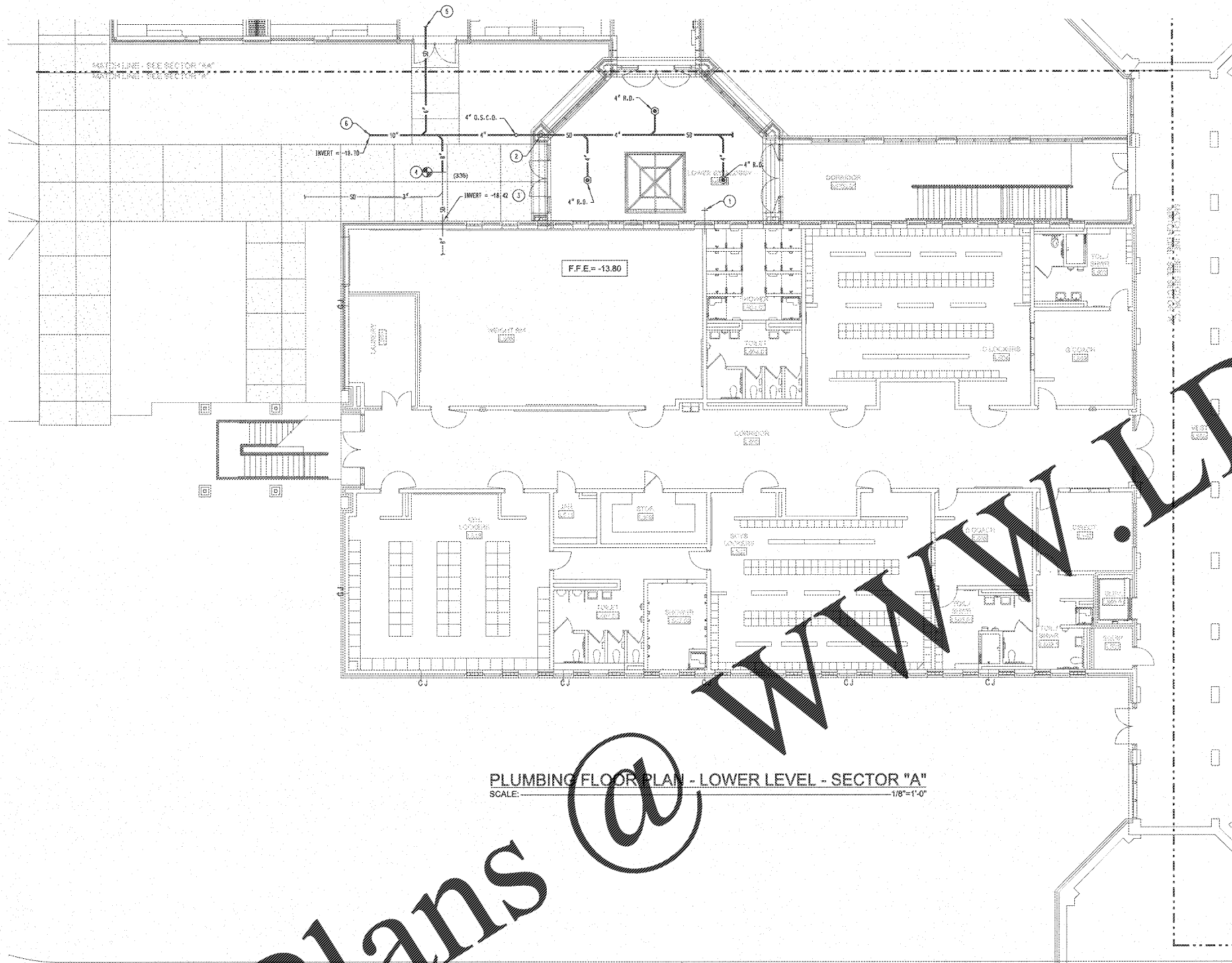

NOTES: (THIS SHEET ONLY)

- EXISTING WALL HYDRANT TO BE REMOVED. CAP PIPING INSIDE WALL. PATCH WALL TO MATCH EXISTING.
- 4\"/>

PLUMBING FLOOR PLAN - LOWER LEVEL - SECTOR "A"  
SCALE: 1/8"=1'-0"

REVISIONS/ISSUANCES	
NO.	DESCRIPTION

**AH&P**  
CONSULTING  
ENGINEERS  
ANDREWS, HANCOCK & POWELL, INC.  
250 Charter Lane  
Suite 102  
MACON, GEORGIA 31210  
MACON (478) 405-8201  
FAX (478) 405-9210  
WWW.AHPENR.COM



**Manley  
Spangler  
Smith  
Architects**  
A Professional Corporation

625 East Taylor St.  
P.O. Box 890  
Griffin, Georgia 30224  
Office 770.227.5473  
Fax 770.226.3442

PROJECT:  
RENOVATIONS,  
MODIFICATIONS, &  
ADDITIONS TO HENRY  
COUNTY SCHOOLS -  
GROUP 10  
WOODLAND HIGH SCHOOL  
(ITEM C)

CLIENT:  
HENRY COUNTY  
BOARD OF EDUCATION

SHEET TITLE:  
PLUMBING FLOOR  
PLAN - LOWER LEVEL -  
SECTOR "A"

1/1: 88  
P.E.: 1,887  
FACILITY CODE: 675-0408  
© 2018 Manley Spangler Smith Architects, PC  
PROJECT NUMBER: 201731C  
DATE: 06.07.18  
SCALE: 1/8"=1'-0"  
DRAWN BY: JAC  
CHECKED BY: JAC  
SHEET NO.: P102