

Order Plans @ WWW.LDILINE.COM

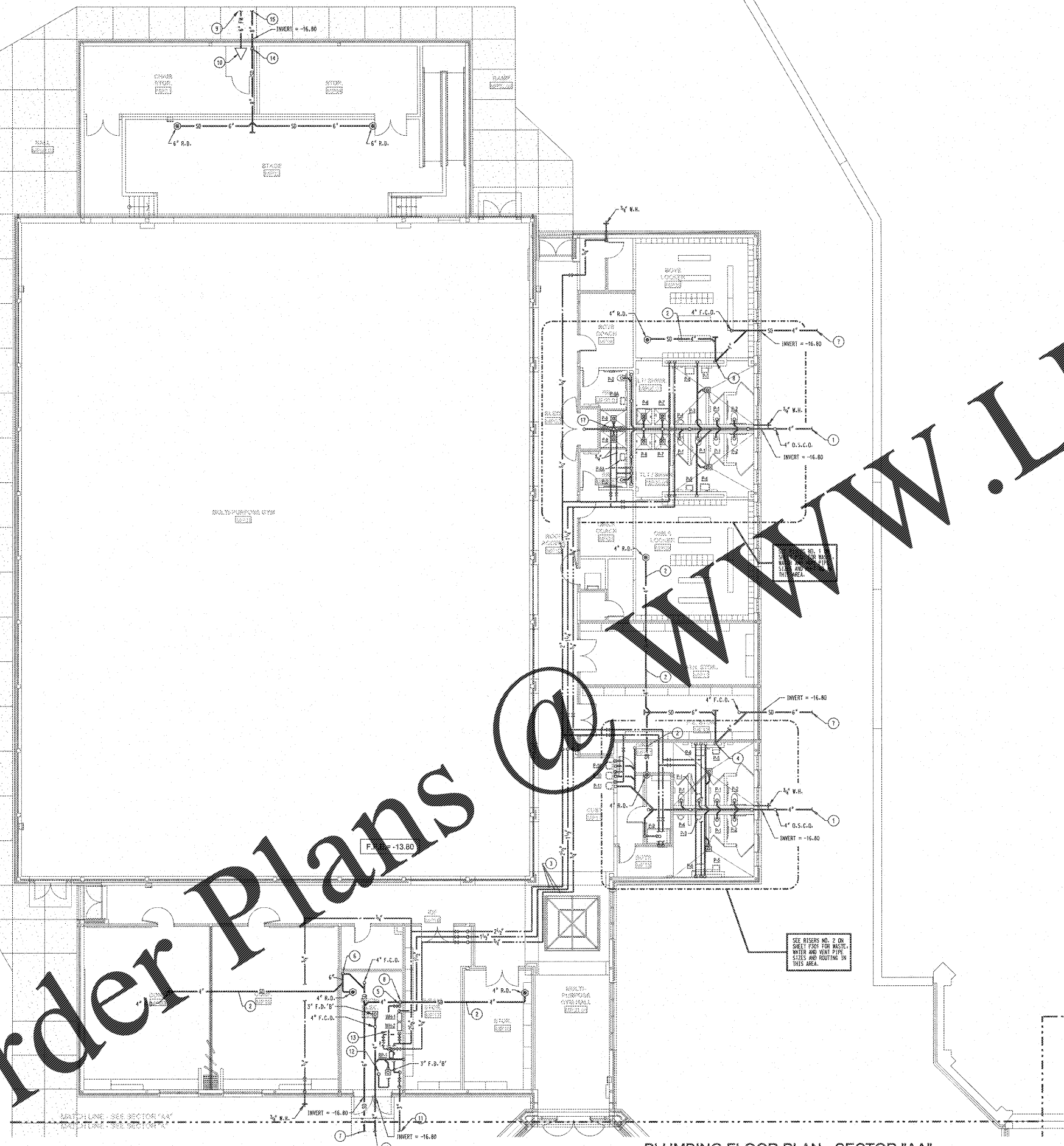

NOTES: (THIS SHEET ONLY)

- 1 4" WASTE PIPING FROM BUILDING. SEE CIVIL DRAWINGS FOR PIPING CONTINUATION.
- 2 ROUTE STORM DRAIN PIPING AS HIGH AS POSSIBLE ABOVE CEILING.
- 3 OFFSET PIPING AS REQUIRED TO GO AROUND CEILING POP-UP. SEE CEILING PLANS.
- 4 6" STORM DRAIN PIPING DOWN IN CHASE TO BELOW FLOOR.
- 5 2" GAS PIPING DOWN TO WATER HEATERS. SEE TYPICAL GAS OUTLET DETAIL ON SHEET PA01.
- 6 6" STORM DRAIN PIPING DOWN EXPOSED ON WALL TO BELOW FLOOR.
- 7 6" STORM DRAIN PIPING FROM BUILDING. SEE CIVIL DRAWINGS FOR PIPING CONTINUATION.
- 8 4" STORM DRAIN PIPING DOWN IN CHASE TO BELOW FLOOR.
- 9 4" FIRE MAIN PIPING TO BUILDING. SEE CIVIL DRAWINGS FOR PIPING CONTINUATION.
- 10 FIRE PROTECTION ENTRANCE RISER LOCATION. SEE SHEET FP101 AND SPECIFICATIONS.
- 11 3" DOMESTIC WATER PIPING TO BUILDING. SEE DOMESTIC WATER ENTRANCE DETAIL ON SHEET PA01. SEE CIVIL DRAWINGS FOR PIPING CONTINUATION.
- 12 2" GAS PIPING UP THRU PIPE BOX ONTO ROOF. SEE PIPE BOX ASSEMBLY DETAIL ON SHEET PA01.
- 13 SEE WATER HEATER PIPING SCHEMATIC ON SHEET WH1 FOR PIPE ROUTING AND TYPICAL DETAILS AND RISER LOCATIONS.
- 14 8" STORM DRAIN PIPING FROM CORNER IN CHASE TO BELOW FLOOR.
- 15 4" STORM DRAIN PIPING FROM BUILDING. SEE CIVIL DRAWINGS FOR PIPING CONTINUATION.
- 16 4" WASTE PIPING FROM BUILDING. SEE SHEET P101 FOR PIPING CONTINUATION.
- 17 1/2" HDI AND 1/2" W.H. PIPING DOWN IN WALL TO SUBMERGED TRAP. PROVIDE A PRECISION PAPER TAP TO CONNECT PIPING TO SUBMERGED TRAP.

REVISIONS/ISSUANCES		
NO.	DATE	DESCRIPTION

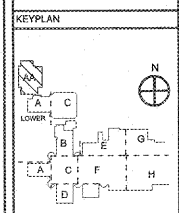

AH&P
CONSULTING ENGINEERS
ANDREWS, HAMMOCK & POWELL, INC.
250 Charter Lane
Suite 100
Macon, Georgia 31210
Macon (478) 405-8301
FAX (478) 405-8210
WWW.AHPENR.COM



Manley Spangler Smith Architects
A Professional Corporation

525 East Taylor St.
P.O. Box 889
Griffin, Georgia 30224
Office 770.227.5473
Fax 770.228.3442

PROJECT: RENOVATIONS, MODIFICATIONS, & ADDITIONS TO HENRY COUNTY SCHOOLS - GROUP 10 WOODLAND HIGH SCHOOL (ITEM C)

CLIENT: HENRY COUNTY BOARD OF EDUCATION

SHEET TITLE: PLUMBING FLOOR PLAN - SECTOR "AA"

1/1 : 08
P.T.E. : 1.057
FACILITY CODE: 475-0408
© 2018 Manley Spangler Smith Architects, PC
PROJECT NUMBER: 201731C
DATE: 08.07.18
SCALE: 1/8"=1'-0"
DRAWN BY: JMC
CHECKED BY: JMC

PLUMBING FLOOR PLAN - SECTOR "AA"
SCALE: 1/8"=1'-0"