

| REVISIONS/ISSUANCES |      |             |
|---------------------|------|-------------|
| No.                 | DATE | DESCRIPTION |
|                     |      |             |
|                     |      |             |
|                     |      |             |

**FOUNDATION NOTES:**

1. [X-X'] INDICATES TOP OF FOOTING BELOW FINISH FLOOR ELEVATION 807.85'. TOP OF ALL EXTERIOR FOOTINGS TO BE 1'-4" BELOW FIN. FLR. TYPICAL U.N.O. TOP OF ALL INTERIOR FOOTINGS TO BE 0'-8" BELOW FIN. FLR. TYPICAL U.N.O.
2. [Symbol] INDICATES STEP IN FOOTING - SEE TYPICAL STEPPED FOOTING DETAIL ON S4.2.
3. THICKNESS OF SLAB ON GRADE TO BE 4" MINIMUM, U.N.O. AND TO CONTAIN (1) LAYER OF 6x6-W1.4xW1.4 WWF 1" FROM TOP OF SLAB. SLAB TO BEAR ON 4" GRADED AGGREGATE BASE.
4. REF. FINISH FLOOR ELEV. = 0'-0" U.N.O. (807.85)
5. ALL SLOPES TO DRAINS SHALL BE ACCOMMODATED BY SLOPING BOTTOM AND TOP OF SLAB AT THE SAME RATE.
6. REFER TO ARCHITECTURAL DRAWINGS FOR TRENCH DRAINS.
7. [Symbol] INDICATES INTERIOR SHEARWALL. ALL EXTERIOR MASONRY WALLS ARE CONSIDERED SHEAR WALLS AND REINFORCED WITH #5'S @ 48" O.C. TYPICAL UNLESS A LESSER SPACING IS INDICATED. ALL CONTINUOUS FOOTING UNDER SHEARWALLS TO CONTAIN (2) #5 CONT. TOP [Symbol] (TYP., U.N.O.)
8. ALL INTERIOR, NON LOAD BEARING WALLS SHALL HAVE A THICKENED SLAB W/ DOWEL INTO SLAB, U.N.O. SEE 12/S4.3 FOR MORE INFORMATION.
9. PROVIDE CONTROL/CONSTRUCTION JOINTS IN SLAB PER S4.2 FOR TYPICAL DETAILS.
10. REFER TO ARCHITECTURAL DRAWINGS FOR JOINT DIMENSIONS, DETAILS AND INFORMATION NOTED ON THIS DRAWING.
11. ALL CMU WALLS SHALL BE REINFORCED WITH #4'S CENTERED IN GROUT FILLED CELL AT 48" O.C. MAX. #4 BARS TO BE PLACED TO THICKENED SLAB U.N.O. ALL MASONRY WALLS SHALL HAVE #4'S TO ADD TO HORIZONTAL REINFORCING (MIN. NO. 6 BARS) @ 16" O.C. TYP.
12. CONTRACTOR SHALL COORDINATE AND CONSTRUCT OPENINGS IN SHEARWALLS FOR MECHANICAL ITEMS, INCLUDING DUCTS AND PIPING, THAT PENETRATE THOSE SHEARWALLS. OPENINGS FOR MECHANICAL PENETRATIONS SHALL BE CONSTRUCTED PER TYPICAL DETAILS ON THESE DRAWINGS. ALL SHALL BE CONSTRUCTED DURING ERECTION OF THESE WALLS. CONTRACTOR SHALL NOT PROVIDE A SHEARWALL OPENING THAT HAS NOT BEEN DETAILED AND REINFORCED PER THE TYPICAL DETAILS ON THIS DRAWING.
13. THE CONTRACTOR SHALL REFER TO THE PLUMBING, MECHANICAL AND ELECTRICAL DRAWINGS AND NOTES FOR THE LOCATION OF ALL UNDERGROUND OR UNDERFLOOR PIPING AND EQUIPMENT. CONTRACTOR SHALL COORDINATE THE INSTALLATION OF ALL STRUCTURAL FOUNDATIONS WITH THE INSTALLATION OF ALL UNDERGROUND OR UNDERFLOOR PLUMBING, MECHANICAL, AND ELECTRICAL PIPING. THE CONTRACTOR SHALL REFER TO TYPICAL FOUNDATION INFLUENCE DETAIL ON DRAWING S4.2.
- [Symbol] INDICATES RECESSED SLAB. ALL SLOPES TO DRAINS TO BE ACCOMMODATED BY SLOPING BOTTOM AND TOP OF SLAB AT THE SAME RATE.

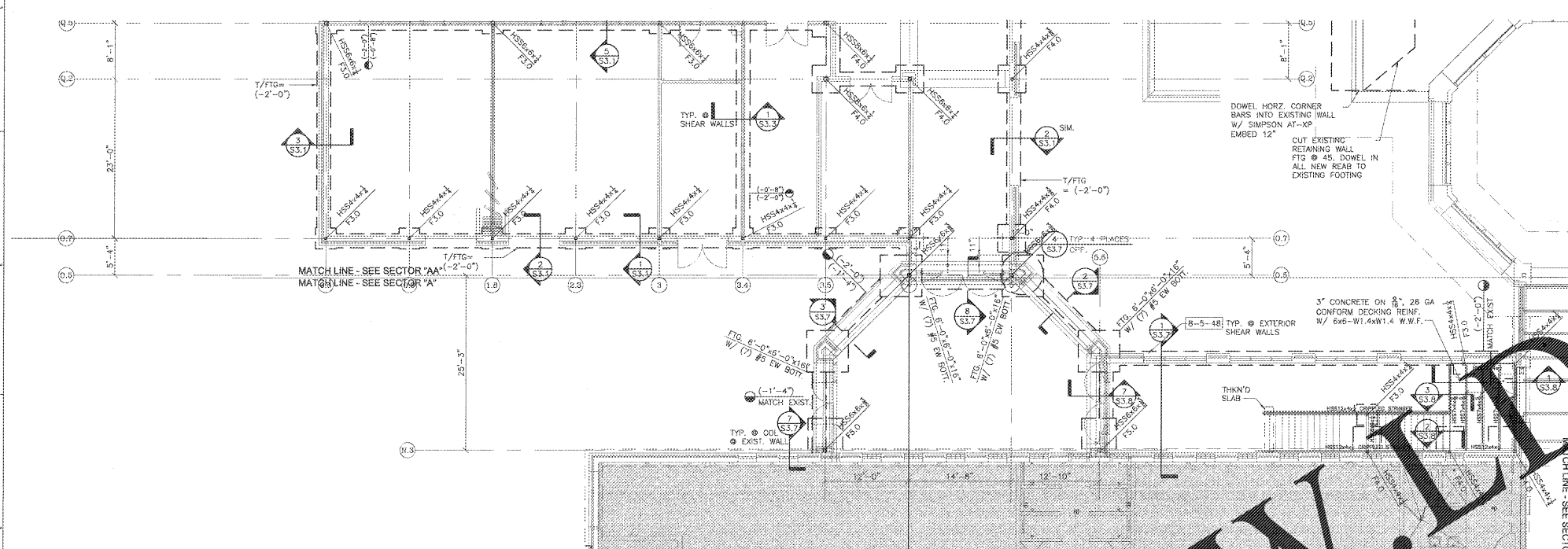

**1 FOUNDATION PLAN - SECTOR "A"**  
 S1.2 SCALE: 1/8" = 1'-0"

| COLUMN FOOTING SCHEDULE |                       |                         |
|-------------------------|-----------------------|-------------------------|
| DESIGNATION             | SIZE                  | REINFORCING             |
| F3                      | 3'-0"x3'-0"x16" THICK | 4- #5 BARS EA. WAY BOT. |
| F3.5                    | 3'-6"x3'-6"x16" THICK | 5- #5 BARS EA. WAY BOT. |
| F4                      | 4'-0"x4'-0"x16" THICK | 5- #5 BARS EA. WAY BOT. |
| F4.5                    | 4'-6"x4'-6"x16" THICK | 6- #5 BARS EA. WAY BOT. |
| F5                      | 5'-0"x5'-0"x12" THICK | 5- #5 BARS EA. WAY BOT. |
| F7                      | 7'-0"x7'-0"x16" THICK | 6- #6 BARS EA. WAY BOT. |

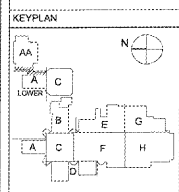

**HAINES, GIPSON & ASSOCIATES**  
 Consulting Engineers  
 805 NORTH BROWN ROAD  
 LANDSDEVILLE, GEORGIA 30024  
 770.435.2000 FAX 770.435.2770



**Manley Spangler Smith Architects**  
 A Professional Corporation

525 East Taylor St.  
 P.O. Box 880  
 Griffin, Georgia 30224  
 Office 770.227.5473  
 Fax 770.228.3442

PROJECT:  
 RENOVATIONS, MODIFICATIONS, & ADDITIONS TO HENRY COUNTY SCHOOLS- GROUP 10 WOODLAND HIGH SCHOOL (ITEM C)  
 CLIENT:  
 HENRY COUNTY BOARD OF EDUCATION

SHEET TITLE:  
**FOUNDATION PLAN - SECTOR A**

© 2018 Manley Spangler Smith Architects, PC  
 PROJECT NUMBER: 201731C  
 DATE: 08.07.18  
 SCALE: AS NOTED  
 DRAWN BY: GAO  
 CHECKED BY: RWG

SHEET NO.: **S1.2**

Order Plans @ [www.edline.com](http://www.edline.com)