

Manley Spangler Smith Architects
A Professional Corporation

525 East Taylor St.
P.O. Box 890
Cuthbert, Georgia 30224
Office: 770.227.6473
Fax: 770.228.3442

PROJECT:
RENOVATIONS,
MODIFICATIONS, &
ADDITIONS TO HENRY
COUNTY SCHOOLS -
GROUP 10
WOODLAND HIGH SCHOOL
(ITEM C)
CLIENT:
HENRY COUNTY BOARD
OF EDUCATION

SHEET TITLE:
PARTIAL FLOOR PATTERN
PLAN & DETAILS

11.1: 67
P.T.E.: 1487
FACILITY CODE: 575-0458
DATE: 06.07.16
SCALE: AS NOTED

DRAWN BY: JS
CHECKED BY: RV
SHEET NO.:
A8.11

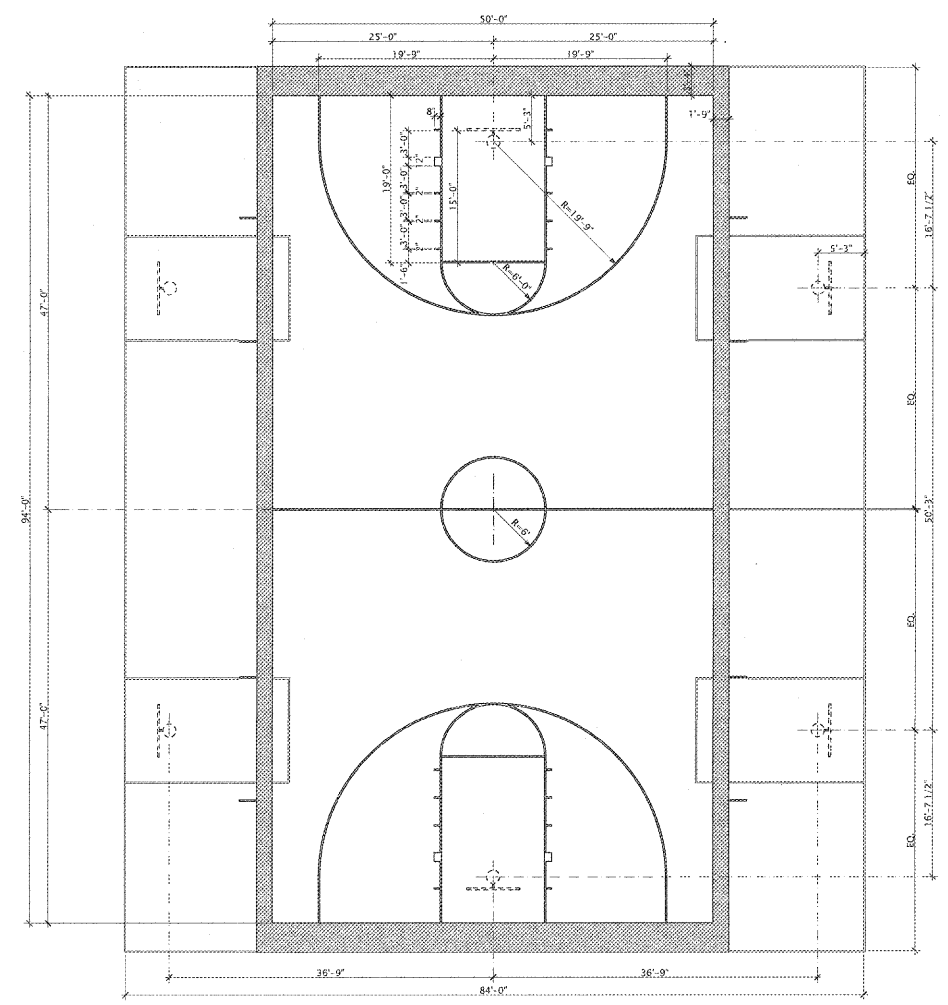

1 MAIN BASKETBALL & PRACTICE COURT - DIMENSION PLAN
SCALE: 1/8" = 1'-0"

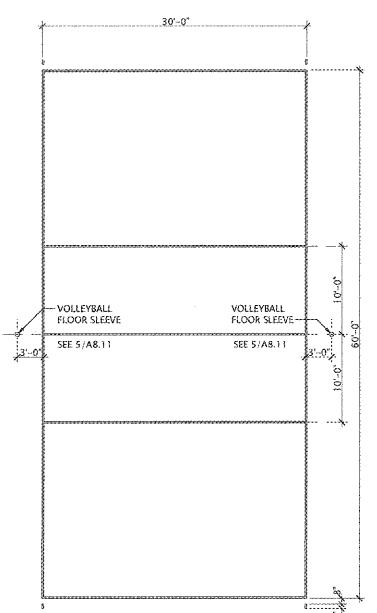

2 VOLLEYBALL COURT - DIMENSION PLAN
SCALE: 1/8" = 1'-0"

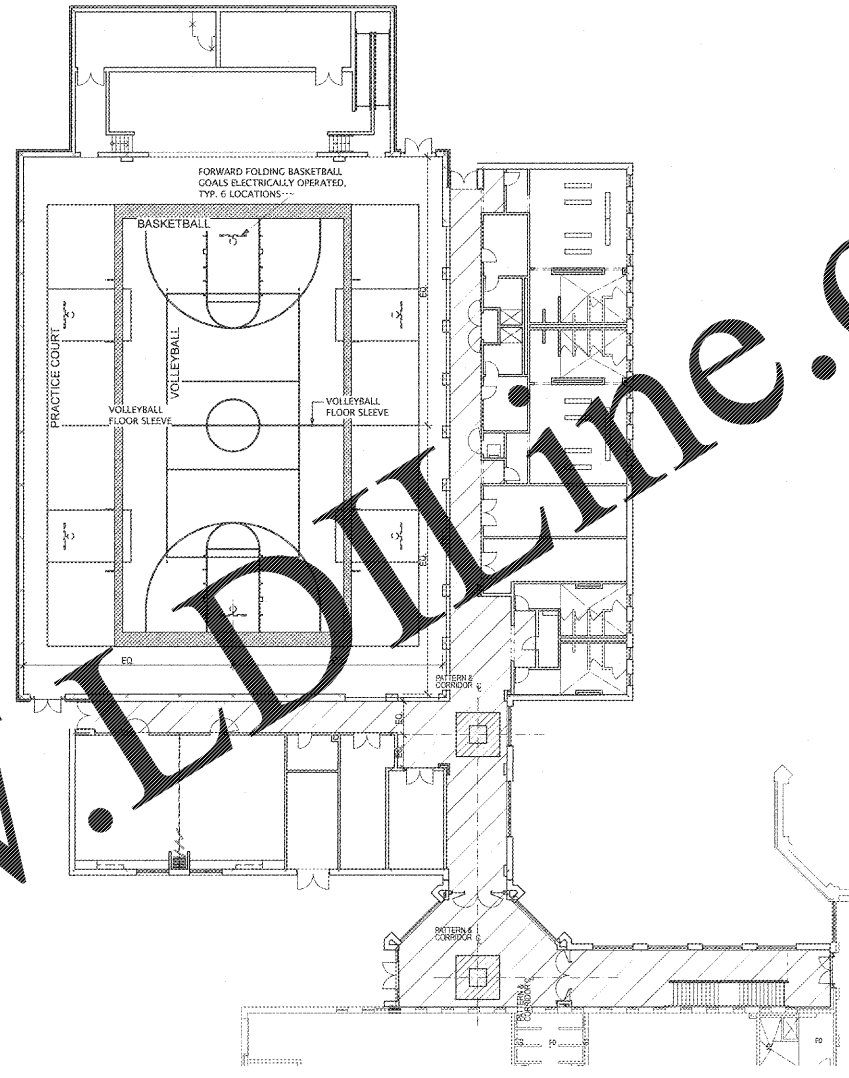

3 PARTIAL FLOOR PATTERN PLAN
SCALE: 1/16" = 1'-0"

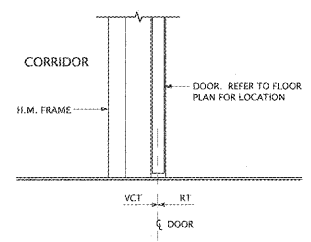

4 TILE DETAIL, TYP.
SCALE: 1/32" = 1'-0"

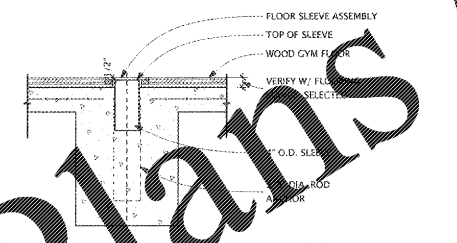

5 VOLLEYBALL SLEEVE DETAIL
SCALE: 1" = 1'-0"

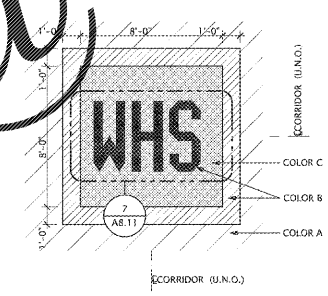

6 FLOOR PATTERN DETAIL
SCALE: 1/4" = 1'-0"

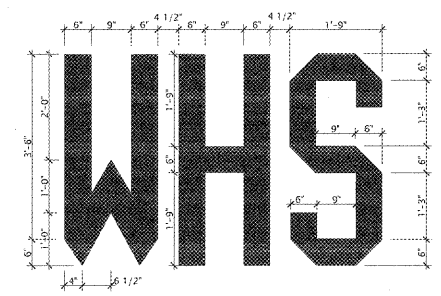

7 DHS DIMENSION DETAIL
SCALE: 3/4" = 1'-0"

FLOOR COVERING LEGEND & NOTES	
LEGEND:	
	VINYL COMPOSITION TILE - VCT-1 (COLOR A)
	VINYL COMPOSITION TILE - VCT-2 (COLOR B)
	VINYL COMPOSITION TILE - VCT-2 (COLOR C)
	RAISED DISC RUBBER FLOOR TILE - RT-2
	WHS VINYL COMPOSITION TILE - VCT-2 (COLOR B), SOLID
GENERAL NOTES:	
1. THIS DRAWING INDICATES FLOOR TILE PATTERS, ACCENT STRIPS AND COLORS IN CORRIDORS, LOBBIES, COMMONS, ETC.	
2. THIS DRAWING DOES NOT INDICATE THE SCOPE OF TILE WORK; SCOPE OF TILE WORK AND FLOOR FINISHES IS INDICATED ON FLOOR PLANS AND FINISH SCHEDULE.	
3. ALL OTHER SPACES INDICATED ON FINISH SCHEDULE TO RECEIVE VINYL COMPOSITION TILE SHALL BE VCT-1 (COLOR A).	
4. PROVIDE RUBBER STAIR TREADS & RISERS AT ALL STAIRS U.N.D.	

THIS SHEET ONLY:
ALL VINYL COMPOSITION TILE IN THE NEW ADDITION AREAS IS NEW FOR COLORS A, B & C.

COURT MARKINGS NOTES	
GENERAL NOTES:	
1. COMPLETE APPROVAL BY OWNER OF LAYOUT, COLORS, STRIPING, & ETC. SHALL BE REQUIRED PRIOR TO PAINTING OF ANY COURT MARKINGS. PROVIDE SAMPLES OF ALL COLORS. MULTIPLE COLORS SHALL BE ANTICIPATED.	
2. ALL COURT MARKINGS SHALL COMPLY WITH THE NATIONAL FEDERATION COURT & FIELD DIAGRAM GUIDE (LATEST EDITION) PUBLISHED BY THE NATIONAL FEDERATION OF STATE HIGH SCHOOL ASSOCIATIONS. PH: 816-464-5400.	
3. MAIN BASKETBALL COURT LINES SHALL BE PAINTED SOLID 2" WIDE.	
4. PRACTICE BASKETBALL COURT LINES SHALL BE PAINTED SOLID 2" WIDE.	
5. VOLLEYBALL COURT LINES SHALL BE PAINTED SOLID 2" WIDE.	
6. WHERE LOWER PRIORITY COURT STRIPING CROSSES STRIPING OF A HIGHER COURT PRIORITY, PROVIDE A 3/4" GAP BETWEEN LINES.	
7. COURT PRIORITIES: A. BASKETBALL (MAIN) B. VOLLEYBALL C. BASKETBALL (PRACTICE)	
8. COURT LINE COLORS SHALL BE SELECTED BY ARCHITECT. COLOR DESIGNATIONS SHALL BE AS FOLLOWS: COLOR 1: BASKETBALL (MAIN LINES) COLOR 2: BASKETBALL (MAIN BORDER) COLOR 3: VOLLEYBALL COLOR 4: BASKETBALL (PRACTICE)	

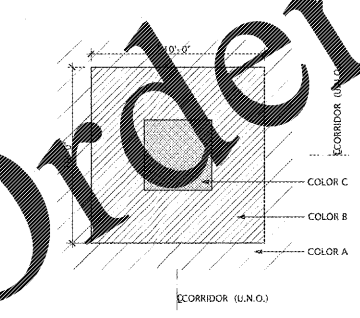

8 FLOOR PATTERN DETAIL
SCALE: 1/8" = 1'-0"

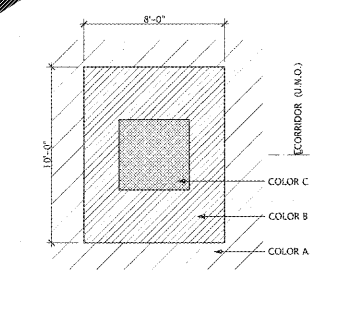

9 FLOOR PATTERN DETAIL
SCALE: 1/4" = 1'-0"

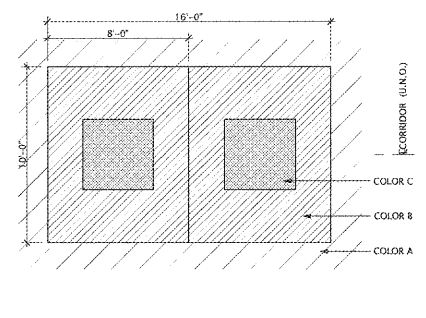

10 FLOOR PATTERN DETAIL
SCALE: 1/4" = 1'-0"

Order Plans @ www.LDOnline.com