

MATCH LINE - SEE SECTOR "G"
MATCH LINE - SEE SECTOR "H"

REVISIONS/ISSUANCES

KEYPLAN

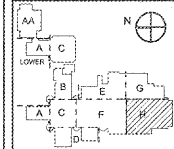

**Manley
Spangler
Smith
Architects**
A Professional Corporation

825 East Taylor St.
P.O. Box 880
Conley, Georgia 30204
Office 770.227.5473
Fax 770.228.3442

PROJECT:
RENOVATIONS,
MODIFICATIONS, &
ADDITIONS TO HENRY
COUNTY SCHOOLS -
GROUP 10
WOODLAND HIGH SCHOOL
(ITEM C)
CLIENT:
HENRY COUNTY BOARD
OF EDUCATION

SHEET TITLE:
REFLECTED CEILING
PLAN - SECTOR "H"

1/1 : 87
F.T.E. : 1887
FACILITY CODE: 675-0408
© 2018 Manley Spangler Smith Architects, PC
PROJECT NUMBER: 201721C
DATE: 08.07.18
SCALE: AS NOTED
DRAWN BY: JS
CHECKED BY: RV

SHEET NO.:
A7.21H

Order Plans @ www.LDILine.com

REFLECTED CEILING PLAN - SECTOR "G"

SCALE: 1/8" = 1'-0"
BIM Server: 1920721C:Woodland HS Csp-10