

**Manley Spangler Smith Architects**  
A Professional Corporation

525 East Taylor St.  
P.O. Box 880  
Cuthbert, Georgia 30224  
Office: 770.227.5473  
Fax: 770.228.3442

PROJECT:  
**RENOVATIONS, MODIFICATIONS, & ADDITIONS TO HENRY COUNTY SCHOOLS - GROUP 10 WOODLAND HIGH SCHOOL (ITEM C)**

CLIENT:  
**HENRY COUNTY BOARD OF EDUCATION**

SHEET TITLE:  
**REFLECTED CEILING PLAN - SECTOR "A"**

DATE: 06.07.19  
SCALE: AS NOTED  
DRAWN BY: JS  
CHECKED BY: RV

SHEET NO.:  
**A7.21A**

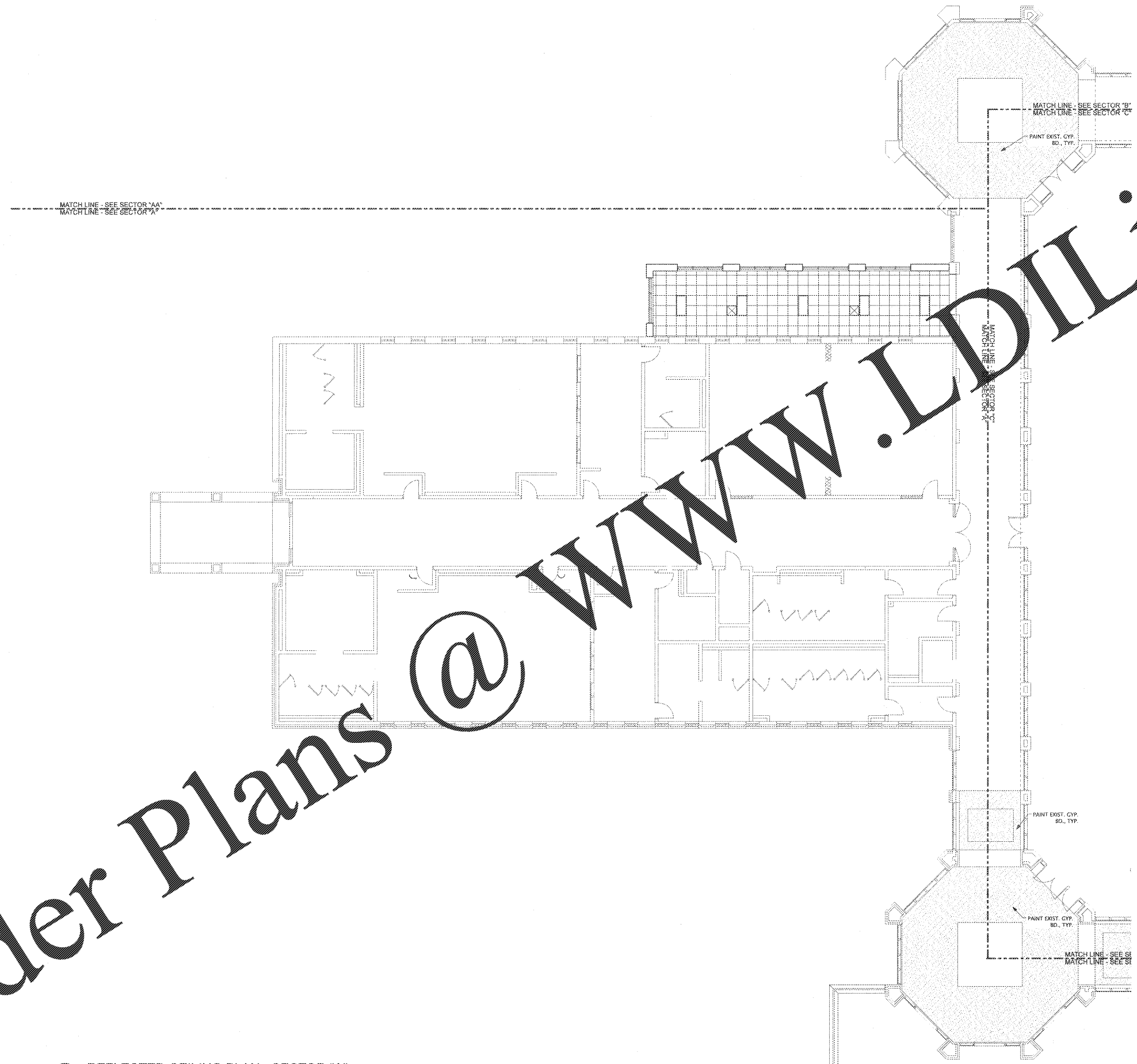

**LEGEND:**

- INDICATES CEILING HEIGHT
- NEW 2' x 2' ACoustICAL CEILING PANELS W/ NEW GRID
- NEW D.E.F.S. SOFFIT SYSTEM
- NEW CEMENT PLASTER CEILING
- NEW GYPSUM BOARD CEILING IN SECTORS AA & ALL EXT. GYP. BD. TO BE PAINTED IN ALL OTHER SECTORS.
- NEW 2' x 4' FL. LIGHT FIXTURES IN SECTORS AA, A, B & G WHERE NEW GRID IS INDICATED. EXT. FIXTURES IN ALL OTHER SECTORS.
- EXIST. 1' x 4' SURFACE MTD. FL. LIGHT FIXTURE
- NEW 1' x 4' FL. LIGHT FIXTURE IN SECTORS AA, A, B & G WHERE NEW GRID IS INDICATED. EXT. FIXTURES IN ALL OTHER SECTORS.
- NEW EXIT SIGN IN SECTORS AA, A, B & G WHERE NEW WORK IS INDICATED. EXT. SIGNS IN ALL OTHER SECTORS.
- NEW RECESSED DOWNLIGHT IN SECTORS AA, A, B & G WHERE NEW WORK IS INDICATED. EXT. FIXTURES IN ALL OTHER SECTORS.
- P.C.L. PRECAST CONCRETE LINTEL
- C.J. GYP. CL.G. OR DEFS CONTROL JOINT

**GENERAL NOTES:**

- WHERE NEW GRID IS INSTALLED FINISH CEILING ELEVATION IS 10'-0" ABOVE FINISH FLOOR, UNLESS NOTED OTHERWISE. ALIGN BOTTOM OF THE WALL ANGLE WITH THE TOP OF THE MORTAR JOINT IN LIEU OF LEVEL WITH THE FLOOR.
- CONTRACTOR SHALL COORDINATE ALL TRADES BEFORE INSTALLATION OF CEILING.
- IN AREAS WHERE GRID REMAINS, ADJUST TS AS NEEDED FOR NEW LIGHT LAYOUTS.
- IN LOCATIONS TO RECEIVE NEW CEILING TILE, REINSTALL ALL EXISTING ITEMS LOCATED IN THE CEILING TILE INCLUDING BUT NOT LIMITED TO EXIT LIGHTS, SPRINKLER HEADS, SPEAKERS, CAMERAS, HVAC RETURN AIR GRILLS, & HVAC CEILING DIFFUSERS ETC. ADJUST SPRINKLER HEADS AND OTHER ITEMS AS NEEDED TO COORDINATE WITH NEW LIGHT LAYOUTS IN AREAS WITH NEW GRID.
- SEE MECHANICAL DRAWINGS FOR NEW HVAC RETURN AIR GRILLS AND/OR HVAC CEILING DIFFUSERS.
- WHEN EXPOSED STRUCTURE IS INDICATED AS "PAINTED", IT IS INTENDED TO INCLUDE THE ROOF DECK.
- SEE FIRE PROTECTION, MECHANICAL AND ELECTRICAL DRAWINGS FOR ITEMS NOT INDICATED ON ARCHITECTURAL CEILING PLANS.
- EXISTING AND NEW PENETRATIONS NEED TO BE SEALED FOR SMOKE AND/OR RATED PARTITIONS IN AREAS WHERE CEILING TILES ARE REPLACED AND/OR NEW.

1 REFLECTED CEILING PLAN - SECTOR "A"  
SCALE: 1/8" = 1'-0"

Order Plans @ WWW.LDLine.com