

**PLAN LEGEND**

- COLUMN GRID AND/OR WALL CENTER LINES
- M.B., T.B. MARKER BOARD OR TACKBOARD
- FE FIRE EXTINGUISHER CABINET & FIRE EXTINGUISHER
- FE SURFACE MOUNTED FIRE EXTINGUISHER
- XX DOOR NUMBER
- XX WINDOW NUMBER
- XX ELEVATION MARKER

SEE SHEET A1.21A FOR PARTITION TYPE SCHEDULE, GENERAL NOTES AND PLAN KEY NOTES

REVISIONS/ISSUANCES

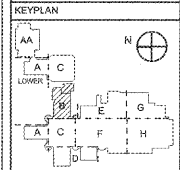

**Manley Spangler Smith Architects**  
A Professional Corporation

525 East Taylor St  
P.O. Box 590  
Gwin, Georgia 30224  
Office 770.227.5473  
Fax 770.228.3442

PROJECT:  
RENOVATIONS, MODIFICATIONS, & ADDITIONS TO HENRY COUNTY SCHOOLS - GROUP 10 WOODLAND HIGH SCHOOL (ITEM C)  
CLIENT:  
HENRY COUNTY BOARD OF EDUCATION

SHEET TITLE:  
FLOOR PLAN - SECTOR "B"

U.L.: 87  
P.L.E.: 1.687  
FACILITY CODE: 675-0408  
© 2018 Manley Spangler Smith Architects, PC  
PROJECT NUMBER: 201731C  
DATE: 06.07.18  
SCALE: AS NOTED  
DRAWN BY: JS  
CHECKED BY: RV

SHEET NO.:  
**A1.21B**

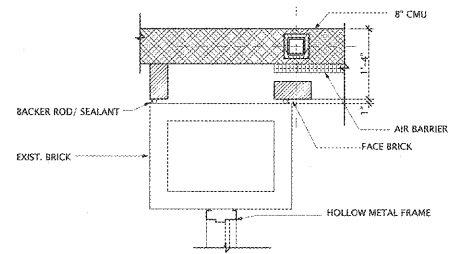

2 PLAN DETAIL  
SCALE: 3/4" = 1'-0"

Order Plans @

WWW.LDILine.com

1 FLOOR PLAN - SECTOR "B"  
SCALE: 1/8" = 1'-0"