

Order Plans

1/16" FLOOR PLAN - LOWER LEVEL
SCALE 1/16" = 1'-0"

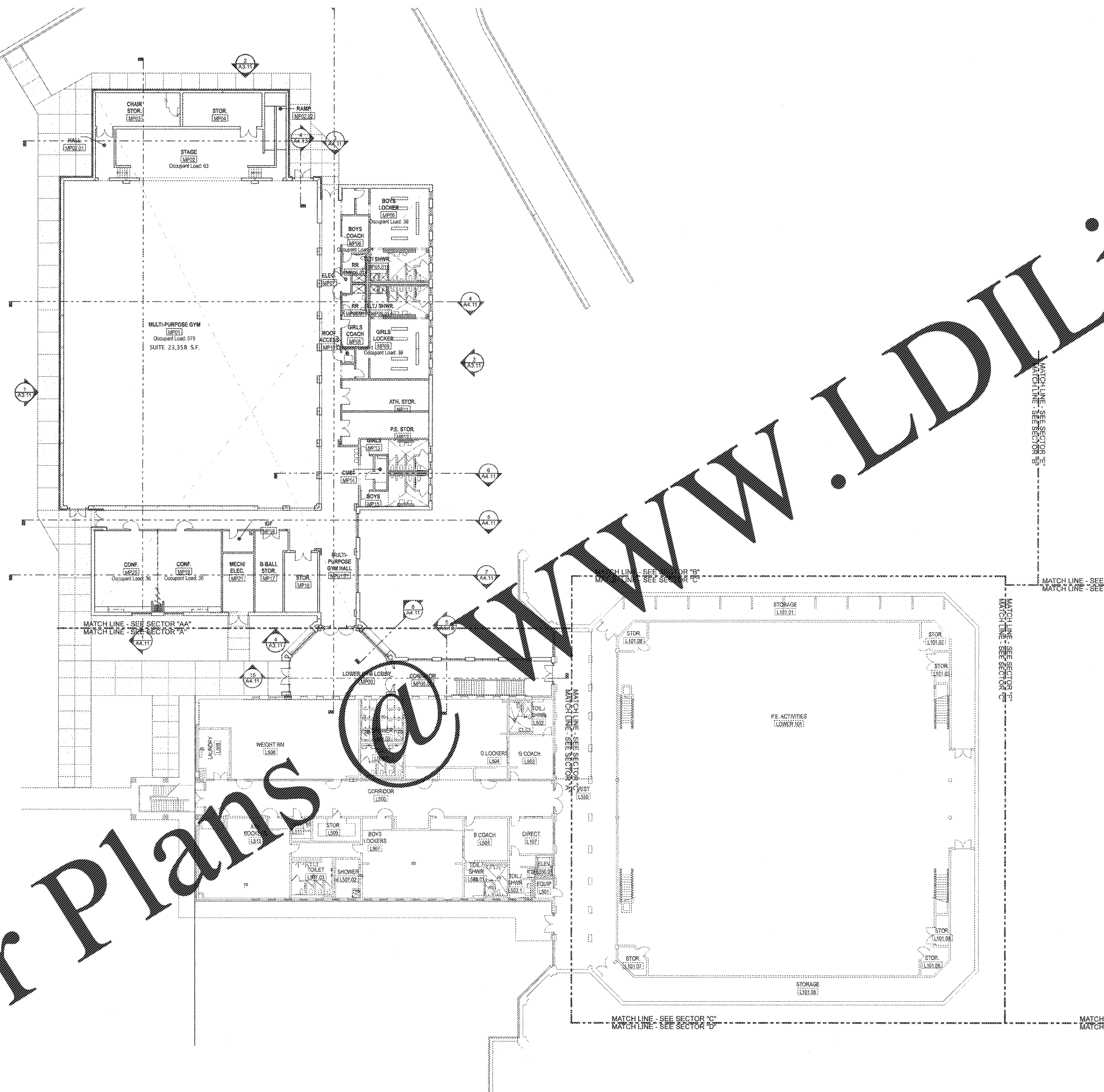

REVISIONS / ISSUANCES

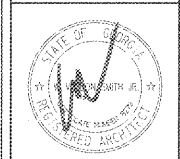
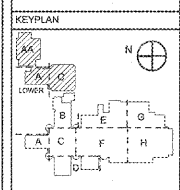

Manley Spangler Smith Architects
A Professional Corporation

525 East Taylor St.
P.O. Box 940
Gwin, Georgia 30224
Office 770.227.5473
Fax 770.228.3442

PROJECT:
RENOVATIONS,
MODIFICATIONS, &
ADDITIONS TO HENRY
COUNTY SCHOOLS -
GROUP 10
WOODLAND HIGH SCHOOL
(ITEM C)
CLIENT:
HENRY COUNTY BOARD OF
EDUCATION

SHEET TITLE:
1/16" FLOOR PLAN

LL: 87
P/E: 1,887
FACILITY CODE: 675-0406
© 2018 Manley Spangler Smith Architects, PC
PROJECT NUMBER: 2017310
DATE: 06.07.18
SCALE: AS NOTED
DRAWN BY: JS
CHECKED BY: RV

SHEET NO.:
A1.15