

REVISIONS/ISSUANCES

KEYPLAN

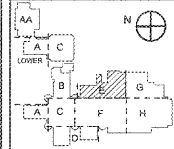

Manley Spangler Smith Architects
A Professional Corporation

825 East Taylor St.
P.O. Box 950
Griffin, Georgia 30224
Office 770.227.5473
Fax 770.228.3442

PROJECT:
RENOVATIONS,
MODIFICATIONS, &
ADDITIONS TO HENRY
COUNTY SCHOOLS -
GROUP 10
WOODLAND HIGH SCHOOL
(ITEM C)
CLIENT:
HENRY COUNTY BOARD
OF EDUCATION

SHEET TITLE:
DEMOLITION PLAN -
SECTOR "E"

LU: 87
DATE: 06.07.18
SCALE: AS NOTED
DRAWN BY: JS
CHECKED BY: RW

SHEET NO:
D1.21E

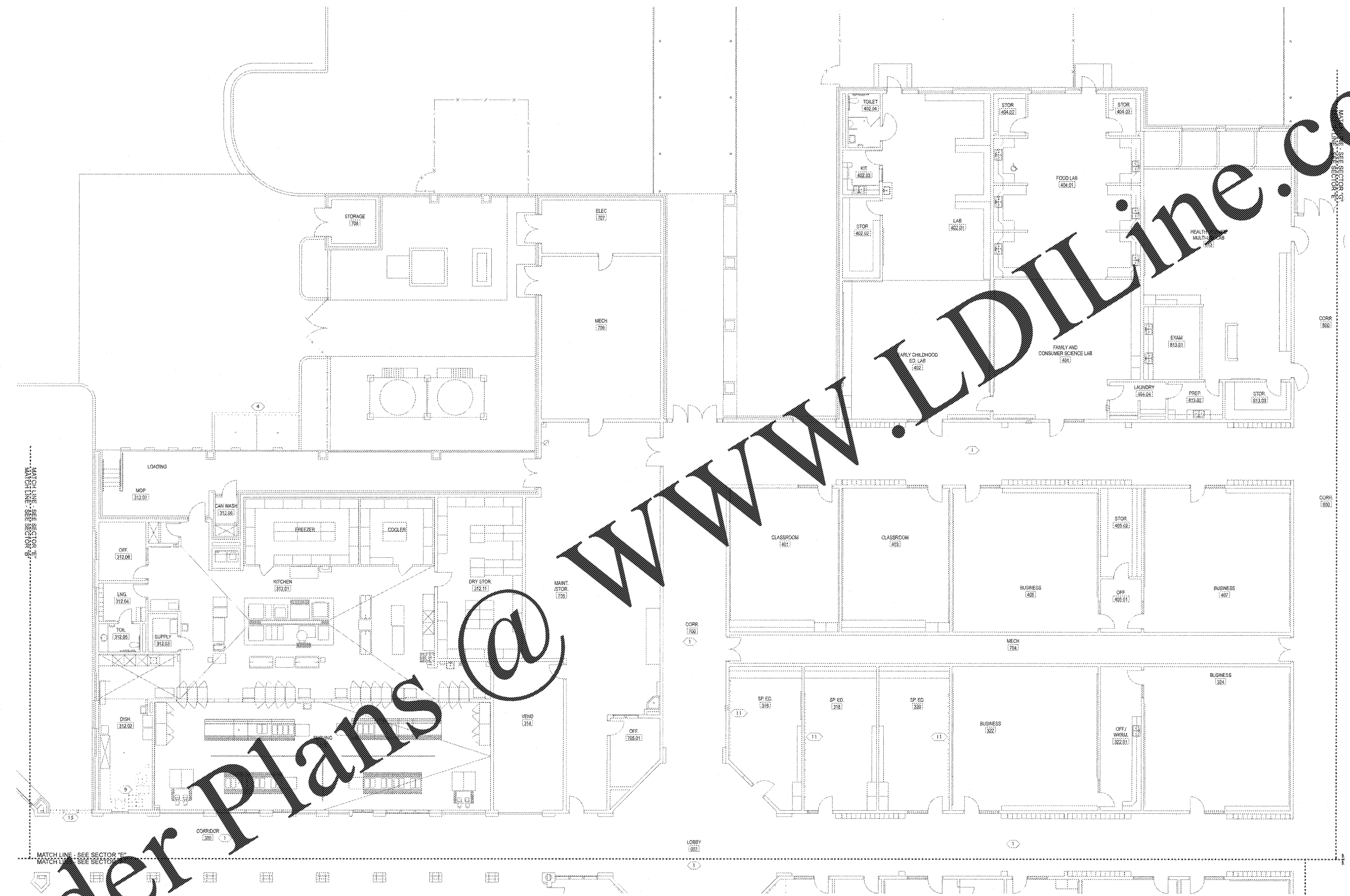

FLOOR PLAN - SECTOR "E"

DEMOLITION PLAN LEGEND	
	EXISTING CONSTRUCTION TO REMAIN
	EXISTING CONSTRUCTION TO BE DEMOLISHED

SEE SHEET D1.21A-L FOR DEMOLITION GENERAL NOTES AND PLAN KEY NOTES

Order Plans @

WWW.LDILine.com