

REVISIONS/ISSUANCES

NO.	DATE	DESCRIPTION

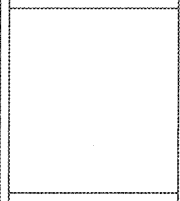

MATCH LINE - SEE SECTOR 'C'
MATCH LINE - SEE SECTOR 'E'

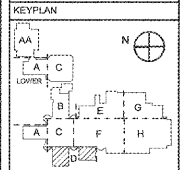

Manley Spangler Smith Architects
A Professional Corporation

525 East Taylor St.
P.O. Box 950
Griffin, Georgia 30224
Office 770.227.5473
Fax 770.228.3442

PROJECT:
RENOVATIONS, MODIFICATIONS, & ADDITIONS TO HENRY COUNTY SCHOOLS - GROUP 10 WOODLAND HIGH SCHOOL (ITEM C)
CLIENT:
HENRY COUNTY BOARD OF EDUCATION

SHEET TITLE:
DEMOLITION PLAN - SECTOR 'D'

DATE: 06.07.18
SCALE: AS NOTED
DRAWN BY: JS
CHECKED BY: RV

SHEET NO.:
D1.21D

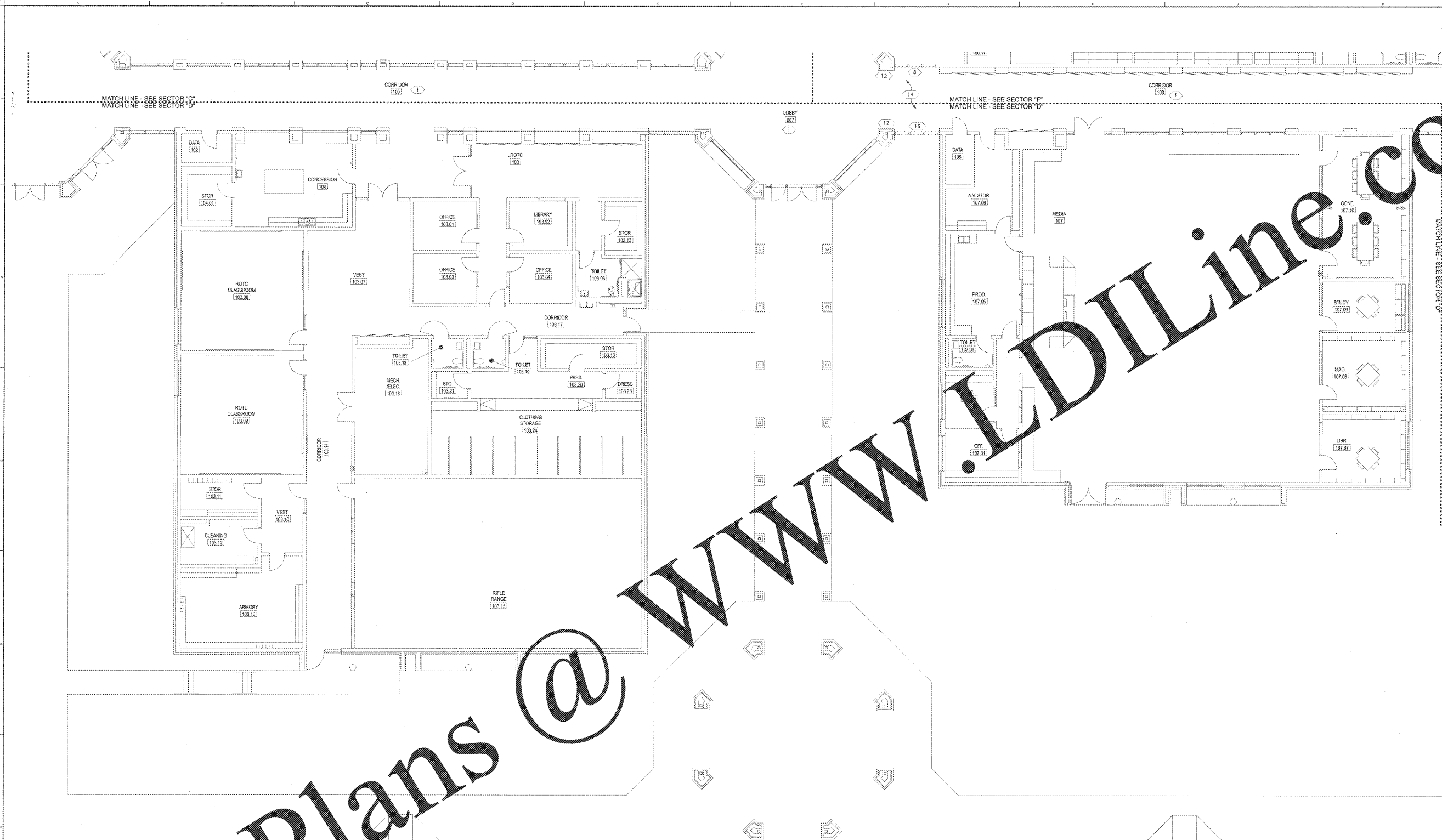

1 FLOOR PLAN - SECTOR 'D'
D1.21D SCALE 1/8" = 1'-0"

DEMOLITION PLAN LEGEND

	EXISTING CONSTRUCTION TO REMAIN
	EXISTING CONSTRUCTION TO BE DEMOLISHED

SEE SHEET D1.21A-L FOR DEMOLITION GENERAL NOTES AND PLAN KEY NOTES

Order Plans @

WWW.LDILine.com