

CONTRACT DRAWINGS

06.07.18

RENOVATIONS, MODIFICATIONS, & ADDITIONS TO HENRY COUNTY SCHOOLS - GROUP 10
WOODLAND HIGH SCHOOL (ITEM C)

800 N. MOSELEY DRIVE, STOCKBRIDGE, GA 30281

LOCAL EFFORT

CLIENT:

HENRY COUNTY BOARD OF EDUCATION

ARCHITECT:
MANLEY SPANGLER SMITH ARCHITECTS
525 EAST TAYLOR STREET
GRIFFIN, GA 30224
770-227-5473

CIVIL ENGINEER:
CARTER ENGINEERING GROUP
6310 PEAKE ROAD, SUITE 200
MACON, GA 31210
478-477-3923

STRUCTURAL ENGINEER:
HAINES, GIPSON & ASSOCIATES, INC.
1550 NORTH BROWN ROAD, SUITE 100
LAWRENCEVILLE, GA 30046
770-491-7500

MECHANICAL, PLUMBING & ELECTRICAL
ANDREWS, HAMMOCK & POWELL
250 CHARTER LANE, SUITE 100
MACON, GA 31210
478-405-8301

REVISIONS/ISSUANCES

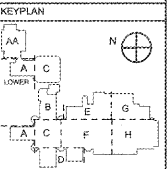

INDEX OF DRAWINGS

Table with columns: COVER, ARCHITECTURAL, PLUMBING, ELECTRICAL, MECHANICAL. Lists drawing titles and sheet numbers (e.g., PH1.1 PHASING PLAN, P101 PLUMBING FLOOR PLAN - SECTOR "AA").

SYMBOL LEGEND

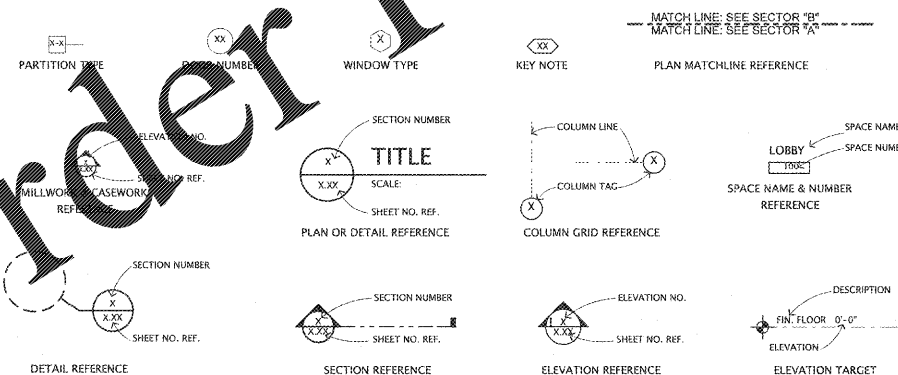

PROJECT DATA

Table with columns: GRADE RANGE, INSTRUCTIONAL UNITS, F.T.E., SCHOOL CODE NO., BLDG USE, OCC. GROUP, CONST. TYPE, EXISTING BUILDING, EXISTING COVERED AREA, GREENHOUSE, NEW ADDITION, NEW COVERED AREA, TOTAL BUILDING AREA.

GENERAL NOTES

1. 24 HOUR CONTACT: HENRY COUNTY SCHOOLS, 396 TOMLINSON STREET, MCDONOUGH, GA 30253 MR. JOSH MALCOM, 770-957-1891

NEW WORK BASED ON THE BELOW APPLICABLE CODES WITH GEORGIA AMENDMENTS. International Building Code 2012 edition, International Fire Code 2012 edition, International Mechanical Code 2012 edition, National Electrical Code 2017 edition, International Fire Code 2012 edition, International Energy Code 2009 edition, NFPA 101: 2012 edition, 2011 ADA Standards for Accessible Design.

FIRE MARSHAL CERTIFICATION

The Local Fire Official having jurisdiction has reviewed and approved a set of documents identical to this set of documents on... (Signed) Architect

SITE MAP

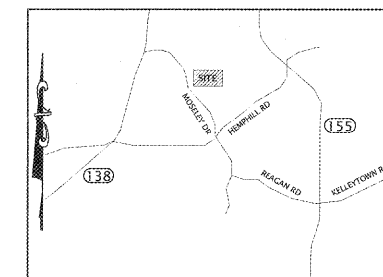

Manley Spangler Smith Architects
A Professional Corporation

525 East Taylor St
P.O. Box 880
Griffin, Georgia 30224
Office: 770.227.5473
Fax: 770.228.3442

PROJECT: RENOVATIONS, MODIFICATIONS, & ADDITIONS TO HENRY COUNTY SCHOOLS - GROUP 10 WOODLAND HIGH SCHOOL (ITEM C)
CLIENT: HENRY COUNTY BOARD OF EDUCATION

SHEET TITLE: COVER SHEET

1/1 - 87
P.T.E. - 1,687
FACILITY CODE: 875-0408
© 2018 Manley Spangler Smith Architects, PC
PROJECT NUMBER: 201731C
DATE: 06.07.18
SCALE: AS NOTED
DRAWN BY: JS
CHECKED BY: RV

SHEET NO. COVER

Order Plans @ WWW.LDILine.com