

Order Plans @

WWW.LDILine.com

NO.	DATE	DESCRIPTION

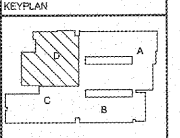

AH&P
CONSULTING ENGINEERS
ANDREWS, HAMBROOK & POWELL, INC.
261 Charter Lane
Rd 909 100
Macon, Georgia 31210
Macon (478) 455-2511
FAX (478) 455-8210
WWW.AHPENG.COM



Manley Spangler Smith Architects
A Professional Corporation

525 East Taylor St.
P.O. Box 880
Griffin, Georgia 30224
Office 770.227.5475
Fax 770.228.3442

PROJECT:
RENOVATIONS, MODIFICATIONS, & ADDITIONS TO HENRY COUNTY SCHOOLS - GROUP 16 WOODLAND MIDDLE SCHOOL (ITEM B)

CLIENT:
HENRY COUNTY BOARD OF EDUCATION

SHEET TITLE:
ELECTRICAL NEW WORK LOW VOLTAGE PLAN - SECTOR "D"

111.57
F.I.E.: 900
FACILITY CODE: 875-0208

© 2018 Manley Spangler Smith Architects, PC
PROJECT NUMBER: 2017318
DATE: 06.07.18
SCALE: 1/8"=1'-0"
DRAWN BY: AUS
CHECKED BY: MNO

SHEET NO:
E304

NOTES (THIS SHEET ONLY)

- PROVIDE VISUAL CONNECTIVITY AND COMPONENTS, SEE DETAIL.
- LOW VOLTAGE CABLES SHALL BE HOOKED THRU CORRIDOR TO ASSIGNER OF ROOF. PROVIDE 1/2" J-HOOKS (CADDY RACKS) FOUR FEET ON CENTERS THRU CORRIDORS (TYPICAL).
- SEE AUDIO VISUAL CONTROLLER PER DETAIL AND SPECIFICATIONS.

NOTE TO CONTRACTOR CONCERNING PROJECT PHASING:

THE WORK SPECIFIED ON THE DRAWINGS AND SPECIFICATIONS ILLUSTRATED THE COMPLETED CONTRACTUAL REQUIREMENTS. THIS PROJECT IS PHASED IN AND THIS PHASE. THE AREA FOR EACH PHASE IS DESCRIBED IN THE ARCHITECTURAL DOCUMENTS AND THE CONTRACTOR SHALL REVIEW THESE PHASING REQUIREMENTS. CONTRACTOR SHALL INCLUDE IN HIS BID ALL COSTS REQUIRED TO ACCOMPLISH THE CONTRACT IN PHASES. THE CONTRACT DOCUMENTS DO NOT DESCRIBE THE SPECIFIC WORK REQUIRED BY THE CONTRACTOR TO PHASING THE PROJECT IN PHASES, BUT CONTRACTOR SHALL PREPARE PHASING PLAN AND SUBMIT TO ARCHITECT/ENGINEER AND HENRY COUNTY MAINTENANCE DEPARTMENT PRIOR TO BEGINNING WORK.

GENERAL NOTES

- CONTRACTOR SHALL ROUTE VOICE, DATA AND OTHER SYSTEMS IN CONDUIT FROM WALL OUTLET TO ABOVE CORRIDOR CEILING. CABLEING SHALL THEN BE ROUTED VIA HOOKS TO DESTINATION. HOOKS SHALL BE INSTALLED ON BOTH SIDES OF CORRIDORS ON 4' CENTERS.
- ALL LOW VOLTAGE SYSTEMS ROUTED OUTSIDE OF BUILDING SHALL HAVE LIGHTNING PROTECTION REFERRED TO CORP CABLEING AS IT ENTERS THE BUILDING.
- ELECTRICAL INSTALLATIONS ON EXISTING WALLS SHALL HAVE CIRCUITS INSTALLED CONCEALED WITHIN MASONRY. CONTRACTOR SHALL NOT UNDER ANY CIRCUMSTANCE, UTILITY SURFACE METAL SURVEY TO METAL WIRE TRACES. SURSES SHALL BE CUT INTO EXISTING MASONRY WITH FLEX CONDUIT FISHED IN EXISTING WALL FROM ABOVE ACCESSIBLE CEILING.

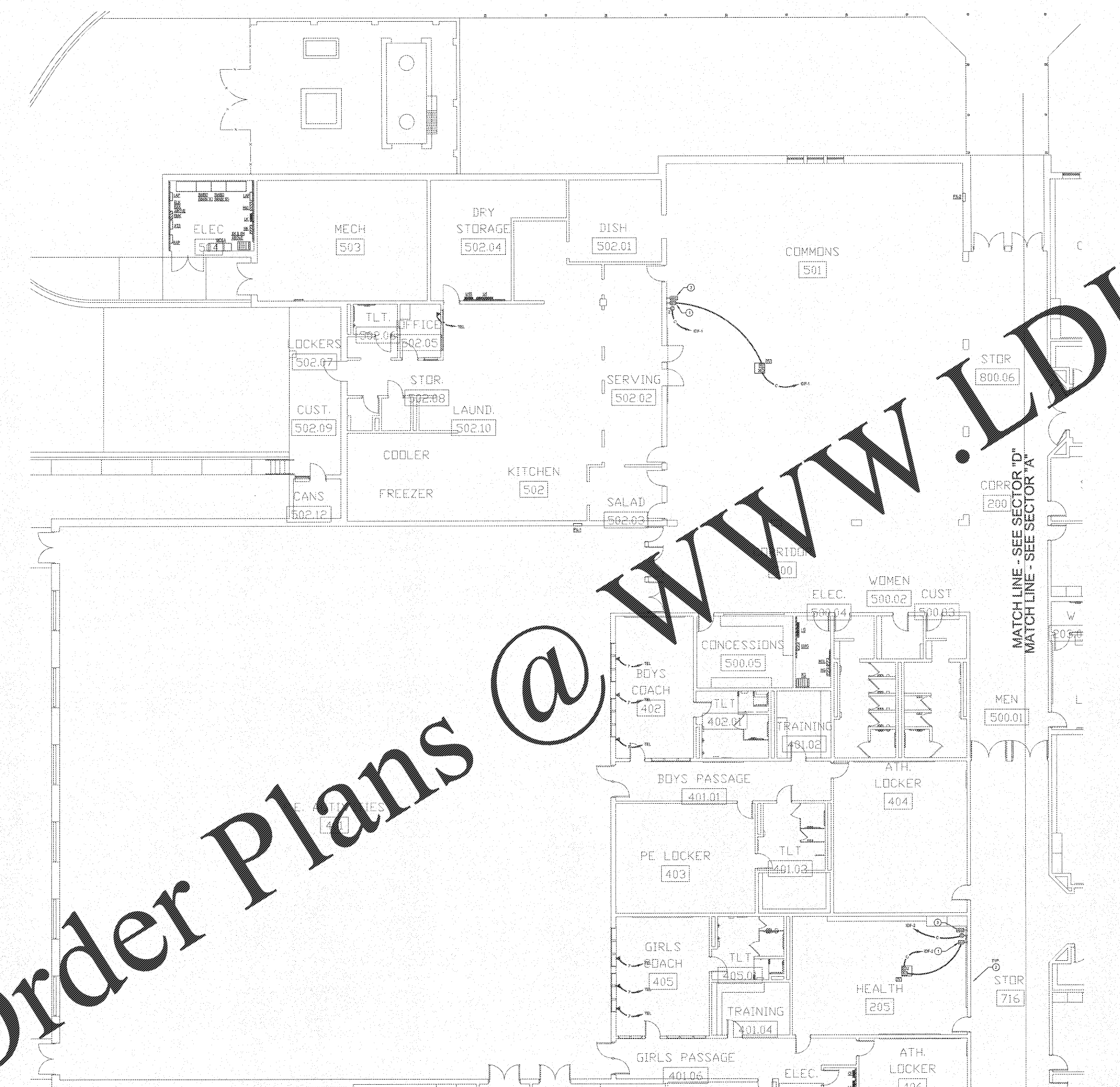

ELECTRICAL NEW WORK LOW VOLTAGE PLAN - SECTOR "D"
SCALE: 1/8"=1'-0"

MATCH LINE - SEE SECTOR "D"
MATCH LINE - SEE SECTOR "C"

MATCH LINE - SEE SECTOR "D"
MATCH LINE - SEE SECTOR "A"