

NOTE TO CONTRACTOR CONCERNING PROJECT PHASING:

THE WORK SPECIFIED ON THE DRAWINGS AND SPECIFICATIONS ILLUSTRATES THE COMPLETED CONTRACTUAL REQUIREMENTS. THIS PROJECT IS PHASED IN MULTIPLE PHASES. THE AREA OF EACH PHASE IS DESCRIBED IN THE ARCHITECTURAL DOCUMENTS AND THE CONTRACTOR SHALL REVIEW THESE PHASING REQUIREMENTS. CONTRACTOR SHALL PROVIDE IN HIS BID ALL COSTS REQUIRED TO ACCOMPLISH THE PROJECT IN PHASES. THE CONTRACT DOCUMENTS DO NOT DESCRIBE THE SPECIFIC WORK REQUIRED BY THE CONTRACTOR TO REPHASE THE PROJECT IN PHASES, BUT CONTRACTOR SHALL PREPARE PHASING PLAN AND SUBMIT TO ARCHITECT/ENGINEER AND HENRY COUNTY MAINTENANCE DEPARTMENT PRIOR TO BEGINNING WORK.

GENERAL NOTES

- CONTRACTOR SHALL ROUTE VOICE, DATA AND OTHER SYSTEMS IN CONDUIT FROM WALL TO FLOOR TO ABOVE CORRIDOR OR UNDER CABLING SHALL THEN BE ROUTED VIA JUNCTIONS TO DESTINATION. JUNCTIONS SHALL BE INSTALLED ON BOTH SIDES OF CORRIDORS ON 4' CENTERS.
- ALL LOW VOLTAGE SYSTEMS ROUTED OUTSIDE OF BUILDING SHALL HAVE LIGHTNING PROTECTION APPLIED TO COPPER CABLES AS IT ENTERS THE BUILDING.
- ELECTRICAL INSTALLATIONS ON EXISTING WALLS SHALL HAVE CIRCUITS INSTALLED CONSPICUOUS WITHIN MASONRY. CONTRACTOR SHALL NOT DRILL ANY CIRCUMFERENCES, UTILIZE SURFACE METAL RACEWAYS TO INSTALL NEW DEVICES. RINGS SHALL BE CUT INTO EXISTING MASONRY WITH FLEX CONDUIT FRAMES IN EXISTING WALL FROM ABOVE ACCESSIBLE CEILING.

NOTES: (THIS SHEET ONLY)

- PROVIDE AUDIO VISUAL CONNECTIVITY AND COMPONENTS, SEE DETAIL.
- LOW VOLTAGE CABLING SHALL BE JUNCTIONED THRU CORRIDOR TO ASSIGNED BY RFP. PROVIDE LARGE JUNCTIONS (CADDY PLATES) FOUR FEET ON CENTERS THRU CORRIDORS (TYPICAL).
- PROVIDE AUDIO VISUAL CONTROLLER PER DETAIL AND SPECIFICATIONS.
- DF-4 LOCATED ON MEZZANINE LEVEL.
- EXISTING TWO POST RACK. INSTALL NEW SPECIFIED COMPONENTS IN EXISTING RACK.
- PROVIDE SPECIFIED DATA NETWORK SWITCHES, PATCH PANELS, WIRE MANAGERS, PATCH CORDS AND ETC. IN EXISTING DATA NETWORK RACK FOR ALL NEW PORTS. SHOWING RECONNECT NEW SWITCHES TO EXISTING CABLES. LABEL THE 300 SERIES SWITCHES WITH STANDING CABLES AND WITH FIBER OPTIC CABLES BY NETWORK MODULE.
- REARRANGE EXISTING DATA NETWORK SWITCHES, PATCH PANELS, AND PATCH CORDS ETC. IN EXISTING DATA NETWORK RACK TO ACCOMMODATE NEW PATCH PANELS AND SWITCHES.
- PROVIDE TWO RACK MOUNTABLE POWER SUPPLY PER RACK AND CONNECT THEM TO THE RACK.
- EXTEND EXISTING BELOW SLAB DATA RACEWAY TO CONNECT TO THE NEW DATA PANELS IN NEW FLOOR PLAN.
- PROVIDE WALL BRACKET ISOLATED INTERACTIVE WHITE BOARD WITH PROJECTOR THRU PROJECTOR FOR THIS CLASSROOM AS SPECIFIED.

NO.	DATE	DESCRIPTION

KEY PLAN

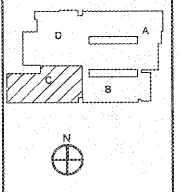

AH&P
CONSULTING ENGINEERS
ANDREWS, HAMROCK & POWELL, INC.
250 Charter Lane
Suite 100
Macon, Georgia 31210
Macon (478) 405-8331
FAX (478) 405-8216
WWW.AHPENGR.COM



Manley Spangler Smith Architects
A Professional Corporation

825 East Taylor St.
P.O. Box 880
Giffin, Georgia 30224
Office 770.227.8473
Fax 770.226.3442

PROJECT:
RENOVATIONS,
MODIFICATIONS, &
ADDITIONS TO HENRY
COUNTY SCHOOLS -
GROUP 10
WOODLAND MIDDLE
SCHOOL (ITEM B)

CLIENT:
HENRY COUNTY
BOARD OF EDUCATION

SHEET TITLE:
ELECTRICAL NEW WORK
LOW VOLTAGE PLAN -
SECTOR "C"

LIJ: 07
F.T.E.: 000
FACILITY CODE: 075-0308
© 2018 Manley Spangler Smith Architects, PC
PROJECT NUMBER: 201731B
DATE: 08.07.18
SCALE: 1/8"=1'-0"
DRAWN BY: A.S.
CHECKED BY: NKO

SHEET NO.:
E303

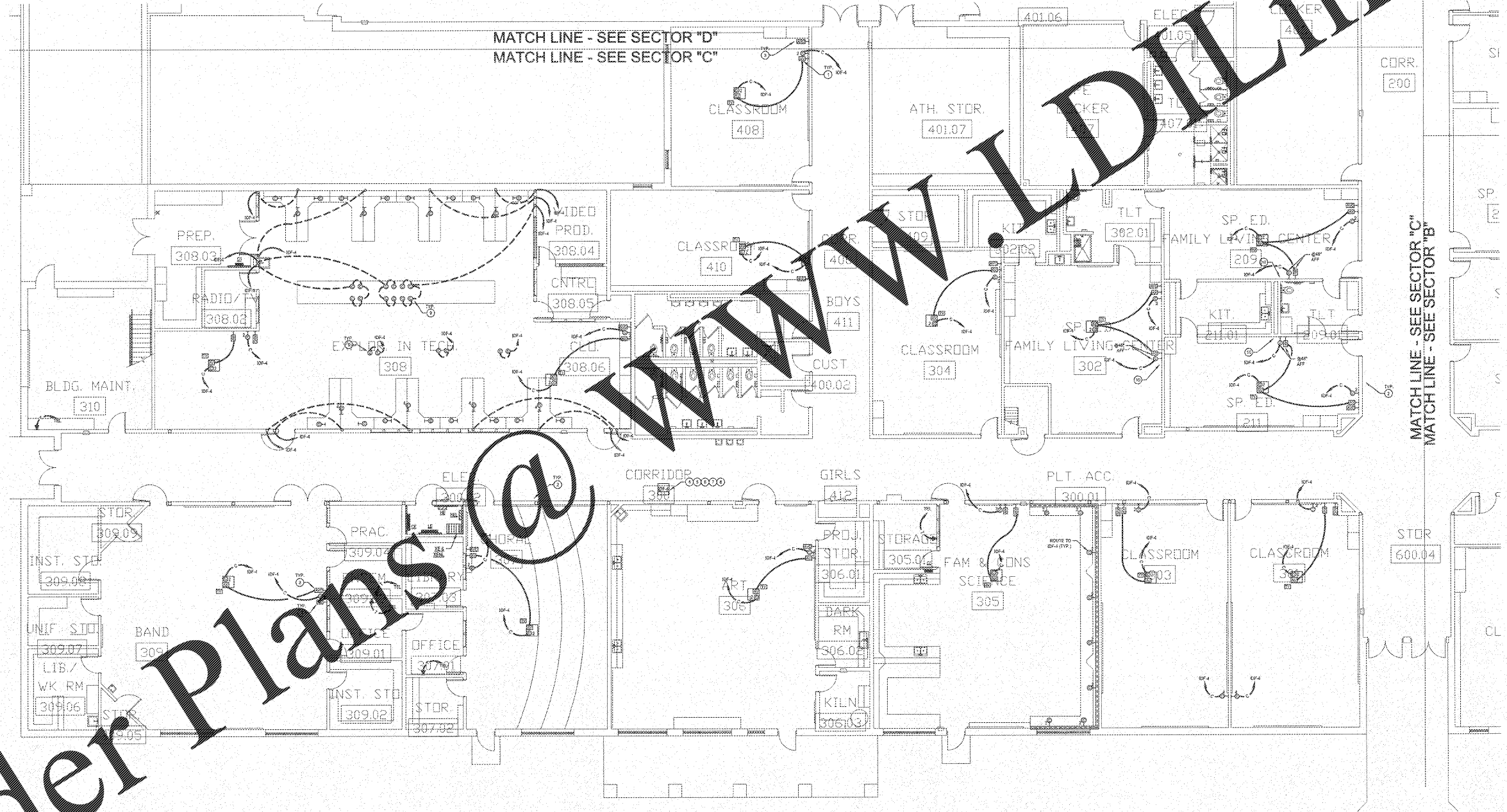

ELECTRICAL NEW WORK LOW VOLTAGE PLAN - SECTOR "C"
SCALE: 1/8"=1'-0"

Order Plans @ www.wldline.com