

**NOTE TO CONTRACTOR CONCERNING PROJECT PHASING:**

THE WORK SPECIFIED ON THE DRAWINGS AND SPECIFICATIONS ILLUSTRATES THE COMPLETED CONTRACTOR REQUIREMENTS. THIS PROJECT IS PHASED IN MULTIPLE PHASES. THE AREA OF EACH PHASE IS DESCRIBED IN THE ARCHITECTURAL DOCUMENTS AND THE CONTRACTOR SHALL REVIEW THESE PHASING REQUIREMENTS. CONTRACTOR SHALL INCLUDE IN HIS BID ALL COSTS NECESSARY TO ACCOMPLISH THE CONTRACT IN PHASES. THE CONTRACT DOCUMENTS DO NOT DESCRIBE THE SPECIFIC WORK REQUIRED BY THE CONTRACTOR TO PERFORM THE PROJECT IN PHASES, BUT CONTRACTOR SHALL PREPARE PHASING PLAN AND SUBMIT TO ARCHITECT/ENGINEER AND HENRY COUNTY MAINTENANCE DEPARTMENT PRIOR TO BEGINNING WORK.

**GENERAL NOTES**

1. CONTRACTOR SHALL ROUTE VOICE, DATA AND OTHER SYSTEMS IN CONDUIT FROM WALL OUTLET TO ABOVE CORRIDOR CEILING. CABLING SHALL THEN BE RIGIDLY SECURED TO STRUCTURE. HANGERS SHALL BE INSTALLED ON BOTH SIDES OF CORRIDORS ON 4' CENTERS.
2. ALL LOW VOLTAGE SYSTEMS ROUTED OUTSIDE OF BUILDING SHALL HAVE LIGHTNING PROTECTIVE DEVICES TO COVER CABLES AS IT ENTERS THE BUILDING.
3. ELECTRICAL INSTALLATIONS ON EXISTING WALLS SHALL HAVE GROUNTS INSTALLED CONCEALED WITHIN MASONRY. CONTRACTOR SHALL NOT, UNDER ANY CIRCUMSTANCES, UTILITY EXPOSE MASONRY TO INSTALL NEW DEVICES. RINGS SHALL BE CUT INTO EXISTING MASONRY WITH FILED CONDUIT FISHED IN EXISTING WALL FROM ABOVE ACCESSIBLE CEILING.

**NOTES: (THIS SHEET ONLY)**

1. PROVIDE AUDIO VISUAL CONNECTIVITY AND COMPONENTS SEE DETAIL.
2. LOW VOLTAGE CABLES SHALL BE HANGERS THRU CEILING TO BE ASSIGNED BY RFP.
3. PROVIDE LARGE HOOKS (GADT #424); FOUR FEET ON CENTERS THRU CORRIDORS (TYPICAL).
4. PROVIDE AUDIO VISUAL CONTROLLER PER DETAIL AND SPECIFICATIONS.
5. EX-3 LOCATED ON MEZZANINE LEVEL.
6. EXISTING TWO POST RACK. INSTALL NEW SPECIFIED COMPONENTS IN EXISTING RACK.
7. PROVIDE SPECIFIED DATA NETWORK SWITCHES, PATCH PANELS & WIRE MANAGERS, PATCH CORDS AND ETC. IN EXISTING DATA NETWORK RACK FOR ALL NEW PORTS. BROWN INTERCONNECT NEW SWITCHES TO EXISTING 250C CATALYT 265 SERIES SWITCHES WITH FIBRONE CABLES AND WITH FIBER OPTIC CABLES SEE NETWORK SCHEDULE.
8. REARRANGE EXISTING DATA NETWORK SWITCHES, PATCH PANELS, AND PATCH CORDS ETC. IN EXISTING DATA NETWORK RACK TO ACCOMMODATE NEW PATCH PANELS AND SWITCHES.
9. PROVIDE TWO RACK MOUNTABLE POWER STRIPS PER RACK AND COMPONENTS.
10. PROVIDE WALL BRACKET MOUNTED INTERACTIVE WHITEBOARD WITH 60" MONITOR, SHORT THROW PROJECTOR FOR THIS CLASSROOM AS SPECIFIED.

NO.	DATE	DESCRIPTION

**KEYPLAN**

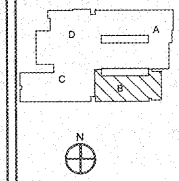

**AH&P CONSULTING ENGINEERS**  
 ANDREWS, HAMMOCK & POWELL, INC.  
 250 Charter Lane  
 Suite 100  
 MARIETTA, GEORGIA 30120  
 MARIETTA (478) 455-9301  
 FAX (478) 455-9210  
 WWW.AHPENGR.COM



**Manley Spangler Smith Architects**  
 A Professional Corporation

625 East Taylor St.  
 P.O. Box 880  
 Griffin, Georgia 30224  
 Office 770.227.5470  
 Fax 770.228.3442

PROJECT:  
 RENOVATIONS, MODIFICATIONS, & ADDITIONS TO HENRY COUNTY SCHOOLS - GROUP 10 WOODLAND MIDDLE SCHOOL (ITEM B)

CLIENT:  
 HENRY COUNTY BOARD OF EDUCATION

SHEET TITLE:  
 ELECTRICAL NEW WORK LOW VOLTAGE PLAN - SECTOR "B"

1/1" = 5/8"  
 1/1" = 5/8"  
 FACILITY CODE: 676-0308  
 © 2018 Manley Spangler Smith Architects, PC  
 PROJECT NUMBER: 20171918  
 DATE: 06.07.18  
 SCALE: 1/8"=1'-0"  
 DRAWN BY: AJS  
 CHECKED BY: MJO

SHEET NO.:  
 E302

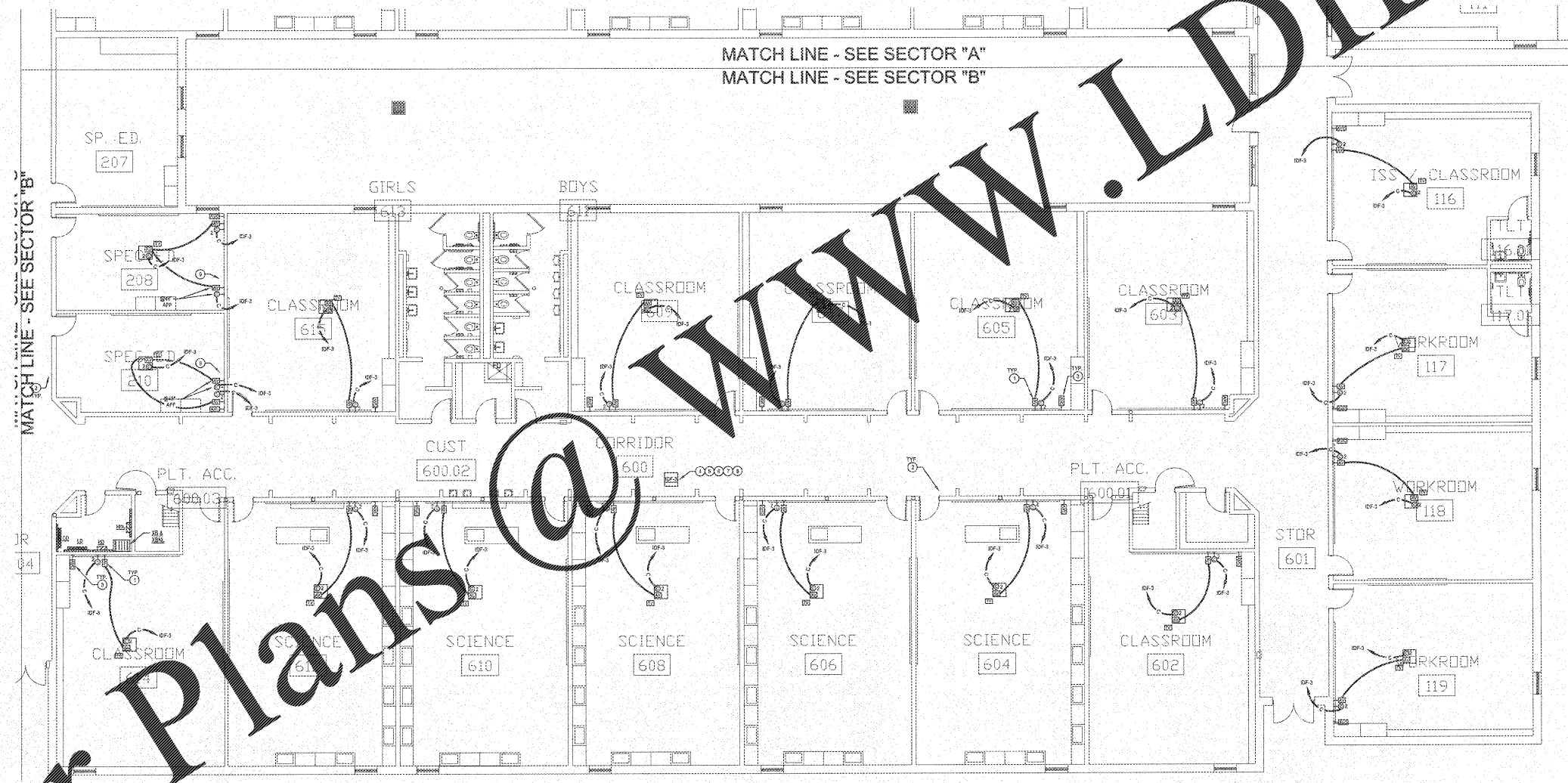

**ELECTRICAL NEW WORK LOW VOLTAGE PLAN - SECTOR "B"**  
 SCALE: 1/8"=1'-0"

Order Plans @ [www.LDLine.com](http://www.LDLine.com)