

**NOTES: (THIS SHEET ONLY)**

- 1 PROVIDE OUTLETS IN METAL CEILING PANEL, ENCLOSED AS SPECIFIED WITH PROJECTOR MOUNT, COORDINATE EXACT LOCATION WITH ARCHITECTURAL REFLECTED CEILING PLANS, LIGHT FIXTURES, ELECTRICAL CEILING MOUNTED DEVICES AND WHITE BOARD.
- 2 PROVIDE ABOVE VISUAL CONNECTIVITY, PROJECTOR, AND MOUNTING HARDWARE AS SPECIFIED AND SHOWN IN THE DETAIL.
- 3 ROUTE 2412, #100, 1/2" C AND MAKE POWER CONNECTION TO EXISTING TEACHERS COMPUTER CIRCUIT ABOVE CEILING.
- 4 ROUTE 2412, #100, 1/2" C AND MAKE POWER CONNECTION TO EXISTING TEACHERS COMPUTER CIRCUIT ABOVE CEILING.
- 5 EXISTING 66, TYPE ACP, 10020R, 3PK, 4X, PANELBOARD.
- 6 EXISTING 66, TYPE ACP, 07240N, 3PK, 4X, PANELBOARD.

**NOTE TO CONTRACTOR CONCERNING PROJECT PHASING:**

THE WORK SPECIFIED ON THE DRAWINGS AND SPECIFICATIONS ILLUSTRATES THE COMPLETED CONTRACTUAL REQUIREMENTS. THIS PROJECT IS PHASED IN MULTIPLE PHASES. THE AREA OF EACH PHASE IS DESCRIBED IN THE ARCHITECTURAL DOCUMENTS AND THE CONTRACTOR SHALL REVIEW THESE PHASING REQUIREMENTS. CONTRACTOR SHALL INCLUDE IN HIS BID ALL COSTS REQUIRED TO ACCOMPLISH THE PROJECT IN PHASES. THE CONTRACT DOCUMENTS DO NOT DESCRIBE THE SPECIFIC WORK REQUIRED BY THE CONTRACTOR TO SUPPORT THE PROJECT IN PHASES. THE CONTRACTOR SHALL PREPARE PHASING PLAN AND SUBMIT TO ARCHITECT AND HENRY COUNTY MAINTENANCE DEPARTMENT PRIOR TO BEING AWARDED.

**GENERAL NOTES:**

- 1 UNLESS SHOWN OTHERWISE, ALL EXISTING TO REMAIN CONDUIT SHALL BE PROTECTED WITH COVER PLATES AS SPECIFIED. MAKE CONNECTIONS TO EXISTING CONDUITS, EXTENDING EXISTING CONDUITS, AS NECESSARY.
- 2 WHERE CHANGING THE FORM FITTING CONDUIT SYSTEM FOR GROUNDING PATH, THE CONTRACTOR SHALL VERIFY AND VERIFY CONTINUITY OF THE GROUNDING PATH IF THE GROUNDING PATH IS DEEMED TO BE NON-CONTINUOUS. THE CONTRACTOR SHALL REMEDY THAT BY PROVIDING #12 GROUNDING CONDUCTOR BETWEEN POINTS TO PANEL.
- 3 ELECTRICAL INSTALLATIONS ON EXISTING WALLS SHALL HAVE CIRCUITS INSTALLED CONCEALED WITHIN MASONRY. CONTRACTOR SHALL NOT, UNDER ANY CIRCUMSTANCES, UTILIZE SURFACE METAL RACEWAYS TO METAL NON-FERROUS LINES (VOLTAGE OR 0V VOLTAGE). RACES SHALL BE CUT INTO EXISTING MASONRY WITH FLEX CONDUIT FINISHED RE-EXTENDING WALL FROM ABOVE ACCESSIBLE CEILING.
- 4 LOW VOLTAGE SYSTEMS OUTLETS SHOWN FOR INSTALLATION COORDINATION PURPOSES ONLY. SEE APPLICABLE LOW VOLTAGE FLOOR PLAN FOR OTHER REQUIREMENTS.

REVISIONS/ISSUANCES		
NO.	DATE	DESCRIPTION

**AH&P CONSULTING ENGINEERS**  
 ANDREWS, HAMMOCK & POWELL, INC.  
 251 Charter Lane  
 Suite 100  
 MACON, GEORGIA 31210  
 MACON (478) 465-8301  
 FAX (478) 465-8210  
 WWW.AHPENGR.COM



**Manley Spangler Smith Architects**  
 A Professional Corporation

625 East Taylor St.  
 P.O. Box 480  
 Griffin, Georgia 30224  
 Office 770.227.5473  
 Fax 770.228.3442

PROJECT:  
 RENOVATIONS, MODIFICATIONS, & ADDITIONS TO HENRY COUNTY SCHOOLS - GROUP 18 WOODLAND MIDDLE SCHOOL (ITEM B)

CLIENT:  
 HENRY COUNTY BOARD OF EDUCATION

SHEET TITLE:  
 ELECTRICAL NEW WORK POWER PLAN - SECTOR "D"

111 - 57  
 F.T.S. - 900  
 FACILITY CODE: 875-0308  
 © 2018 Manley Spangler Smith Architects, PC  
 PROJECT NUMBER: 2017318  
 DATE: 06.07.18  
 SCALE: 1/8"=1'-0"  
 DRAWN BY: AJS  
 CHECKED BY: MJD

SHEET NO.: E204

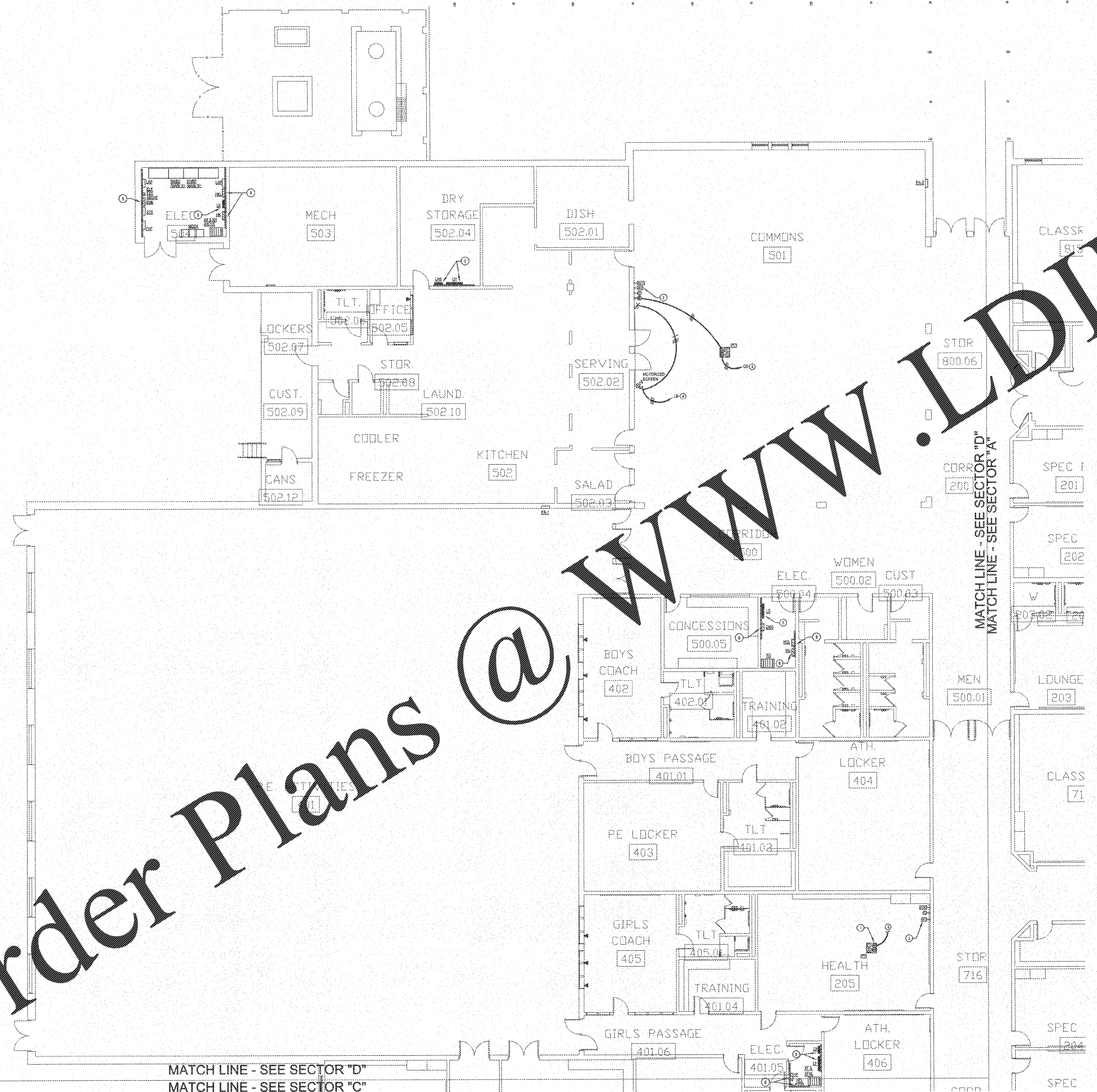

Order Plans @ WWW.LDLINE.COM

**ELECTRICAL NEW WORK POWER PLAN - SECTOR "D"**  
 SCALE: 1/8"=1'-0"

MATCH LINE - SEE SECTOR "D"  
 MATCH LINE - SEE SECTOR "C"

MATCH LINE - SEE SECTOR "D"  
 MATCH LINE - SEE SECTOR "A"