

**NOTE TO CONTRACTOR CONCERNING PROJECT PHASING:**

THE WORK SPECIFIED ON THE DRAWINGS AND SPECIFICATIONS ILLUSTRATES THE COMPLETED CONTRACTUAL REQUIREMENTS. THIS PROJECT IS PHASED IN MULTIPLE PHASES. THE AREA OF EACH PHASE IS DESCRIBED IN THE ARCHITECTURAL DOCUMENTS AND THE CONTRACTOR SHALL REVIEW THESE PHASING REQUIREMENTS. CONTRACTOR SHALL INCLUDE IN HIS BID ALL COSTS REQUIRED TO ACCOMPLISH THE CONTRACT IN PHASES. THE CONTRACT DOCUMENTS DO NOT DESCRIBE THE SPECIFIC WORK REQUIRED BY THE CONTRACTOR TO PERFORM THE PROJECT IN PHASES, BUT CONTRACTOR SHALL PREPARE PHASING PLAN AND SUBMIT TO ARCHITECT/ENGINEER AND HENRY COUNTY MAINTENANCE DEPARTMENT PRIOR TO BEGINNING WORK.

- GENERAL NOTES**
- RECEPTACLES SHOWN WITHOUT CIRCUIT WIRING ARE EXISTING TO REMAIN. CONTRACTOR SHALL PROVIDE NEW DEVICES AND COVER PLATES AS SPECIFIED. MAKE CONNECTIONS TO EXISTING CIRCUIT CONDUCTORS, EXTEND EXISTING CONDUCTORS AS NECESSARY.
  - WHERE CIRCUITS ARE FOUND UTILIZING CONDUIT SYSTEM FOR GROUNDING PATH, THE CONTRACTOR SHALL TEST AND VERIFY CONTINUITY OF THE GROUNDING PATH. IF THE EXISTING GROUNDING PATH IS DETERMINED TO BE NON-CONTINUOUS, THE CONTRACTOR SHALL VERIFY THAT BY PROVIDING #12 GROUNDING CONDUCTOR IN EXISTING CONDUIT BACK TO PANEL.
  - ELECTRICAL INSTALLATIONS ON EXISTING WALLS SHALL HAVE CIRCUITS INSTALLED CONCEALED WITHIN MASONRY. CONTRACTOR SHALL NOT, UNDER ANY CIRCUMSTANCES, UTILIZE SURFACE METAL RACEWAYS TO INSTALL NEW DEVICES LINE VOLTAGE OR LOW VOLTAGE. BOXES SHALL BE CUT INTO EXISTING MASONRY WITH FLEX CONDUIT FISHED IN EXISTING WALL FROM ABOVE ACCESSIBLE CEILING.
  - LOW VOLTAGE SYSTEMS OUTLETS SHOWN FOR INSTALLATION COORDINATE RESPONSES ONLY. SEE APPLICABLE LOW VOLTAGE FLOOR PLAN FOR OTHER REQUIREMENTS.

**NOTES: (THIS SHEET ONLY)**

- PROVIDE OUTLETS IN METAL CEILING PANEL ENCLOSURE AS SPECIFIED WITH PROTECTOR MOUNT. COORDINATE EXACT LOCATION WITH ARCHITECTURAL REFLECTED CEILING PLAN, LIGHT FIXTURES, ELECTRICAL CEILING MOUNTED DEVICES AND WHITE BOARD.
- PROVIDE AUDIO VISUAL CONNECTIVITY PROJECTOR AND SOUNDING HARDWARE AS SPECIFIED AND SHOWN IN THE DETAIL.
- ROUTE #12, #10, 12FC AND 30MCM POWER CONNECTION TO EXISTING TEACHERS COMPUTER CIRCUIT ABOVE CEILING.
- EXISTING 02, TYPE A5F, 12000V, 3PH, 4W, PANELBOARD.
- EXISTING 02, TYPE A7F, 27000V, 3PH, 4W, PANELBOARD.
- LOCATED ON MEZZANINE LEVEL.

REVISIONS/ISSUANCES		
NO.	DATE	DESCRIPTION

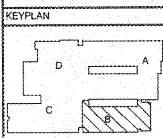

**AH&P**  
CONSULTING ENGINEERS

ANDREWS, HAMMOCK & POWELL, INC.  
250 Charter Lane  
Suite 110  
MADISON, GEORGIA 31210  
MADISON (478) 405-8301  
FAX (478) 405-8210  
WWW.AHPENGR.COM



**Manley Spangler Smith Architects**  
A Professional Corporation

525 East Taylor St.  
P.O. Box 880  
Griffin, Georgia 30224  
Office 770.227.5473  
Fax 770.228.3442

PROJECT:  
RENOVATIONS, MODIFICATIONS, & ADDITIONS TO HENRY COUNTY SCHOOLS - GROUP 10 WOODLAND MIDDLE SCHOOL (ITEM B)

CLIENT:  
HENRY COUNTY BOARD OF EDUCATION

SHEET TITLE:  
ELECTRICAL NEW WORK POWER PLAN - SECTOR "B"

1/11/18  
P.L.E.: 800  
FACILITY CODE: 075-0308  
© 2018 Manley Spangler Smith Architects, INC.  
PROJECT NUMBER: 2017318  
DATE: 06.07.18  
SCALE: 1/8"=1'-0"  
DRAWN BY: AJS  
CHECKED BY: 1890

SHEET NO.:  
E202

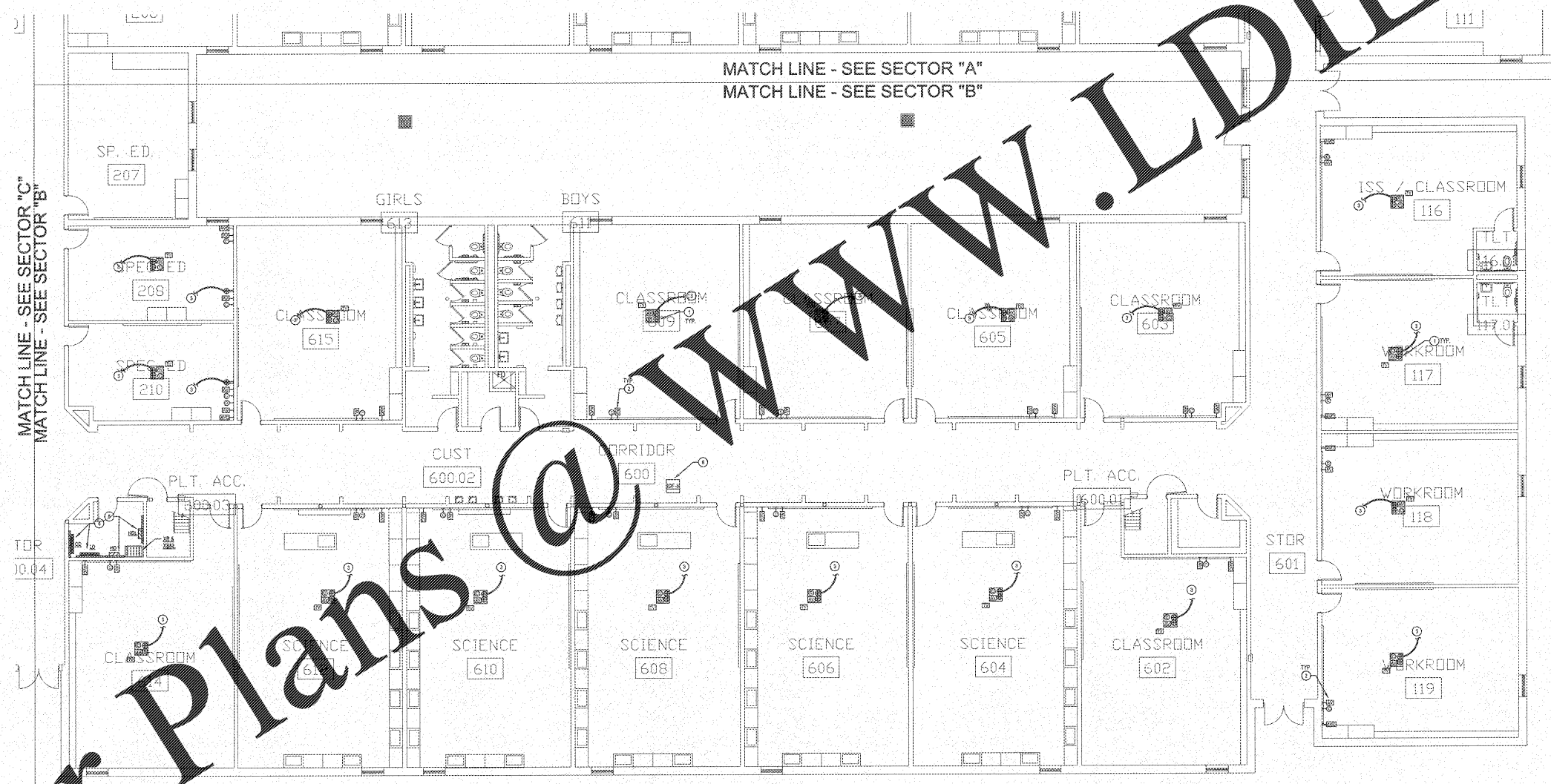

**ELECTRICAL NEW WORK POWER PLAN - SECTOR "B"**  
SCALE: 1/8"=1'-0"

Order Plans @ [www.LDLine.com](http://www.LDLine.com)