

REVISIONS/ISSUANCES		
NO.	DATE	DESCRIPTION

**NOTES: (THIS SHEET ONLY)**

- GENERAL: ALL EMERGENCY EGRESS LIGHT FIXTURES, ELEC NORMAL POWER SENSING CIRCUIT, AND EXIT SIGNS SHALL BE UNINTERRUPTED.
- GENERAL: CLASSROOM LIGHTS SHALL SWITCH PRIOR TO ROWS OF LIGHTS, CLOSEST TO MARKER BOARD AND INTERACTIVE PROJECTOR, ON ONE (1) SIDE AND BACK ROWS OF LIGHTS ON OTHER FOR CLASSROOM IN ROOM LIGHTING. EXISTING LIGHTING FIXTURES ARE AS SHOWN IN CLASSROOMS.
- INTERCEPT EXISTING LIGHTING CIRCUITS IN ABOVE CEILING LIGHTING JUNCTION BOXES TO PROVIDE ROW SWITCHING AS NOTED, UTILIZE 2412, 12/2 TO EXTEND AND MAKE CONNECTION TO EXISTING 277V LIGHTING CIRCUIT.
- PROVIDE LINE VOLTAGE OCCUPANCY SENSOR AS SHOWN INTERCEPT EXISTING CIRCUIT UTILIZING #12, #10, 12/2, MAKE ALL CONNECTIONS.
- PROVIDE NEW LIGHT SWITCH CONDUCTOR IN EXISTING 1" RACEWAY FOR ROW SWITCHING AS NOTED. THE NEW CONDUCTOR SHALL BE RATED WITH THE EXISTING CONDUCTORS TO REMAIN IN PLACE. PROTECT EXISTING CONDUCTORS DURING INSTALLATION.
- PROVIDE NEW SWITCHES IN EXISTING RECESSED SWITCH LOCATION. CUT, PATCH AND PAINT. INSTALL NEW MULTI-GANG SWITCH BOX FOR ADDITIONAL SWITCH IN EXISTING WALLS. UTILIZE EXISTING IN-WALL RACEWAY SYSTEM TO ROUTE NEW CONDUCTORS FOR ROW SWITCHING.
- CONTRACTOR SHALL UTILIZE 2416, #14, 12/2 AND MAKE CONNECTIONS TO EXISTING 277V LIGHTING CIRCUIT IN CLASSROOM.
- PROVIDE EMERGENCY LIGHTING CONTROL UNIT (ELCU) FOR THIS FEATURE. WAITSTOPPER RELAY UNIT REQUIRED UNLESS OTHERWISE NOTED. PROVIDE ELCU IN ADDITION TO EXISTING LIGHTING CIRCUIT. INSTALL IN ROOM ADJACENT TO EXISTING LIGHTING CIRCUIT.

**KEYPLAN**

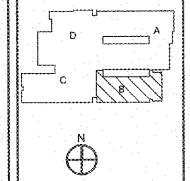

**AH&P**  
CONSULTING ENGINEERS

ANDREWS, HAMMOCK & POWELL, INC.  
250 Chapter Lane  
Suite 100  
Macon, Georgia 31210  
Macon (478) 415-2311  
FAX (478) 415-2310  
WWW.AHPENGR.COM



**Manley Spangler Smith Architects**  
A Professional Corporation

626 East Taylor St.  
P.O. Box 480  
Gwin, Georgia 30224  
Office 770.227.5473  
Fax 770.228.3442

PROJECT:  
RENOVATIONS, MODIFICATIONS, & ADDITIONS TO HENRY COUNTY SCHOOLS - GROUP 10 WOODLAND MIDDLE SCHOOL (ITEM B)

CLIENT:  
HENRY COUNTY BOARD OF EDUCATION

SHEET TITLE:  
ELECTRICAL NEW WORK LIGHTING PLAN - SECTOR "B"

11/15/18  
P.L. 800  
FACILITY CODE: 875-0308  
© 2018 Manley Spangler Smith Architects, PC  
PROJECT NUMBER: 2017318  
DATE: 06.07.18  
SCALE: 1/8"=1'-0"  
DRAWN BY: AJS  
CHECKED BY: NHC  
SHEET NO.: E102

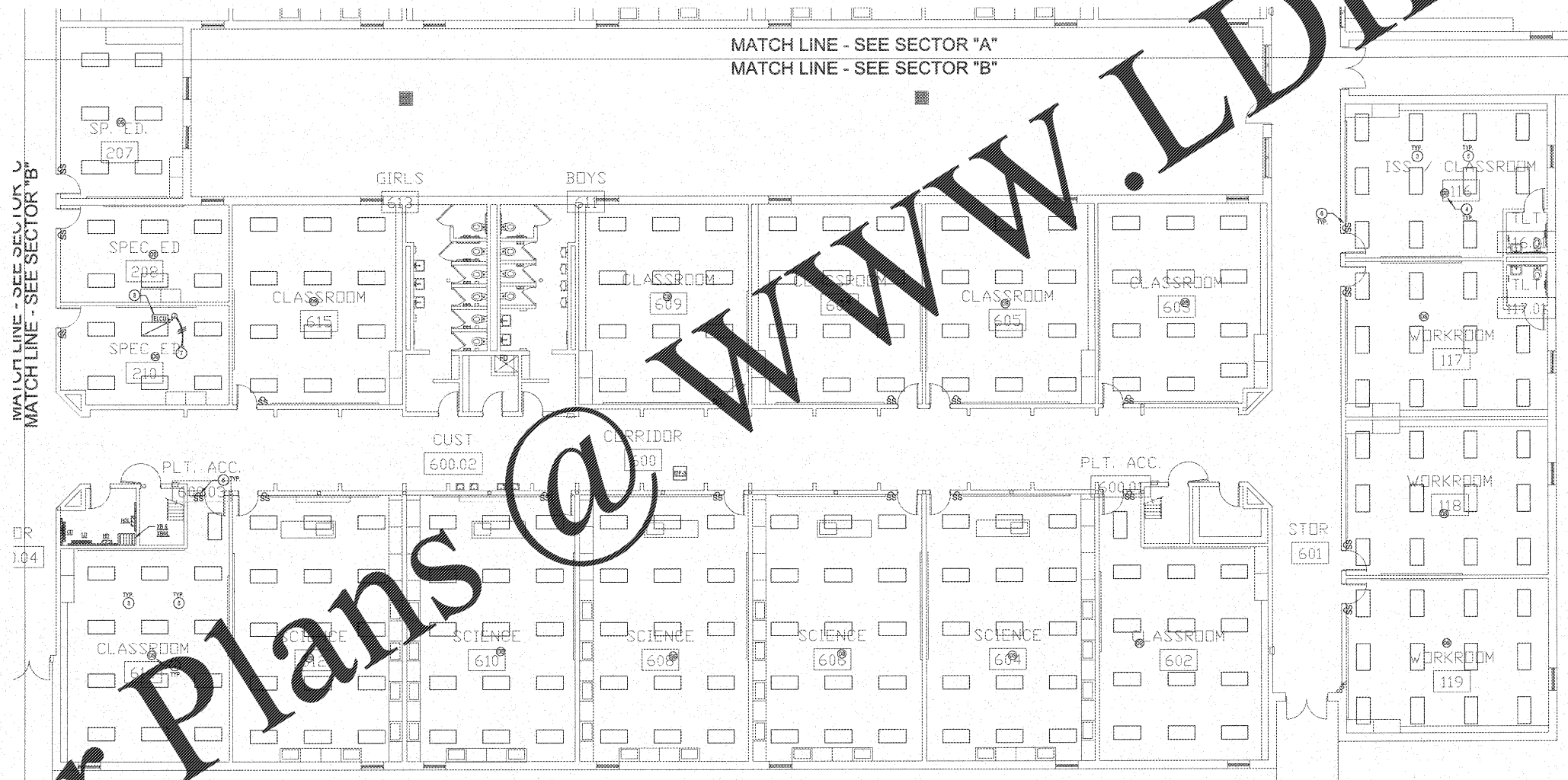

**ELECTRICAL NEW WORK LIGHTING PLAN - SECTOR "B"**  
SCALE: 1/8"=1'-0"

**GENERAL LIGHTING NOTE**

UNDER THIS PROJECT OCCUPANCY SENSORS SHALL BE INSTALLED. EXISTING 277V LIGHTING CIRCUITS WITHIN BUILDING SHALL BE UTILIZED TO POWER EXISTING LIGHTING. SOME AREAS REQUIRE REMOVAL OF LIGHTING CIRCUIT WITHIN SPACES WHILE OTHERS MAY CONNECT DIRECTLY TO EXISTING SWITCHED CIRCUITS. EXISTING CONDUIT AND WIRING MAY BE UTILIZED WHERE IT MEETS THIS SPECIFICATION.

**NOTE TO CONTRACTOR CONCERNING PROJECT PHASING:**

THE WORK SPECIFIED ON THE DRAWINGS AND SPECIFICATIONS ILLUSTRATES THE COMPLETED CONTRACTUAL REQUIREMENTS. THIS PROJECT IS PHASED IN MULTIPLE PHASES. THE AREA OF EACH PHASE IS DESCRIBED IN THE ARCHITECTURAL DOCUMENTS AND THE CONTRACTOR SHALL REVIEW THESE PHASING REQUIREMENTS. CONTRACTOR SHALL INCLUDE IN HIS BID ALL COSTS REQUIRED TO ACCOMPLISH THE CONTRACT IN PHASES. THE CONTRACT DOCUMENTS DO NOT REQUIRE THE SPECIFIC WORK REQUIRED BY THE CONTRACTOR TO PERFORM THE PROJECT IN PHASES, BUT CONTRACTOR SHALL PREPARE PHASING PLAN AND SUBMIT TO ARCHITECT/ENGINEER AND HENRY COUNTY MAINTENANCE DEPARTMENT PRIOR TO BEGINNING WORK.

Order Plans @ [www.LDLine.com](http://www.LDLine.com)