

PLAN LEGEND	
M.B. T.B.	MARKER BOARD OR TACKBOARD
	ELEVATION MARKER

SEE SHEET A1.22 FOR PARTITION TYPE SCHEDULE, GENERAL NOTES AND PLAN KEY NOTES

REVISIONS/ISSUANCES		
NO.	DATE	DESCRIPTION

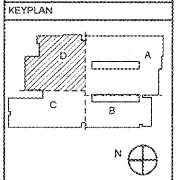

Manley Spangler Smith Architects
A Professional Corporation

625 East Taylor St.
P.O. Box 900
Guthrie, Georgia 30224
Office 770.227.5473
Fax 770.228.3442

PROJECT:
RENOVATIONS, MODIFICATIONS, & ADDITIONS TO HENRY COUNTY SCHOOLS - GROUP 10 WOODLAND MIDDLE SCHOOL (ITEM B)
CLIENT:
HENRY COUNTY BOARD OF EDUCATION

SHEET TITLE:
FLOOR PLAN - SECTORS "D"

1/1 SS
F.T.E. - 887
FACILITY CODE: 675-0308
© 2018 Manley Spangler Smith Architects, PC
PROJECT NUMBER: 2017318
DATE: 06/07/18
SCALE: AS NOTED
DRAWN BY: JS
CHECKED BY: RV

SHEET NO.:
A1.24

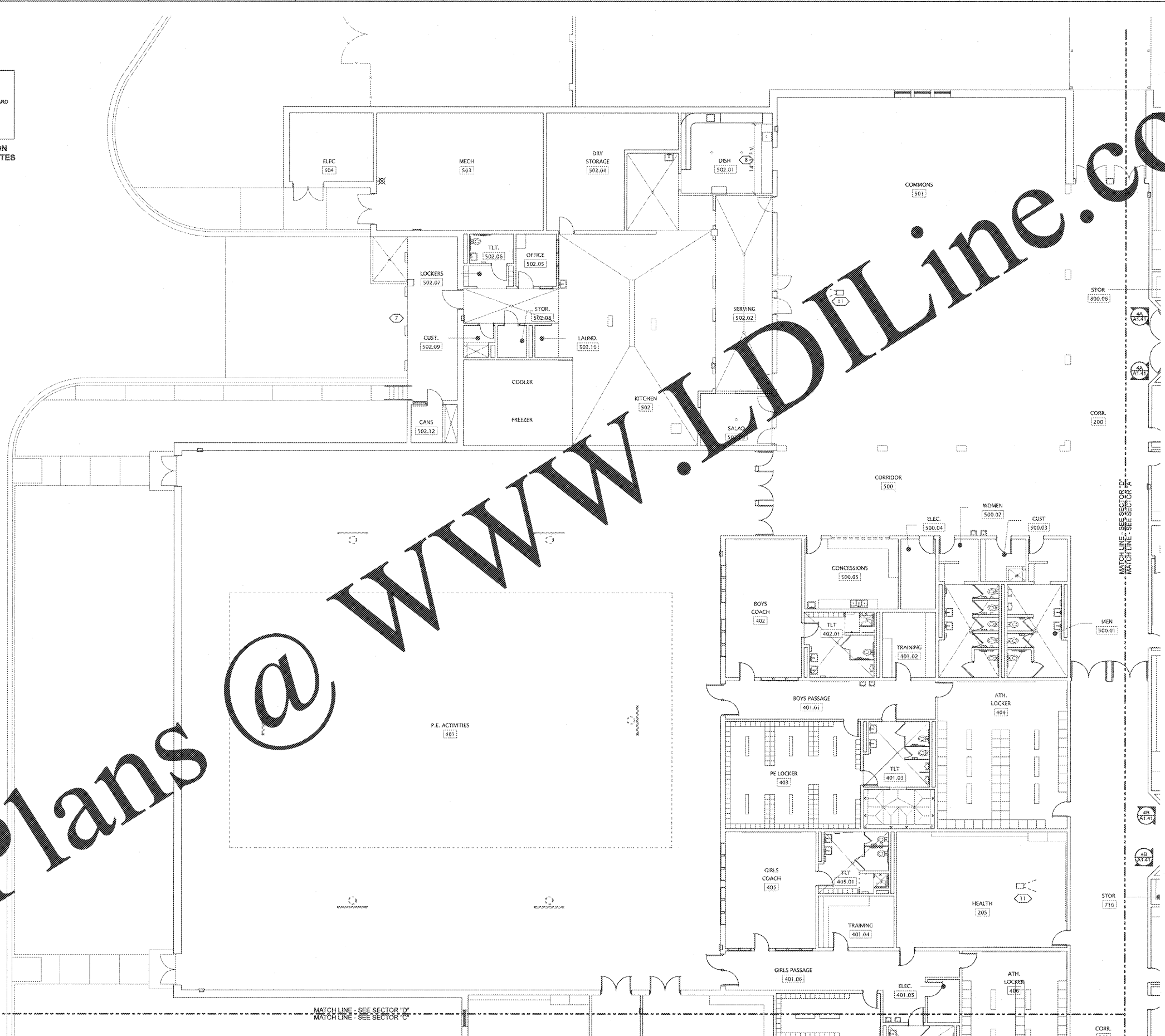

FLOOR PLAN - SECTOR "D"
SCALE: 1/8" = 1'-0"

Order Plans @

www.LDLine.com