

REVISIONS/ISSUANCES		
NO.	DATE	DESCRIPTION

KEYPLAN	

Manley Spangler Smith Architects A Professional Corporation	
825 East Taylor St. P.O. Box 880 Griffin, Georgia 30204 Office 770.227.5473 Fax 770.228.3442	
PROJECT: RENOVATIONS, MODIFICATIONS, & ADDITIONS TO HENRY COUNTY SCHOOLS - GROUP 10 WOODLAND MIDDLE SCHOOL (ITEM B)	
CLIENT: HENRY COUNTY BOARD OF EDUCATION	
SHEET TITLE: FLOOR PLAN - SECTOR "A"	
LU : 65 F.T.E. : 887 FACILITY CODE: 675-0308 © 2018 Manley Spangler Smith Architects, PC PROJECT NUMBER: 2017318 DATE: 06.07.18 SCALE: AS NOTED DRAWN BY: JS CHECKED BY: RV	
SHEET NO.: A1.21	

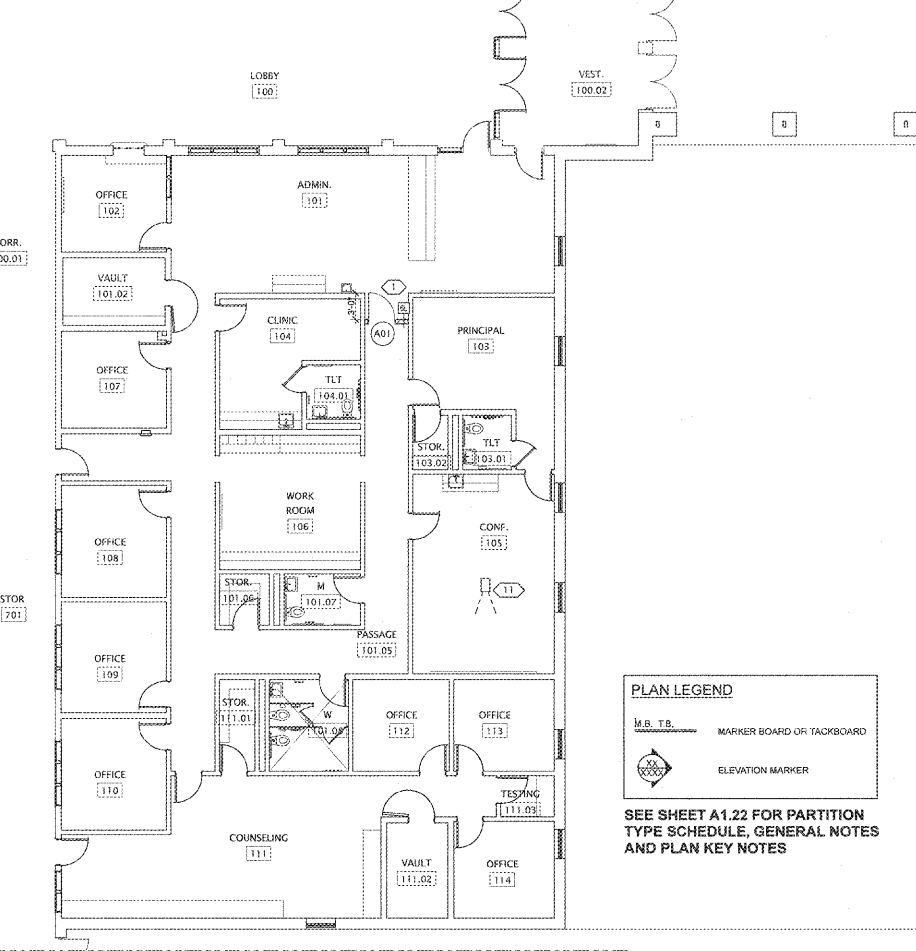
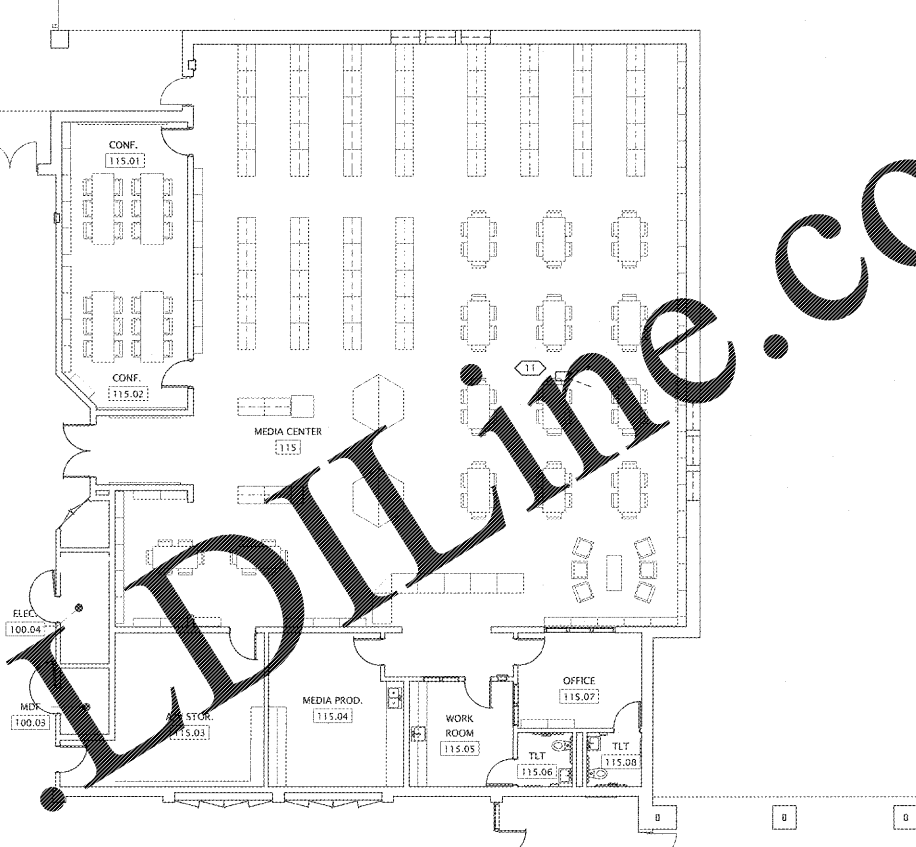

PLAN LEGEND

M.B. T.B. MARKER BOARD OR TACKBOARD

ELEVATION MARKER

SEE SHEET A1.22 FOR PARTITION TYPE SCHEDULE, GENERAL NOTES AND PLAN KEY NOTES

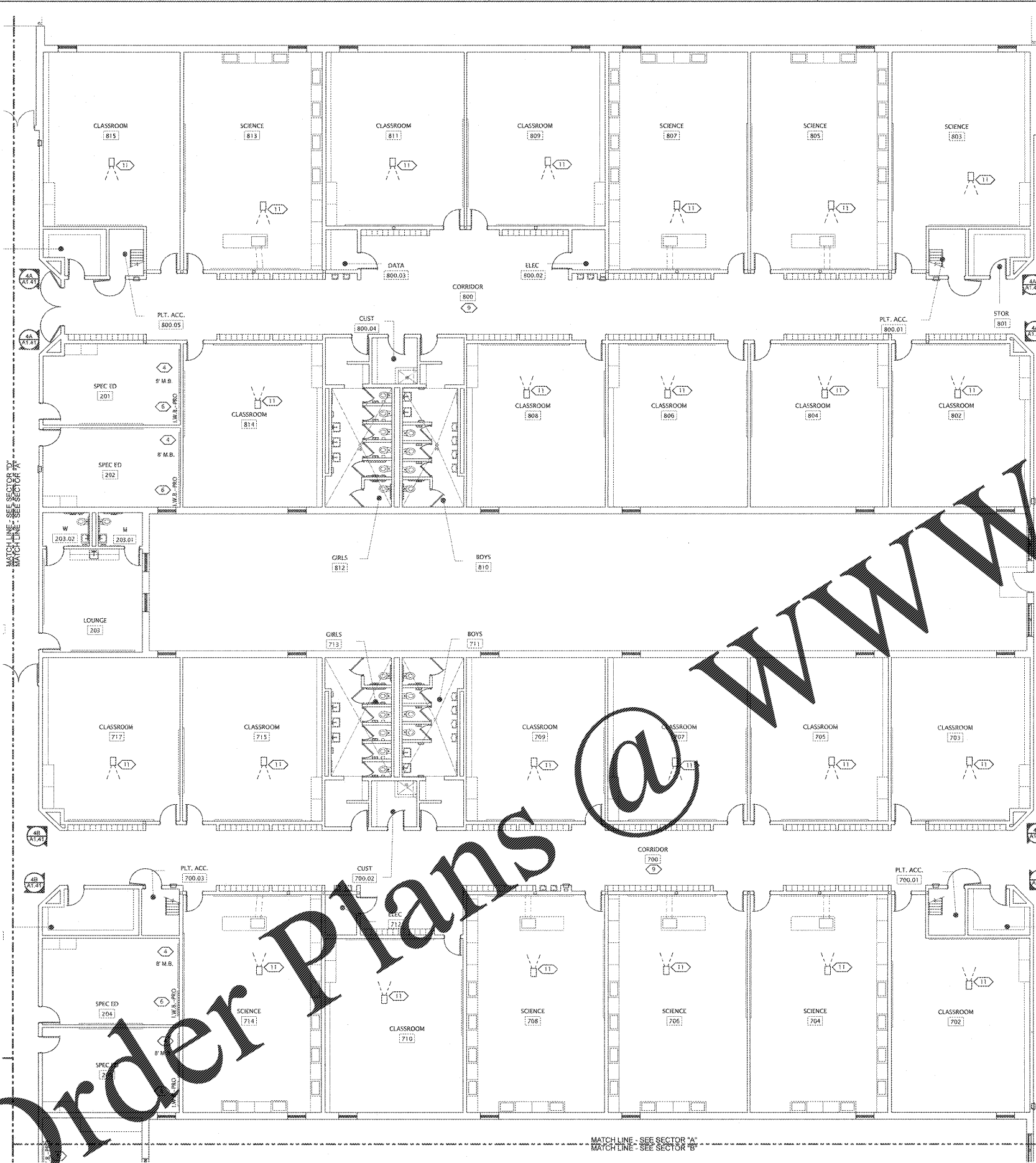

FLOOR PLAN - SECTOR "A"
A1.21 SCALE: 1/8" = 1'-0"

Order Plans @

WWW

LDIline.com