

DEMOLITION PLAN LEGEND
 [Solid Line] EXISTING CONSTRUCTION TO REMAIN
 [Dashed Line] EXISTING CONSTRUCTION TO BE DEMOLISHED

DEMOLITION GENERAL NOTES

- ANY EXISTING CEILING SYSTEM COMPONENTS, TO REMAIN, THAT ARE REMOVED OR DAMAGED WHILE COMPLETING OTHER TRADES WORK IS THE SOLE RESPONSIBILITY OF THE GENERAL CONTRACTOR TO REPAIR.
- REFER TO MECHANICAL, ELECTRICAL & PLUMBING DEMOLITION PLANS FOR ADDITIONAL DEMOLITION WORK.
- REMOVE ALL TV AND TV BRACKETS. SALVAGE FLAT SCREEN TV'S ONLY AND RETURN TO OWNER. PROPERLY DISPOSE OF CRT TV'S AND TV BRACKETS. IF THE ADMIN. AREA AND/OR COMMONS CONTAINS A FLAT SCREEN TV, THE TV AND BRACKET SHALL REMAIN. CONTRACTOR SHALL VISIT THE SITE AND VERIFY ALL TV AND TV BRACKET QUANTITIES.
- REMOVE RESTROOM ACCESSORIES WHERE INDICATED.
- REMOVE AND/OR REPLACE MILLWORK WHERE INDICATED.
- CONTRACTOR SHALL PROVIDE OWNER FIRST CHOICE IN RETAINING ALL THE FOLLOWING ITEMS BUT NOT LIMITED TO: MILLWORK, CASEWORK, DOORS, DOOR HARDWARE, MB, TB, CB ETC. (IF NOTED TO BE REMOVED)
- CONTRACTOR SHALL BE RESPONSIBLE FOR THE PROTECTION OF EXISTING COMPUTER DATA OUTLETS AND ALL ASSOCIATED RECEPTACLES & WIRE MOULD DURING DEMOLITION AND RENOVATIONS OF ALL SPACES. ALL ASSOCIATED ITEMS DAMAGED, SHALL BE REPLACED AT NO COST TO THE OWNER.
- INFORMATION SHOWN ON THE DEMOLITION DRAWINGS IS TO BE USED AS A GUIDE TO GENERALLY OUTLINE THE SCOPE OF DEMOLITION INVOLVED IN THIS PROJECT. THIS INFORMATION SHOULD IN NO WAY BE CONSIDERED TO BE INCLUSIVE. FAILURE TO INDICATE DEMOLITION WHICH IS REQUIRED BY OTHER WORK CALLED FOR IN THE CONTRACT DOCUMENTS SHALL NOT RELIEVE THE CONTRACTOR FROM THE OBLIGATION OF PROVIDING REQUIRED DEMOLITION AT NO ADDITIONAL COST TO THE OWNER.
- WHERE ANY DEMOLITION/REMOVAL OCCURS, CONTRACTOR SHALL PATCH/RESTORE REMAINING SURFACES (IE FLOORS, WALLS, CEILING ETC.) TO MATCH ADJACENT AREAS WITHOUT DISTORTION. ALL SPACES REQUIRING REMOVAL OF EXISTING RADICATORS, VENT COVERS & ELECTRICAL DEVICES, BUT NOT LIMITED TO SHALL REQUIRE NEW TOOTHED IN CMU TO RESTORE INTEGRITY AND APPEARANCE OF EXISTING WALLS. CONTRACTOR SHALL PATCH SMALLER HOLES OR OTHER BLEMISHES WITH GROUT. PREPARE NEW CMU AND EXISTING CMU FOR NEW PAINT AS SCHEDULED.
- CONTRACTOR SHALL PROPERLY DISPOSE OF ALL ITEMS THE OWNER CHOOSES NOT TO SALVAGE.
- NO ASBESTOS IS EXPECTED TO BE ENCOUNTERED. IF ASBESTOS IS ENCOUNTERED, STOP WORK AND NOTIFY THE OWNER IMMEDIATELY.

DEMOLITION PLAN KEY NOTES (XX) ← PLAN KEY NOTE NUMBER

- REMOVE EXISTING PULPER AND SECTION OF SOILED DISH TABLE BACK TO DISHWASHER.
- REMOVE EXISTING CASEWORK AND REMOVE THE EXISTING LECTURE SEATING PLATFORM IN ITS ENTIRETY. PREPARE FLOOR FOR NEW FLOOR FINISH. THE POWER AND DATA OUTLETS ALREADY LOCATED IN FLOOR ARE TO REMAIN.
- NOT USED.
- REMOVE EXISTING MARKER BOARD AND/OR TACK BOARD.
- REMOVE EXISTING COMPUTER COUNTER MILLWORK.
- REMOVE DAMAGED BRICK ABOVE AND EXISTING DOCK BUMPERS. PREP AREA FOR INSTALLATION OF NEW DOCK BUMPERS AND EXTENSIONS AND NEW BRICK TO BE TOOTHED IN ABOVE.

- REMOVE EXISTING VCT, RESINOUS FLOORING, AND/OR CARPET FLOOR FINISH AND BASE. PREPARE EXISTING SUBSTRATE FOR NEW FLOOR FINISH AND BASE AS SCHEDULED.

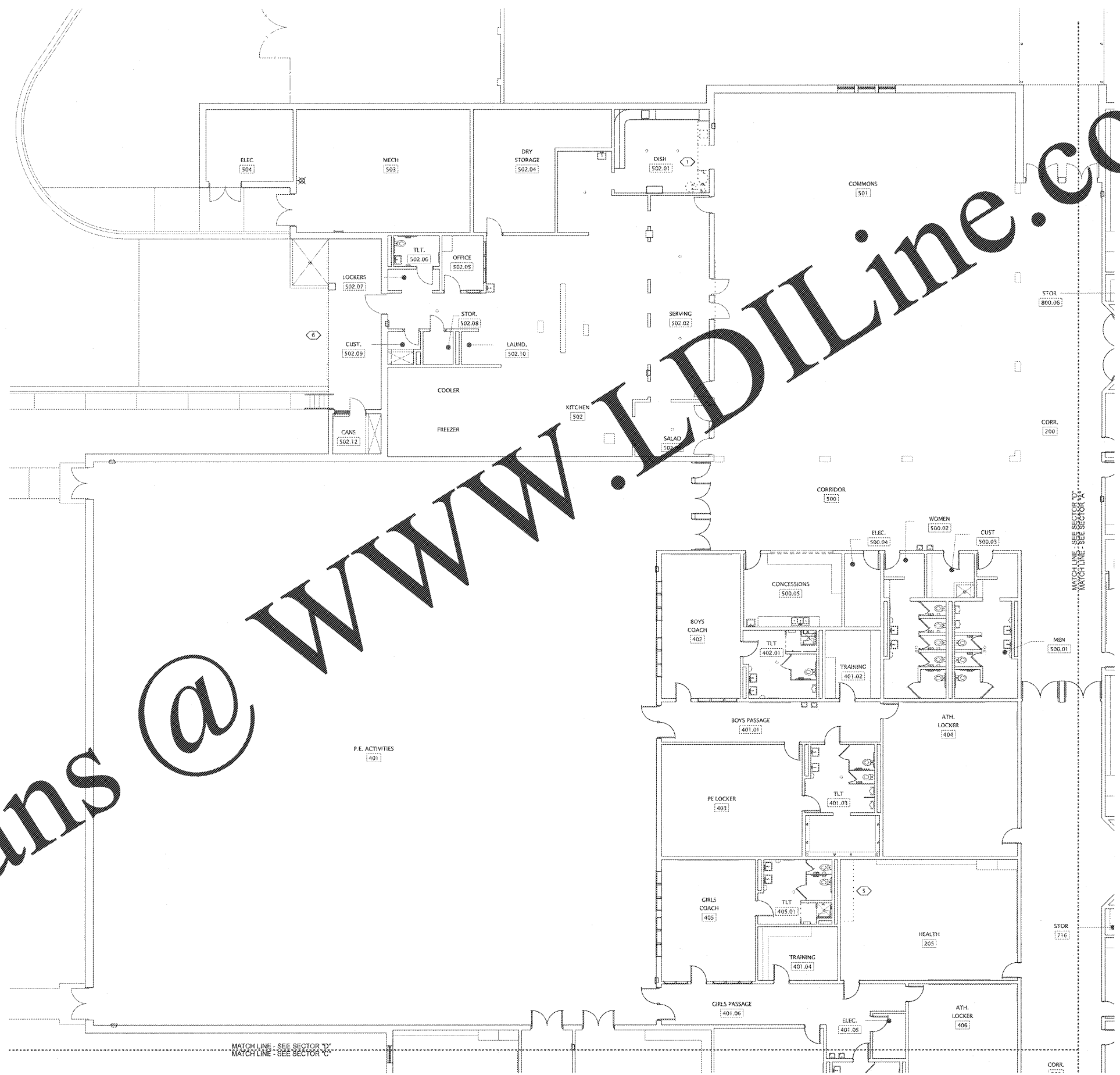

REVISIONS/ISSUANCES		
NO.	DATE	DESCRIPTION

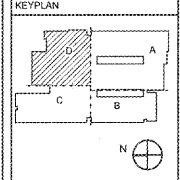

Manley Spangler Smith Architects
 A Professional Corporation

525 East Taylor St.
 P.O. Box 880
 Griffin, Georgia 30224
 Office 770.227.5473
 Fax 770.228.3442

PROJECT:
 RENOVATIONS, MODIFICATIONS, & ADDITIONS TO HENRY COUNTY SCHOOLS - GROUP 10 WOODLAND MIDDLE SCHOOL (ITEM B)
 CLIENT:
 HENRY COUNTY BOARD OF EDUCATION
 SHEET TITLE:
 DEMOLITION PLAN - SECTOR "D"

1/11/18
 F.T.E.: 887
 FACILITY CODE: 675-0308
 © 2018 Manley Spangler Smith Architects, PC
 PROJECT NUMBER: 201731B
 DATE: 08.07.18
 SCALE: AS NOTED
 DRAWN BY: JS
 CHECKED BY: RV

SHEET NO.: **D1.24**

DEMOLITION PLAN - SECTOR "D"
 SCALE: 1/8" = 1'-0"

Order Plans @