

NOTE:
ALL NECESSARY SYSTEM SHALL BE BY DIVISION 26
AND ALL WIRING, CHANGING CONNECTORS,
WALL PLATES AND ETC. SHALL BE BY LOW VOLTAGE
AND METRIC CONTRACTORS.

TYPICAL CLASSROOM MULTIMEDIA EQUIPMENT AND INSTALLATION DIAGRAM
SCALE: NONE

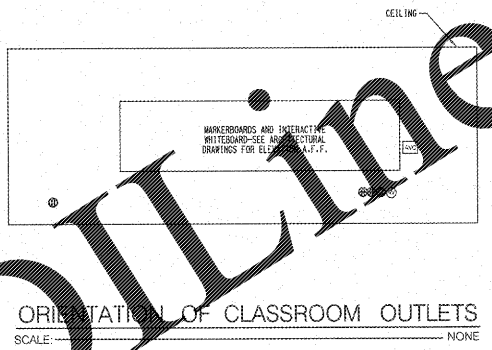

| REVISIONS/ISSUANCES | | |
|---------------------|------|-------------|
| NO. | DATE | DESCRIPTION |
| | | |
| | | |
| | | |

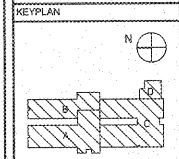

AH&P
CONSULTING
ENGINEERS

ANDREWS, HAMMOCK & POWELL, INC.
250 Charter Lane
Suite 100
Macon, Georgia 31210
Macon (478) 405-8391
FAX (478) 405-8210
WWW.AHPENR.COM



Manley Spangler Smith Architects
A Professional Corporation

325 East Taylor St.
P.O. Box 880
Griffin, Georgia 30224
Office 770.227.5473
Fax 770.228.3442

PROJECT:
RENOVATIONS,
MODIFICATIONS, &
ADDITIONS TO HENRY
COUNTY SCHOOLS -
GROUP 10
WOODLAND ELEMENTARY
SCHOOL (ITEM A)

CLIENT:
HENRY COUNTY
BOARD OF EDUCATION

SHEET TITLE:
ELECTRICAL DETAILS

L.U. - 55
P.T.E. - 675
FACILITY CODE: 875-0108
© 2018 Manley Spangler Smith Architects, PC
PROJECT NUMBER: 2017031A
DATE: 06.07.18
SCALE: NONE
DRAWN BY: CTS
CHECKED BY: RPO

SHEET NO.: E601

Order Plans @ www.LDILine.com