

NOTE TO CONTRACTOR CONCERNING PROJECT PHASING:
 THE WORK SPECIFIED ON THE DRAWINGS AND SPECIFICATIONS ILLUSTRATED IS TO BE COMPLETED IN PHASES. THE PROJECT IS PHASED IN MULTIPLE PHASES. THE AREA OF EACH PHASE IS DESCRIBED IN THE ARCHITECTURAL DOCUMENTS AND THE CONTRACTOR SHALL REVIEW THESE PHASING REQUIREMENTS. CONTRACTOR SHALL INCURE BY ALL COSTS REQUIRED TO ACCOMPLISH THE CONTRACT IN PHASES. THE CONTRACT DOCUMENTS DO NOT DESCRIBE THE SEQUENCE WORK REQUIRED BY THE CONTRACTOR TO PERFORM THE PROJECT IN PHASES. BUT CONTRACTOR SHALL PREPARE PHASING PLAN AND SUBMIT TO ARCHITECT/ENGINEER AND HENRY COUNTY MAINTENANCE DEPARTMENT PRIOR TO BEGINNING WORK.

GENERAL NOTES

1. CONTRACTOR SHALL ROUTE VOICE, DATA AND INTERCOM SYSTEMS IN CONDUIT FROM WALL OUTLET TO ABOVE CORRIDOR CEILING. CABLEING SHALL THEN BE ROUTED VIA LUNCHES TO DESTINATION. JUNCTIONS SHALL BE INSTALLED ON BOTH SIDES OF CORRIDORS ON 4' CENTERS.
2. ALL LOW VOLTAGE SYSTEMS INSTALLED OUTSIDE OF BUILDING SHALL HAVE LIGHTNING PROTECTION APPLIED TO CUPPER CABLEING AS IT ENTERS THE BUILDING.
3. ELECTRICAL INSTALLATIONS ON EXISTING WALLS SHALL HAVE CRACKS INSTALLED CONCEALED WITH MASONRY. CONTRACTOR SHALL NOT, UNDER ANY CIRCUMSTANCE, USE SURFACE METAL RACEWAYS TO INSTALL NEW DEVICES. BOXES SHALL BE SET INTO EXISTING MASONRY WITH FLEX CONDUIT FISHED IN EXISTING WALL FROM ABOVE ACCESSIBLE CEILING.

REVISIONS/ISSUANCES		
NO.	DATE	DESCRIPTION

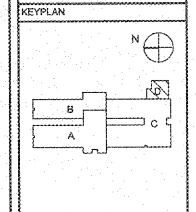

AH&P
 CONSULTING ENGINEERS
 ANDREWS, HAMMOCK & POWELL, INC.
 255 Charter Lane
 Suite 100
 MACON, GEORGIA 31210
 MACON (478) 405-8801
 FAX (478) 405-8210
 WWW.AHPENGR.COM



Manley Spangler Smith Architects
 A Professional Corporation

525 East Taylor St.
 P.O. Box 850
 Griffin, Georgia 30224
 Office 770.227.5473
 Fax 770.228.3442

PROJECT:
 RENOVATIONS, MODIFICATIONS, & ADDITIONS TO HENRY COUNTY SCHOOLS - GROUP 10 WOODLAND ELEMENTARY SCHOOL (ITEM A)
 CLIENT:
 HENRY COUNTY BOARD OF EDUCATION
 SHEET TITLE:
 ELECTRICAL NEW WORK LOW VOLTAGE PLAN - SECTOR 'D'

11/15/18
 P.T.E. - 875
 FACILITY CODE: 875-0108
 © 2018 Manley Spangler Smith Architects, PC
 PROJECT NUMBER: 201731A
 DATE: 06.07.18
 SCALE: 1/8"=1'-0"
 DRAWN BY: A.S.
 CHECKED BY: N.S.
 SHEET NO.: E304

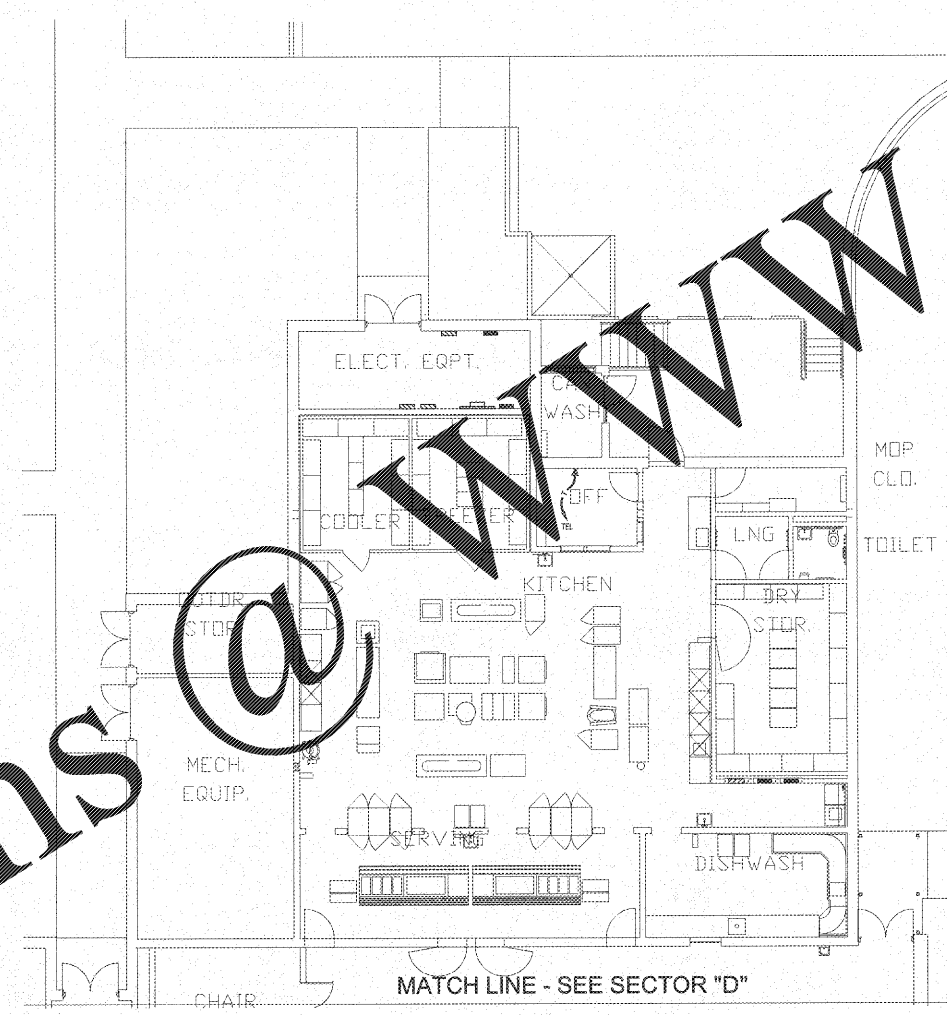

ELECTRICAL NEW WORK LOW VOLTAGE PLAN - SECTOR 'D'
 SCALE: 1/8"=1'-0"

Order Plans @

WWW.LDILine.com