

REVISIONS/ISSUANCES		
NO.	DATE	DESCRIPTION

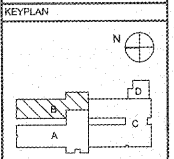

AH&P
CONSULTING
ENGINEERS
ANDREWS, HAMMOCK & POWELL, INC.
250 Charter Lane
Suite 100
Macon, Georgia 31210
FAX (478) 405-8301
WWW.AHPENGR.COM



Manley Spangler Smith Architects
A Professional Corporation

525 East Taylor St.
P.O. Box 863
Giffin, Georgia 30224
Office 770.227.5473
Fax 770.228.3442

PROJECT:
RENOVATIONS,
MODIFICATIONS, &
ADDITIONS TO HENRY
COUNTY SCHOOLS -
GROUP 16
WOODLAND ELEMENTARY
SCHOOL (ITEM A)

CLIENT:
HENRY COUNTY
BOARD OF EDUCATION

SHEET TITLE:
ELECTRICAL NEW WORK
LOW VOLTAGE PLAN -
SECTOR 'B'

LU: AS
F.Y.E.: BPS
FACILITY CODE: 675-6108
© 2018 Manley Spangler Smith Architects, PC
PROJECT NUMBER: 201721A
DATE: 06.07.18
SCALE: 1/8"=1'-0"
DRAWN BY: ASJ
CHECKED BY: NHO

SHEET NO. E302

NOTE TO CONTRACTOR CONCERNING PROJECT PHASING:
THE WORK SPECIFIED ON THE DRAWINGS AND SPECIFICATIONS ILLUSTRATES THE COMPLETE CONTRACTOR REQUIREMENTS. THIS PROJECT IS PHASED IN MULTIPLE PHASES. THE AREA OF EACH PHASE IS DESCRIBED IN THE ARCHITECTURAL DOCUMENTS AND THE CONTRACTOR SHALL REVIEW THESE PHASING REQUIREMENTS. CONTRACTOR SHALL INCLUDE PHASE BID ALL COSTS REQUIRED TO ACCOMPLISH THE CONTRACT PHASES. THE CONTRACT DOCUMENTS DO NOT DESCRIBE THE SPECIFIC WORK REQUIRED BY THE CONTRACTOR TO PHASING THE PROJECT. IN PHASE 1, CONTRACTOR SHALL PREPARE PHASING PLAN AND SUBMIT TO ARCHITECT, ENGINEER AND HENRY COUNTY MAINTENANCE DEPARTMENT PRIOR TO BEGINNING WORK.

GENERAL NOTES

- CONTRACTOR SHALL ROUTE VOICE, DATA AND INTERCOM SYSTEMS IN CONCORD WITH WALL OUTLET TO ABOVE CONDUIT CLOSURES. CABLES SHALL THEN BE ROUTED VIA JUNCTIONS TO DESTINATION. JUNCTIONS SHALL BE INSTALLED ON BOTH SIDES OF CONDUITS ON 4" SYSTEMS.
- ALL LOW VOLTAGE SYSTEMS ROUTED OUTSIDE OF BUILDING SHALL HAVE LIGHTNING PROTECTION APPLIED TO COPPER CABLES AS IT ENTERS THE BUILDING.
- ELECTRICAL INSTALLATIONS ON EXISTING WALLS SHALL HAVE CHASES INSTALLED CONSIDERED WITHIN MASONRY. CONTRACTOR SHALL NOT UNDER ANY CIRCUMSTANCES UTILIZE SURFACE METAL RACEWAY TO INSTALL NEW DEVICES. BOXES SHALL BE CUT INTO EXISTING MASONRY WITH FLAT CONDUIT FINISH IN EXISTING WALL FROM ABOVE ACCESSIBLE CEILING.

NOTES: (THIS SHEET ONLY)

- PROVIDE AUDIO VISUAL CONNECTIVITY AND COMPONENTS, SEE DETAIL.
- PROVIDE AUDIO VISUAL CONTROLLER PER DETAIL AND SPECIFICATIONS.
- LOW VOLTAGE CABLES SHALL BE JAMHOOKED THRU CORRIDOR TO ASSIGNED RFP MOP. PROVIDE LABEL, JUNCTION BOXES MUST BE FOUR FEET ON CENTER THRU CORRIDORS TYPICAL.
- PROVIDE WALL BRACKET MOUNTED INTERACTIVE WHITEBOARD WITH ARM MOUNTED SHORT THROW PROJECTOR FOR THIS CLASSROOM AS SPECIFIED.

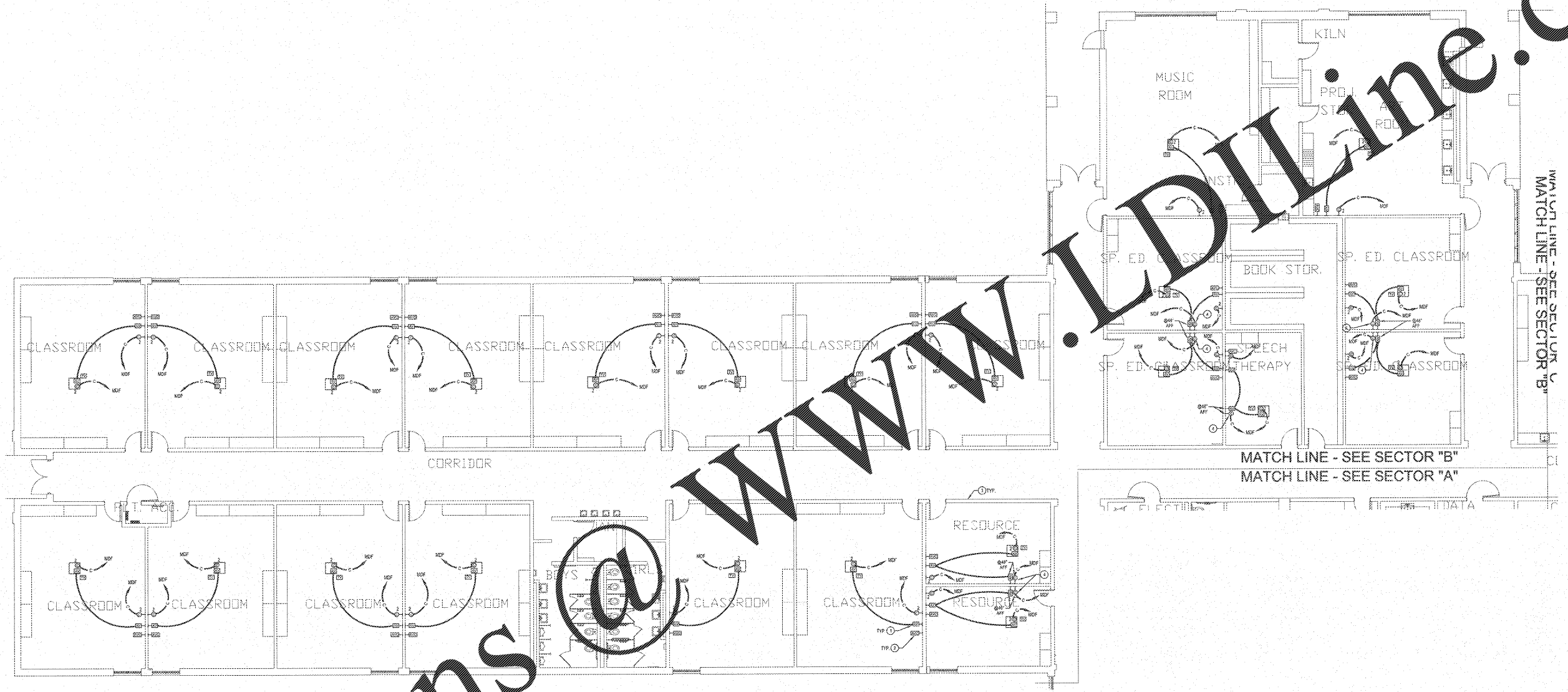

ELECTRICAL NEW WORK LOW VOLTAGE PLAN - SECTOR 'B'
SCALE: 1/8"=1'-0"

Order Plans

WWW.LDOnline.com