

Order Plans @ www.wldline.com

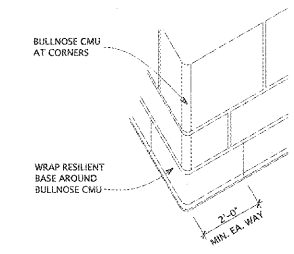

1 PLAN DETAIL
SCALE: 3/4" = 1'-0"

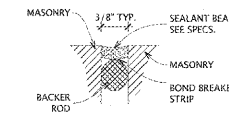

2 PLAN DETAIL
SCALE: 3/4" = 1'-0"

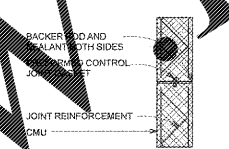

3 PLAN DETAIL
SCALE: 3/4" = 1'-0"

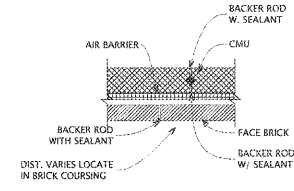

4 PLAN DETAIL
SCALE: 3/4" = 1'-0"

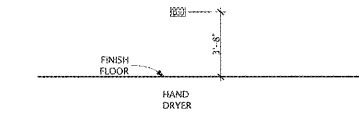

5 TYP. TOILET ACCESSORY MTG HGTS
SCALE: 1/4" = 1'-0"

NOTES
1. ALL MARKER BOARDS AND TACK BOARDS SHALL BE GLUED WITH DOBS TO THE CONCRETE BLOCK SUBSTRATE. SEE SPECIFICATIONS FOR ADDITIONAL INFORMATION.

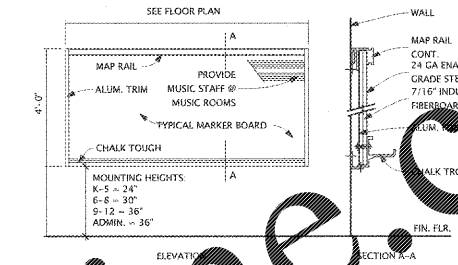

6 TYP. MARKER BOARD
SCALE: 3/4" = 1'-0"

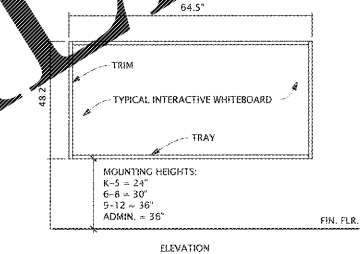

7 TYP. INTERACTIVE WHITEBOARD
SCALE: 3/4" = 1'-0"

TOILET ACCESSORY LEGEND:	
ITEM	DESCRIPTION
5	HAND DRYER

NOTE: ONLY ITEMS THAT ARE LABELED ARE NEW ITEMS.

REVISIONS/ISSUANCES		
NO.	DATE	DESCRIPTION

KEYPLAN

STATE OF GEORGIA
REGISTERED ARCHITECT

Manley Spangler Smith Architects
A Professional Corporation

525 East Taylor St.
P.O. Box 800
Griffin, Georgia 30224
Office 770.227.5473
Fax 770.228.3442

PROJECT:
RENOVATIONS, MODIFICATIONS, & ADDITIONS TO HENRY COUNTY SCHOOLS - GROUP 19
WOODLAND ELEMENTARY SCHOOL (ITEM A)
CLIENT:
HENRY COUNTY BOARD OF EDUCATION

SHEET TITLE:
MISCELLANEOUS PLAN DETAILS

10 - 07
PTE - 07
PROJECT CODE: 019-0108
© 2018 Manley Spangler Smith Architects, PC
PROJECT NUMBER: 201731A
DATE: 08.07.18
SCALE: AS NOTED
DRAWN BY: JS
CHECKED BY: RV

SHEET NO.: **A1.41**