

| REVISIONS/ISSUANCES | | |
|---------------------|------|-------------|
| NO. | DATE | DESCRIPTION |
| | | |
| | | |
| | | |

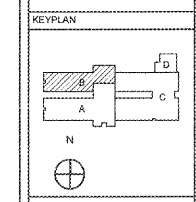

Manley Spangler Smith Architects
A Professional Corporation

525 East Taylor St.
P.O. Box 880
Guthrie, Georgia 30224
Office 770.227.5473
Fax 770.228.3442

PROJECT:
RENOVATIONS,
MODIFICATIONS, &
ADDITIONS TO HENRY
COUNTY SCHOOLS -
GROUP 19
WOODLAND ELEMENTARY
SCHOOL (ITEM A)
CLIENT:
HENRY COUNTY BOARD
OF EDUCATION

SHEET TITLE:
DEMOLITION PLAN -
SECTOR "B"

DATE: 08/17/18
SCALE: AS NOTED
DRAWN BY: JS
CHECKED BY: RV

SHEET NO.:
D1.22

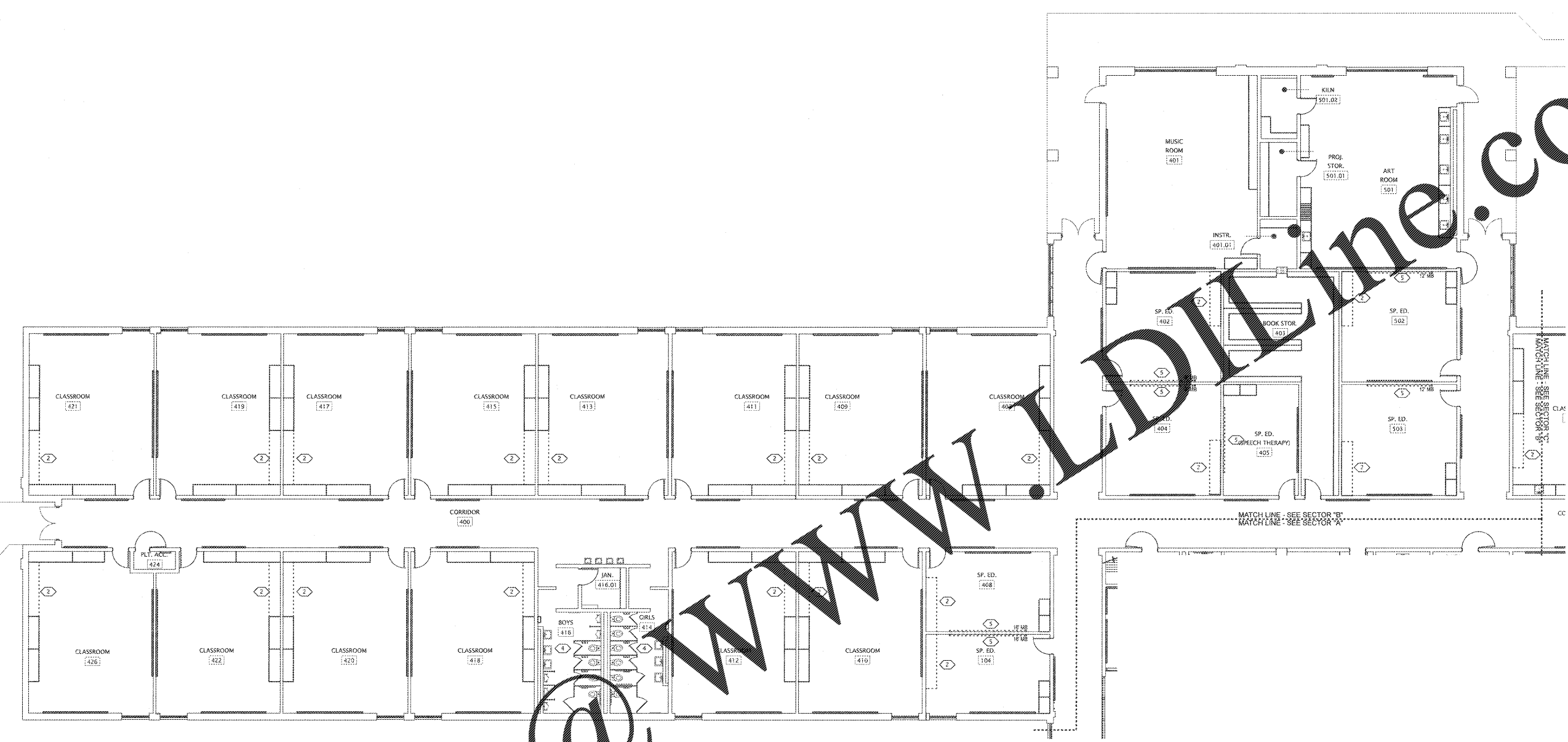

1 DEMOLITION PLAN - SECTOR "B"
SCALE: 1/8" = 1'-0"

| DEMOLITION PLAN LEGEND | |
|------------------------|--|
| | EXISTING CONSTRUCTION TO REMAIN |
| | EXISTING CONSTRUCTION TO BE DEMOLISHED |

SEE SHEET D1.21 FOR DEMOLITION
GENERAL NOTES AND PLAN KEY NOTES

Order Plans @

WWW.LDLINE.COM