

Order Plans @

**1 PLUMBING PLAN**  
P102 1/4" = 1' - 0"

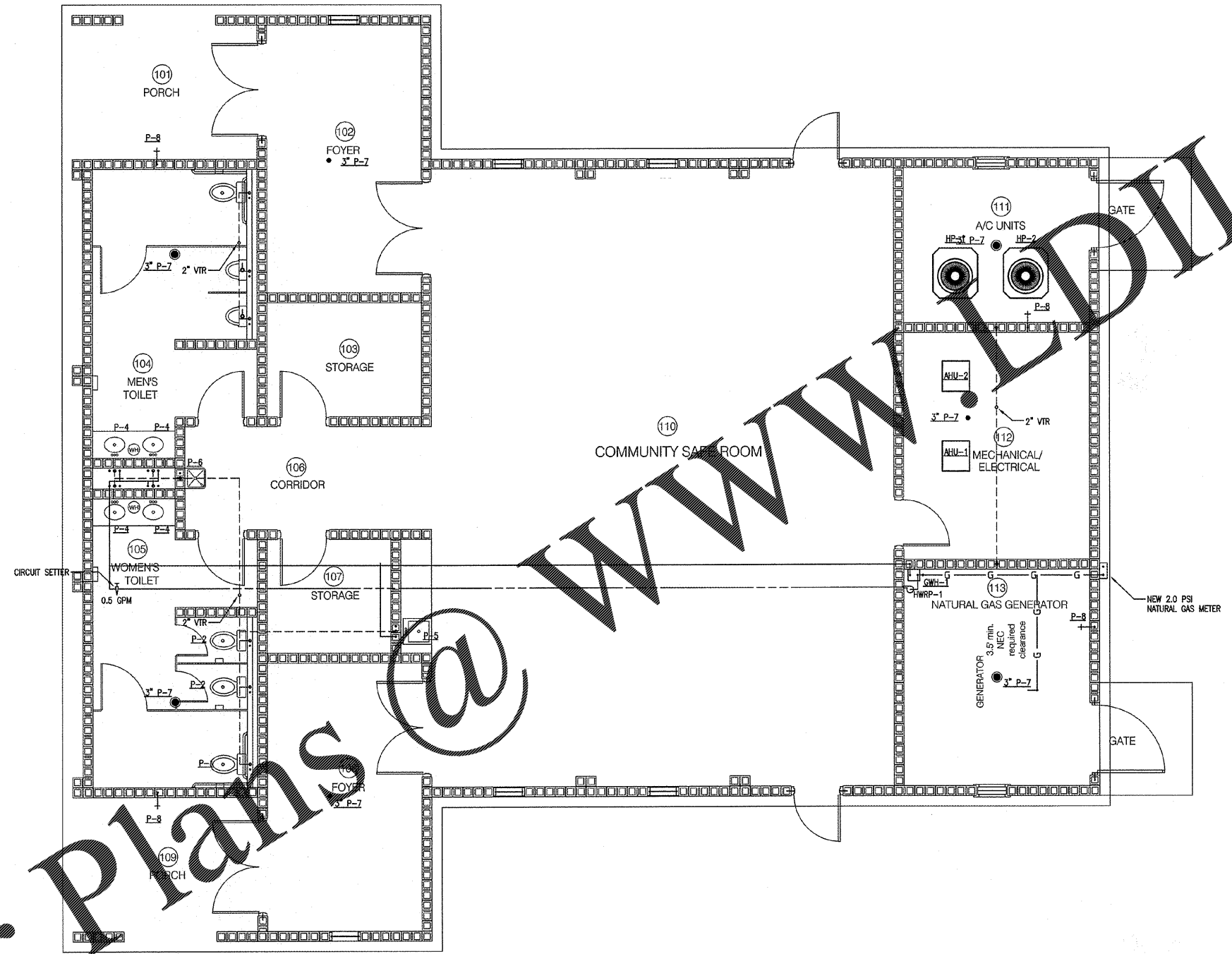

WWW.LDOnline.com

**SENTTELL**  
ENGINEERING  
CIVIL · STRUCTURAL · ENVIRONMENTAL · SURVEYING  
639 Black Bears Way, Phone (205) 752-5664  
Tuscaloosa, AL 35401  
www.senttel.net

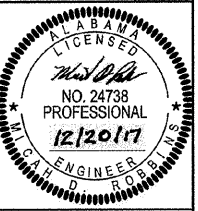

**JEFFERSON COUNTY**  
FULLTONDALE STORM SHELTER  
FULLTONDALE, ALABAMA

|               |              |
|---------------|--------------|
| NO.           | DESCRIPTION: |
| DATE:         |              |
| PLUMBING PLAN |              |
| DATE:         | 12-20-17     |
| JOB NO.:      | 15-211       |
| SHEET:        | P102         |

**ROBBINS**  
Engineering  
Company, LLC  
Mechanical & Electrical  
5945 Knight Ave, Suite B, Tuscaloosa, Alabama 35405  
Phone: (205) 591-7055  
http://www.ro-engineers.com  
REC Proj#18 17016

VERIFY SCALES  
AND IS ONE INCH  
ON THIS SHEET  
ADJUST SCALE  
ACCORDINGLY