

Owner
SBLM PROPERTIES
307 Fellowship Road, Suite 116
Mount Laurel, NJ 08054
Telephone (856) 780-4460
Fax

Architect
SBLM Architects
11430 N. Kendall Drive, Suite 310
Miami, FL 33176
Telephone 305 412 9187
Fax 305 412 6731
www.sblm.com

Consultants
Civil
Langan Engineering
Structural
Bliss & Nytray, Inc.
Electrical/Mechanical/Plumbing
B&K Engineering Group

Revisions/Issues
06/21/18 PERMIT SET

Key Plan

Seal

James L. Cohen AR0015903
Project Title
SOUTHERN PALM CROSSING
BUILDING SHELL
11001-11161 Southern Blvd.
Royal Palm Beach, FL 33411

Job Number 017512.00
Drawing
PLUMBING PLAN

Scale AS SHOWN
Drawing Date 05/16/18

Drawing No.

P1.1

Sheet 0f

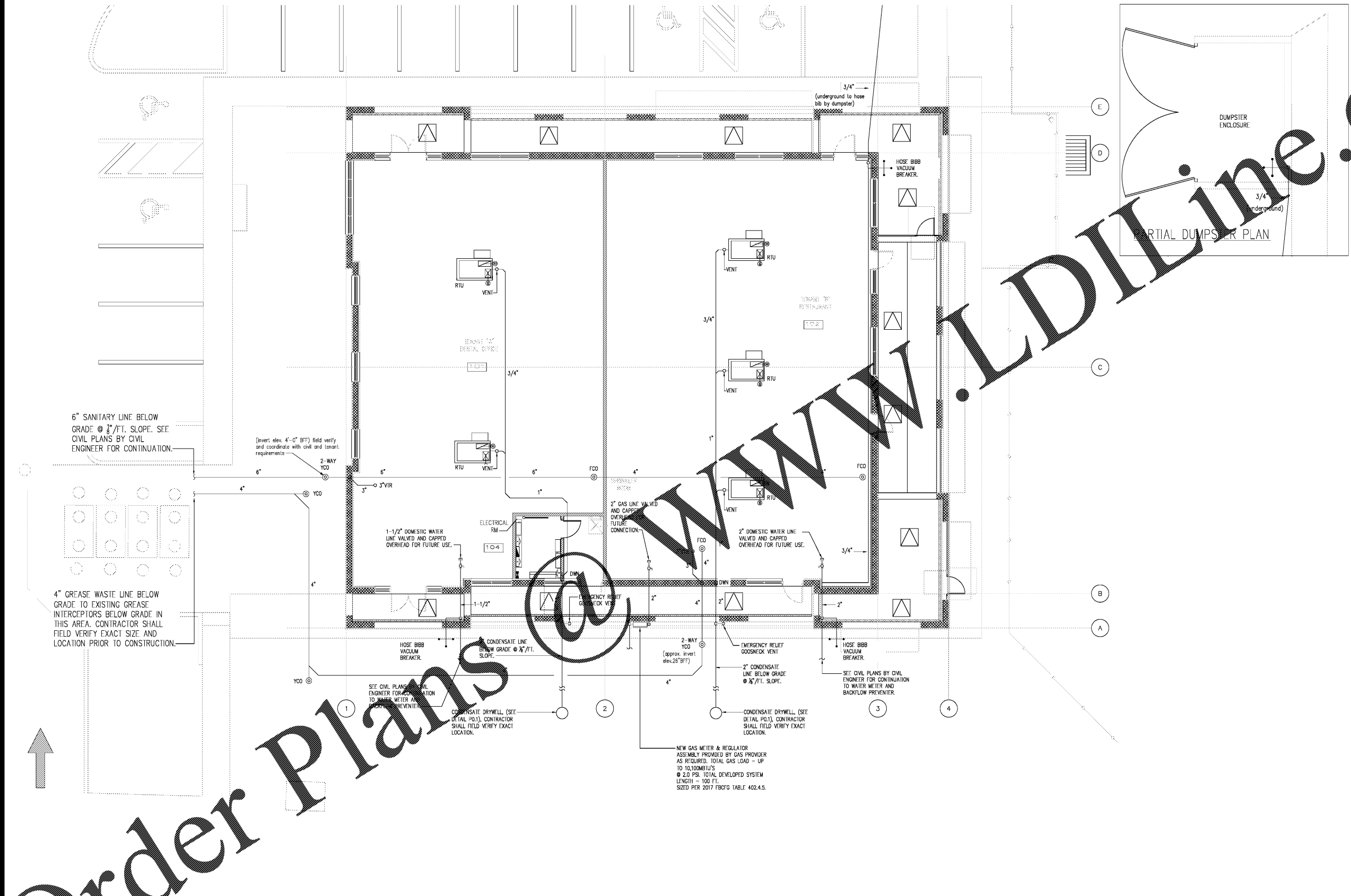

Order Plans

PLUMBING PLAN
SCALE 1/8" = 1'-0"

B&K PROJECT# 2018-0035
PROJECT MANAGER: JUAN J. BDOYA
05/21/2018
DATE

B
B&K Engineering Group

2701 NW BODA RATON BLVD
SUITE 108
BODA RATON, FL 33431
MECH DEPT.
TEL: 961-716-7120
ELEC DEPT.
TEL: 904-644-9612
CERTIFICATION OF AUTHORIZATION
NO. 31989

PREREQ TO SUBMITTING THE BID, THE CONTRACTOR SHALL FIELD VERIFY ALL LISTING CONDITIONS AND INFORM THE ARCHITECT AND THE ENGINEER OF ANY DISCREPANCY BETWEEN THESE DOCUMENTS AND THE EXISTING CONDITIONS AND SHALL INCLUDE IN THE BID TO CORRECT THE SAME AS DIRECTED. THE ENGINEER HAS NOT RESPONDED FOR ANY ADDITIONAL COSTS RESULTING FROM VERIFIABLE EXISTING CONDITIONS DISCOVERED AFTER CONTRACT HAS BEEN AWARDED. NO CLAIMS SHALL BE MADE TO THESE PLANS WITHOUT PRIOR APPROVAL FROM THE ENGINEER OF RECORD. ALL CHANGES SHALL BE SUBMITTED FOR REVIEW PRIOR TO INSTALLATION. NOT FOR BID UNTIL PERMIT HAS BEEN ISSUED.