

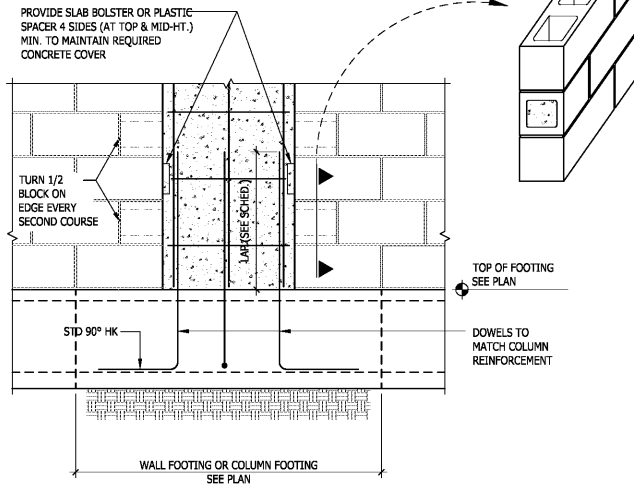

TC-1 TC-2 TC-3
3L-3S
8 #5 BARS
1 TIE
1 CROSSTIE

NOTE:
EXTEND COLUMN TO UPPERMOST
TIE BEAM AND TERMINATE VERTICAL
REINFORCING WITH STD HOOK 6"
FROM TOP OF BEAM



TYPICAL TIE COLUMN DETAIL

MARK	SIZE LxWxD	REINFORCING				REMARKS
		BOTTOM		TOP		
		L.W.	S.W.	L.W.	S.W.	
F-6.0	6'-0"x6'-0"x16"	7#5	7#5			
F-7.5	7'-5"x7'-5"x20"	8#6	8#6			
F-11.0	10'-5"x10'-5"x24"	12#7	12#7			
F-3.5x6.5	3'-5"x6'-5"x12"	4 #5	7 #5			

MARK	SIZE WxLxD	REINFORCING				REMARKS
		CONTINUOUS		TRANSVERSE		
		BOTTOM	TOP	BOTTOM	TOP	
WF-2.0	2'-0"xCONTx12"	3#5	-	#4@18"	-	
WF-3.0	3'-0"xCONTx12"	4#5	-	#5@16"	-	

BAR TYPE	MIN. LAP SPICE LENGTH SCHEDULE									
	BAR SIZE									
	#3	#4	#5	#6	#7	#8	#9	#10	#11	
48 BAR DIAMETER	18"	24"	30"	36"	42"	48"	54"	61"	68"	
FOOTINGS	16"	18"	22"	26"	38"	43"	49"	55"	61"	
COLUMNS	-	-	19"	23"	33"	39"	49"	60"	72"	
WALLS	16"	16"	19"	23"	37"	47"	58"	70"	-	
SLABS	16"	22"	32"	43"	69"	86"	-	-	-	
BEAMS (TOP)	-	-	25"	29"	43"	51"	63"	78"	93"	
BEAMS (MID. & BOTT.)	-	-	19"	23"	33"	39"	49"	60"	72"	
STIRRUPS	16"	16"	19"	23"	-	-	-	-	-	

MARK	ELEV. TOP OF BEAM	SIZE "b x d"	REINFORCING			STIRRUPS		REMARKS
			BOT. CONT.	TOP CONT.	MID CONT.	SIZE	SPACING EACH END	
TB-1	17'-2 1/2"	12"x16"	2 #5	2 #5	-	#3	@18" O.C.	
TB-2	19'-0 1/2"	12"x16"	2 #5	2 #5	-	#3	@18" O.C.	
TB-3	15'-8"	12"x12"	2 #5	2 #5	-	#3	@18" O.C.	
TB-4	25'-4"	12"x16"	2 #5	2 #5	-	#3	@18" O.C.	
TB-5	25'-3 1/2"	12"x16"	2 #5	2 #5	-	#3	@18" O.C.	NOT SUPPORTING TRUSS
TB-6	VARIES	12"x16"	2 #5	2 #5	-	#3	@18" O.C.	BEAM SLOPED, SEE DETAIL 11/S-601
TB-7	17'-7"	12"x16"	2 #5	2 #5	-	#3	@18" O.C.	

MARK	SIZE	REINFORCING			REMARKS
		DOWELS	VERTICAL	TIES	
TC-1	12"x16"	8 #5	8 #5	#3@12" O.C.	
TC-2	12"x16"	8 #5	8 #5	#3@12" O.C.	START AT TB-2
TC-3	12"x14 1/4"	8 #5	8 #5	#3@12" O.C.	

COLUMN NOTES

- Provide #3 ties for all verticals smaller than #11. Use #4 ties for #11 and larger.
- Use tie spacing equal to least dimension of column but not greater than 12". Provide ties within depth of beam and double ties @ 3" o/c at top and bottom of each lift of column (see column diagram).
- Use plastic "column spacers" for all column corner reinforcing and for all primary shearwall reinforcing. Provide 2 sets located within top 1/3 of column height.
- Hook top of vertical bars in all terminating columns 3" below top of slabs and 4" below top of beams. Place hooks parallel to the beam span.
- Provide 3/4" chamfers on all permanently exposed corners of columns and walls unless indicated otherwise on architectural drawings.
- When the area of vertical reinforcing exceeds 4% of the gross area of the column, stagger lap splices of adjacent bars 60 bar diameter or provide mechanical splicers. Mechanical couplers may only be used with the written approval of the engineer.
- Provide min. 48-bar-diameter lap splice for all column verticals, u.o.n.
- Where hairpins are used, vertically alternate the location of 135° hook between faces of column or wall.

SBLM

SOFT-CORE PROPERTIES
107 Fellowship Road, Suite 116
Mount Laurel, NJ 08054
Telephone (856) 780-4460
Fax

Architect
SBLM Architects
11430 N. Kendall Drive, Suite 310
Miami, FL 33176
Telephone 305 412 9187
Fax 305 412 6731
www.sblm.com

Consultants
Civil
Langan Engineering

Structural
Bliss & Nyitray, Inc.
Electrical/Mechanical/Plumbing

Revisions/Issues

06/21/18 PERMIT SET

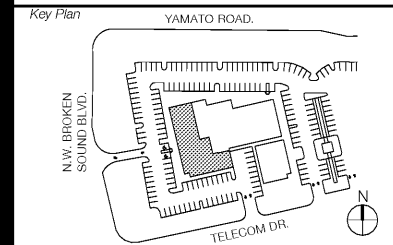

Seal

Lazaro Alfonso, P.E. FL Reg. No.: 69782

Project Title
SOUTHERN PALM CROSSING
BUILDING SHELL
11001-11161 Southern Blvd.
Royal Palm Beach, FL 33411

Job Number 017512.00 - 17M32

Drawing
SCHEDULES

Scale 3/4" = 1'-0"
Drawing Date 06/21/18

Drawing No.

S-411

Sheet Of

Order Plans @ WWW.LDLINE.COM