

REV 1 01/18/18
 REV 2 02/17/18
 REV 0 7/1/18
 REV 0 12/1/18

LANDSCAPE PLAN
SOUTHERN PALM CROSSING
 NEW RETAIL SITE
 ROYAL PALM BEACH FLORIDA

S D r
 LANDSCAPE PLAN

R D
 11/21/18

Pr N r
 1
 Dr N r
LP-1
 S 1 2

Village of Royal Palm Beach Commercial Landscape Requirements
 One (1) tree and ten (10) shrubs per one thousand five hundred (1,500) s.f. of lot area less bodies of water, structures or vehicular use areas.
 Site: 25,935 s.f.
 VUA: 3,948 s.f.
 Open Space: 13,533 s.f.

Required Trees: 9 Provided Trees: 9+
 Required Shrubs: 90 Provided Shrubs: 90+

Perimeter Landscape Buffers
 A 25' landscape buffer shall be situated on a berm no less than three (3) feet in ht with a maximum slope of 3:1 along property line(s) abutting roadways, with a landscape screen consisting of 12" ht. canopy trees 20' On-Center and a continuous hedge.

South: 193 l.f. Required Trees: 10 Provided Trees: 10+
 Continuous hedge provided.

VUA Landscape Requirements
 Perpendicular divider strips: One (1) Tree every 15 l.f. with one (1) shrub and one (1) groundcover for every two (2) divider strips.
 Divider length: N/A

Parking Islands: One (1) Tree and one (1) shrub and one (1) groundcover for every two (2) l.f.
 4 Parking Islands (116 l.f.) Required Trees: 58 Provided Trees: 58
 Required Shrubs/ground cover: 58 shrubs & 58 groundcovers Provided Shrubs/ground cover: 74 shrubs & 240 groundcover
 Three (3) palms equals one (1) Tree. Each existing native tree counts 2:1 for new required trees. Existing native palm counts 1:1 for each new tree.
 50% Native AND/OR Drought tolerant plant material required.

Trees Required: 121 + Continuous hedge = 121 Trees Provided: 39 (Included 29 Existing)
 Required Shrubs: 904 + Continuous hedge = 904 Provided Shrubs: 904 (Includes 486 Existing)
 Native Drought Tolerant Trees Required: 12 Native / Drought Tolerant Trees Provided: 38
 Native Drought Tolerant Shrubs Required: 61 Native / Drought Tolerant Shrubs Provided: 836
 Perimeter Landscape Planting: 200 s.f. planters per 1,000 s.f. building ground floor area shall be provided.
 Required: 200 planters / 100 = 68.5 s.f. planters required Provided: 1,195 s.f.

PLANT SCHEDULE	TY	BOTANICAL NAME	COMMON NAME	CONT	CAL	SI E	NATIVE	DROUGHT
EXISTING PALM TREES	1	SPAL PALMETTO	CABBAGE PALMETTO	EXISTING TO REMAIN			YES	HIGH
EXISTING TREES	TY	BOTANICAL NAME	COMMON NAME	CONT	CAL	SI E	NATIVE	DROUGHT
AR	1	ACER RUBRUM	RED MAPLE	EXISTING TO REMAIN			YES	HIGH
BS	1	BURSERIA SIMARUBA	QUINCE LIMBO	EXISTING TO REMAIN			YES	HIGH
PE2	1	PINUS ELLIOTTII	SLASH PINE	EXISTING TO REMAIN			YES	HIGH
V2	8	UEROUIS VIRGINIANA	SOUTHERN LIVE OAK	EXISTING TO REMAIN			YES	HIGH
TD	1	TAXODIUM DISTICHUM	BALD CYPRESS	EXISTING TO REMAIN			YES	MED
LOWERING TREES	TY	BOTANICAL NAME	COMMON NAME	CONT	CAL	SI E	NATIVE	DROUGHT
BA2	2	BULNINIA ARBOREA	VERAWOOD	B B BELD GROWN	2 CAL	12 HT X 8 SFR	NO	HIGH
PALM TREES	TY	BOTANICAL NAME	COMMON NAME	CONT	CAL	SI E	NATIVE	DROUGHT
PE	8	PHYOSPHERMA ELEGANS	ALEXANDER PALM	B B BELD GROWN	1 CAL	8-12 CT STAGGERED OR HEIGHTS SINGLE TRUNK	NO	HIGH
PROPOSED LOWERING TREES	TY	BOTANICAL NAME	COMMON NAME	CONT	CAL	SI E	NATIVE	DROUGHT
HW2	2	TABERNAEMONTANA	PINK TABERNA	B B BELD GROWN	1 CAL	12 HT X 8 SFR	NO	HIGH
PROPOSED PALM TREES	TY	BOTANICAL NAME	COMMON NAME	CONT	CAL	SI E	NATIVE	DROUGHT
SP	1	SPAL PALMETTO	CABBAGE PALMETTO	B B BELD GROWN	1 CAL	12-2 CT STAGGERED HTB SLICK O RE-CURVE	YES	HIGH
PROPOSED TREES	TY	BOTANICAL NAME	COMMON NAME	CONT	CAL	SI E	NATIVE	DROUGHT
V	1	UEROUIS VIRGINIANA	LIVE OAK	B B BELD GROWN	2 CAL	1 OAK HT X SFR	YES	HIGH
SHRUBS	TY	BOTANICAL NAME	COMMON NAME	CONT	CAL	SI E	NATIVE	DROUGHT
CVS	8	CHRYSOBALANUS ICAGO	RED TIP	1 GAL		8"HT X 3" SFR	NO	HIGH
IP	1	ATROPHILA GERRARDII	SPICY ATROPHILA	1 GAL		8" GAL SINGLE TRUNK TREE GRW	NO	HIGH
SHRUB AREAS	TY	BOTANICAL NAME	COMMON NAME	CONT	CAL	SI E	NATIVE	DROUGHT
CVS	8	CHRYSOBALANUS ICAGO	RED TIP	1 GAL		2" HT X 2" SFR	YES	HIGH
CVC	2	CODIUM VARIEGATUM	CHIRLEYBOY CROTON	1 GAL		2" HT X 2" SFR	NO	MEDIUM
CVS	2	CODIUM VARIEGATUM	SLOPPY PAINTER	1 GAL		2" HT X 2" SFR	NO	MEDIUM
SAT	1	SCHIELEA ARBOREOLA	TRINITE	1 GAL		2" HT X 2" SFR	NO	HIGH
BS	1	SPARKINA BAKERI	SAND CORN GRASS	1 GAL		2" HT X 2" SFR	YES	HIGH
EXISTING GROUND COVER AREAS	TY	BOTANICAL NAME	COMMON NAME	CONT	CAL	SI E	NATIVE	DROUGHT
VW	152	ASPINUM VULNERE	WAX ASPINE	EXISTING TO REMAIN			NO	MEDIUM
EXISTING SHRUB AREAS	TY	BOTANICAL NAME	COMMON NAME	CONT	CAL	SI E	NATIVE	DROUGHT
CIE	10	CHRYSOBALANUS ICAGO	RED TIP	EXISTING TO REMAIN			YES	HIGH
PCB	52	PLUMBAGO IMPERIALIS	IMPERIAL BLUE	EXISTING TO REMAIN			NO	HIGH
TDE	1	IRIPISACUM DACTYLOIDES	AKAHATCHEE GRASS	EXISTING TO REMAIN			YES	HIGH
GROUND COVERS	TY	BOTANICAL NAME	COMMON NAME	CONT	CAL	SI E	NATIVE	DROUGHT
AGR	1	ARACHIS GLABRATA	PERENNIAL PEANUT	1 GAL		8"HT X 12" SFR	NO	HIGH
B D	1	BULBINE RUTESCENS	STALKED BULBINE	12" HT X 12" SFR			NO	HIGH
MG	28	ICUS MICROCARPA	GREEN ISLAND	1 GAL		12" HT 12" SFR	NO	HIGH
VD	8	ALEXANDRIA	STONES DWARF	1 GAL		1" HT X 12" SFR	YES	HIGH
SOCCLEED	TY	BOTANICAL NAME	COMMON NAME	CONT	CAL	SI E	NATIVE	DROUGHT
SOD	1	STENOCHORDIA	LORETTA	1 GAL		3" HT X 12" SFR	NO	HIGH

ALL MISSING OR SUBSTANDARD MATERIAL IN BUYER SHALL BE REPLACED TO MEET THE ORIGINAL APPROVED LANDSCAPE PLAN OR THE OVERALL SITE WITH DATE 00/00/00

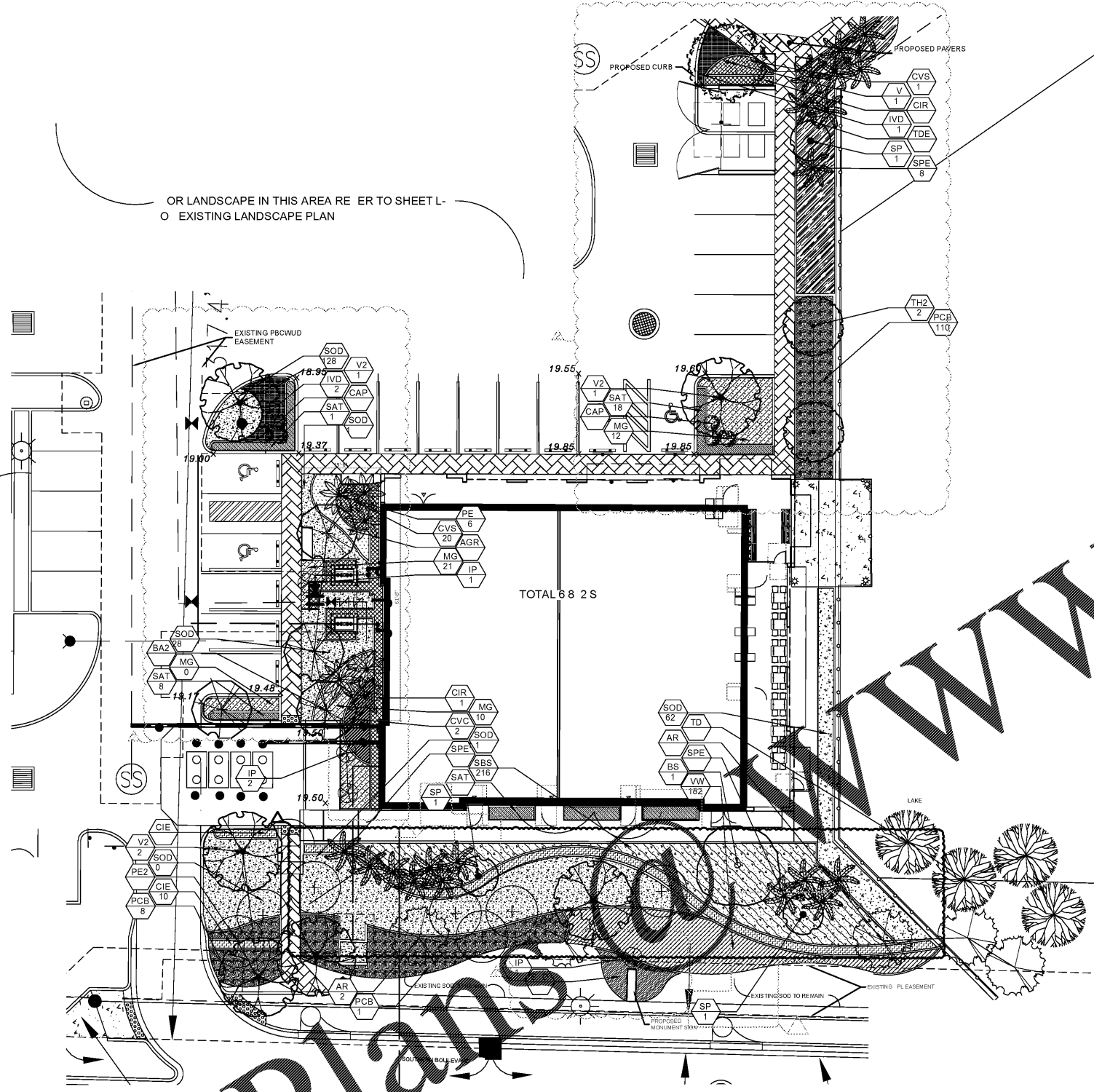

811 KNOW WHAT'S BELOW
 ALWAYS CALL 811 BEFORE YOU DIG
 Call 811 two business days before digging

NORTH
 SCALE 1/16" = 1'-0"

OR LANDSCAPE IN THIS AREA REFER TO SHEET L-1
 OR LANDSCAPE IN THIS AREA REFER TO SHEET L-2
 OR LANDSCAPE IN THIS AREA REFER TO SHEET L-3
 OR LANDSCAPE IN THIS AREA REFER TO SHEET L-4
 OR LANDSCAPE IN THIS AREA REFER TO SHEET L-5
 OR LANDSCAPE IN THIS AREA REFER TO SHEET L-6
 OR LANDSCAPE IN THIS AREA REFER TO SHEET L-7
 OR LANDSCAPE IN THIS AREA REFER TO SHEET L-8
 OR LANDSCAPE IN THIS AREA REFER TO SHEET L-9
 OR LANDSCAPE IN THIS AREA REFER TO SHEET L-10
 OR LANDSCAPE IN THIS AREA REFER TO SHEET L-11
 OR LANDSCAPE IN THIS AREA REFER TO SHEET L-12
 OR LANDSCAPE IN THIS AREA REFER TO SHEET L-13
 OR LANDSCAPE IN THIS AREA REFER TO SHEET L-14
 OR LANDSCAPE IN THIS AREA REFER TO SHEET L-15
 OR LANDSCAPE IN THIS AREA REFER TO SHEET L-16
 OR LANDSCAPE IN THIS AREA REFER TO SHEET L-17
 OR LANDSCAPE IN THIS AREA REFER TO SHEET L-18
 OR LANDSCAPE IN THIS AREA REFER TO SHEET L-19
 OR LANDSCAPE IN THIS AREA REFER TO SHEET L-20