

01 SERVICE AREA
SCALE: 1/4"=1'-0"

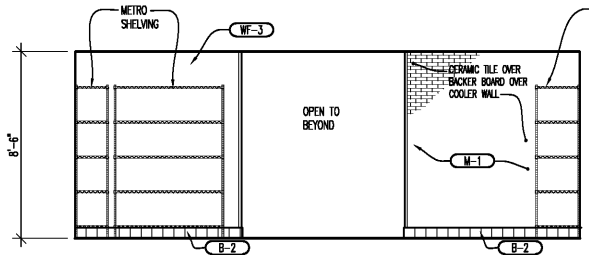

02 SERVICE AREA
SCALE: 1/4"=1'-0"

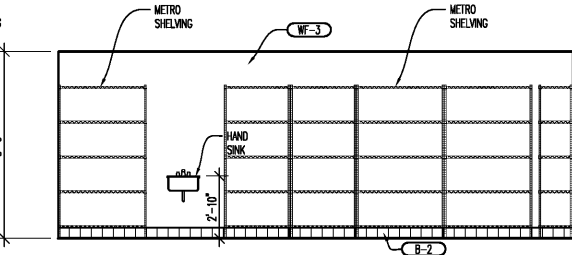

03 SERVICE AREA
SCALE: 1/4"=1'-0"

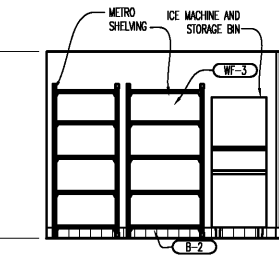

04 SERVICE AREA
SCALE: 1/4"=1'-0"

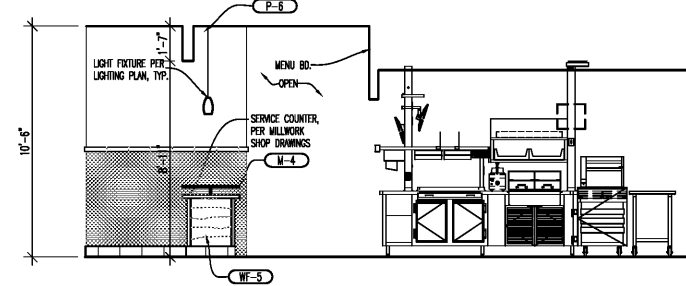

05 SERVICE AREA
SCALE: 1/4"=1'-0"

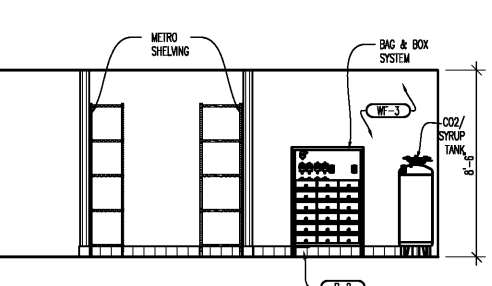

06 SERVICE AREA
SCALE: 1/4"=1'-0"

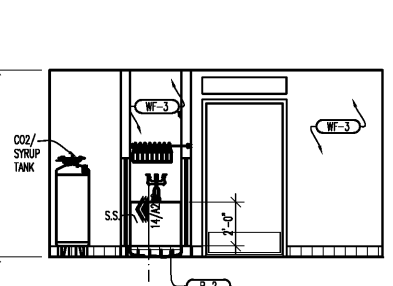

07 SERVICE AREA
SCALE: 1/4"=1'-0"

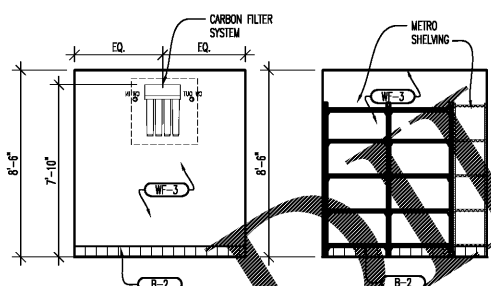

08 SERVICE AREA
SCALE: 1/4"=1'-0"

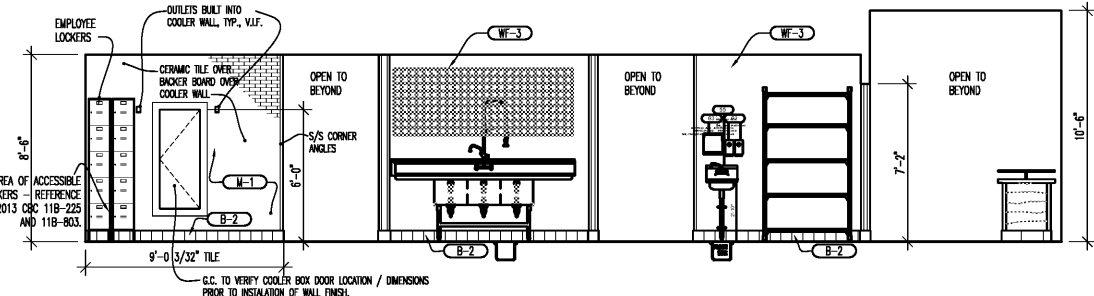

09 SERVICE AREA
SCALE: 1/4"=1'-0"

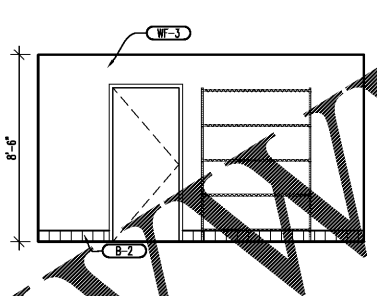

10 SERVICE AREA
SCALE: 1/4"=1'-0"

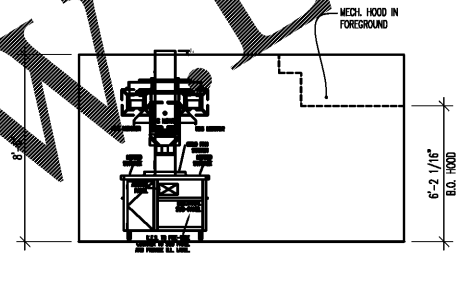

11 SERVICE AREA
SCALE: 1/4"=1'-0"

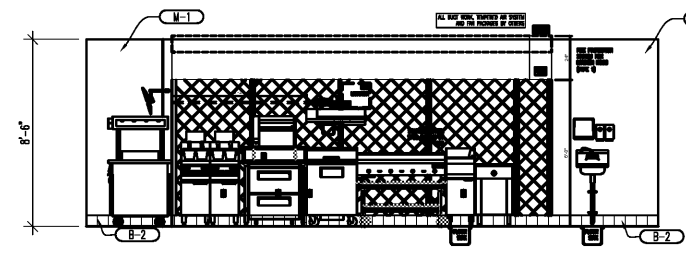

12 SERVICE AREA
SCALE: 1/4"=1'-0"

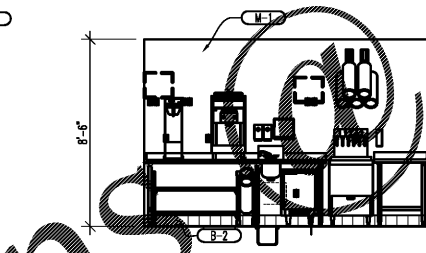

13 SERVICE AREA
SCALE: 1/4"=1'-0"

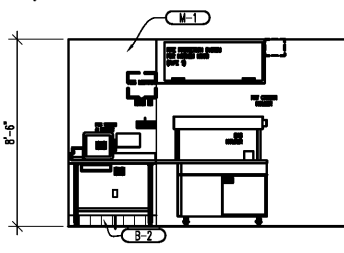

14 SERVICE AREA
SCALE: 1/4"=1'-0"

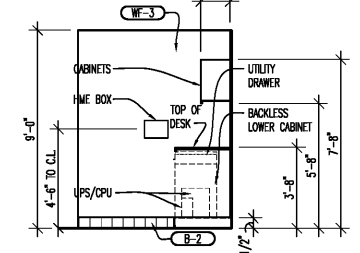

15 OFFICE
SCALE: 1/4"=1'-0"

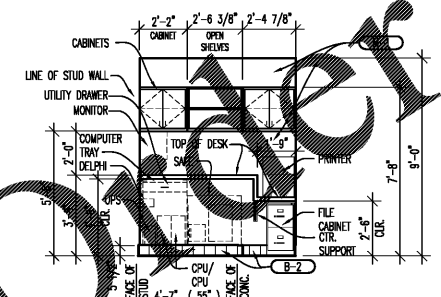

16 OFFICE
SCALE: 1/4"=1'-0"

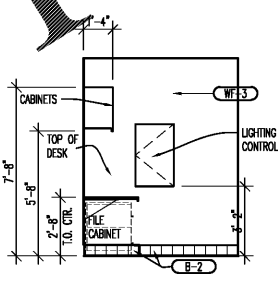

17 OFFICE
SCALE: 1/4"=1'-0"

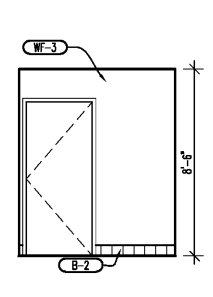

18 OFFICE
SCALE: 1/4"=1'-0"

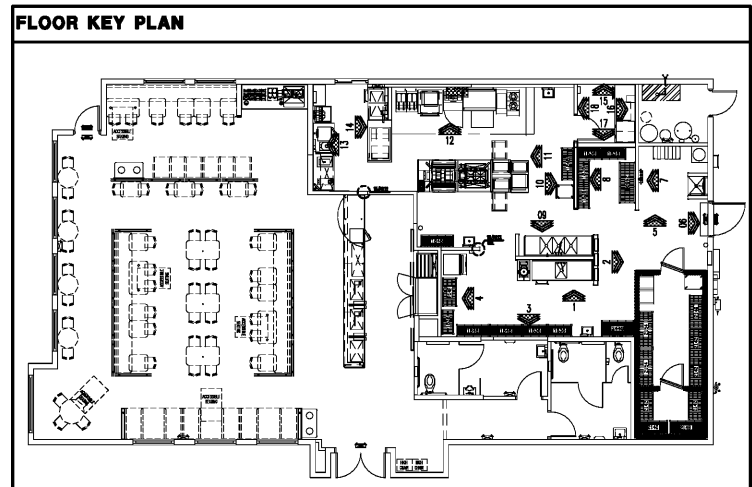

FLOOR KEY PLAN

- INTERIOR ELEVATION NOTES**
1. ALL HEIGHT REFERENCES ARE TAKEN FROM DATUM-TOP OF SLAB FOR AREA INDICATED.
 2. REFER TO FINISH SCHEDULE FOR EXTERIOR FINISHES, SHEET A802.
 3. REFER TO WINDOW SCHEDULE FOR WINDOW FINISHES AND WINDOW TYPES, SHEET A801.
 4. REFER TO DOOR SCHEDULE FOR DOOR FINISHES AND DOOR TYPES, SHEET A801.
 5. ALL LOW WALLS TO RECEIVE WF-2 TILE U.L.O.
 6. REFER TO DETAILS 17/A501 FOR TILE BASE
 7. ALL PLASTIC LAMINATE AND CORIAN TRIM FOR MANSCOT ON WALLS TO BE BY THE MILLWORK CONTRACTOR.
 8. DINING TOPS AND WORK SURFACES SHALL BE 28 INCHES MINIMUM AND 34 INCHES MAXIMUM ABOVE FINISH FLOOR OR GROUND PER 2013 CBC 11B-902.3.

INT. MATERIAL/FINISH SCHEDULE	
FINISH	DESCRIPTION
B	
REFER TO THE FOLLOWING: TAMARA GRANDOSKY - DALLIE NATIONAL ACCOUNT MANAGER CONTACT FOR ALL TILES: M-15-290-8302 F-415-651-9187	
B-1	MANUFACTURER: DALLIE PRODUCT: GLAZED PORCELAIN - PORCALTO 6"x12" S-36C9TB W/ 3/8" COVE BASE W/ SC-36BRT OUTSIDE CORNER COLOR: CITYLINE KOHL #C021 GROUT: LATICRETE #43 CHOCOLATE TRUFFLE; MINIMIZE GROUT LINES
B-2	MANUFACTURER: DAL TILE PRODUCT/FINISH: QUARRY TEXTURES 6"x6" COVE BASE COLOR: 0101: DABLO RED GROUT: LATICRETE #43 CHOCOLATE TRUFFLE; MINIMIZE GROUT LINES
B-3	NOT USED
CL	
CL-1	PRODUCT/FINISH: GYP BD COLOR: PAINT
CL-2	MANUFACTURER: ARMSTRONG PRODUCT/FINISH: CERAMIC - EXPOSED TEE SYSTEM W/ 15/16" GRID SIZE: ULTIMA #18 - 22.5/4" PANELS COLOR: WHITE
CL-3	NOT USED
CL-4	MANUFACTURER: ARMSTRONG PRODUCT/FINISH: CERAMIC - EXPOSED TEE SYSTEM W/ 15/16" GRID COLOR: CLEAN RAIN - 24x36" SMOOTH VINYL FACED PANELS COLOR: WHITE
F	
F-1	MANUFACTURER: DAL TILE PRODUCT/FINISH: SHOULDERBROOK 6"x6" (WITH RANDOM OFFSET PATTERN) COLOR: SD-15 WALNUT GROUT: MAPEI - #114 "MAYODARY"; MINIMIZE GROUT LINES
F-2	NOT USED
F-3	MANUFACTURER: DAL TILE PRODUCT/FINISH: QUARRY TEXTURES 6"x6" COLOR: 0101: DABLO RED GROUT: MAPEI #47 "DWOODAL"; EPOXY GROUT
M	
M-1	MANUFACTURER: DAL TILE PRODUCT/FINISH: CERAMIC SURFACE WALL TILE 3"x6"x1/4" COLOR: L624 WHITE GROUT: MAPEI ULTRACOLOR PLUS FA 700 WHITE WITH A 1/16" GROUT CONTACT: TAMARA GRANDOSKY PHONE: 415-290-8302
M-2	MANUFACTURER: MARLITE RESTROOM DOOR PARTITIONS & FRAMES PRODUCT/FINISH: FORMICA COLOR: AFRICAN LUMBA #7011-43 CONTACT:
M-3	MANUFACTURER: DUPONT CORIAN PRODUCT/FINISH: 1/2" SOLID SURFACE PRIVATE COLLECTION COLOR: NATURAL GRAY CONTACT:
M-4	MANUFACTURER: DUPONT CORIAN PRODUCT/FINISH: 1/2" SOLID SURFACE PRIVATE COLLECTION COLOR: RAIN CLOUD CONTACT:
M-5	MANUFACTURER: FORMICA PRODUCT/FINISH: LAMINATE WOODGRAINS COLOR: #756 NATURAL MAPLE CONTACT:
M-6	MANUFACTURER: DUPONT CORIAN PRODUCT/FINISH: 1/2" SOLID SURFACE PRIVATE COLLECTION COLOR: CINNABAR CONTACT:
P	
PAINT & STAIN	
P-1	MANUFACTURER: SHERWIN WILLIAMS PRODUCT/FINISH: SW# 0057 - EGGSHELL COLOR: CHINESE RED CONTACT: JOHN GASTON, 214.553.3940
P-2	MANUFACTURER: SHERWIN WILLIAMS PRODUCT/FINISH: SW# 6712 - EGGSHELL COLOR: LINA GREEN CONTACT: JOHN GASTON, 214.553.3940
P-3	MANUFACTURER: SHERWIN WILLIAMS PRODUCT/FINISH: SW #6380 - EGGSHELL COLOR: HUMBLED GOLD CONTACT: JOHN GASTON, 214.553.3940
P-4	MANUFACTURER: SHERWIN WILLIAMS PRODUCT/FINISH: SW #6090 - EGGSHELL COLOR: JIVA CONTACT: JOHN GASTON, 214.553.3940
P-5	MANUFACTURER: SHERWIN WILLIAMS PRODUCT/FINISH: SW #7008 - EGGSHELL COLOR: ALABASTER CONTACT: JOHN GASTON, 214.553.3940
P-6	MANUFACTURER: SHERWIN WILLIAMS PRODUCT/FINISH: SW #6891 - EGGSHELL COLOR: MANCINI CONTACT: JOHN GASTON, 214.553.3940
WF	
WALL FINISHES	
WF-1	MANUFACTURER: DAL TILE PRODUCT/FINISH: CERAMIC - CASTLE METALS 2 1/2"x12" COLOR: AGED COPPER HAMMERED OXIDE #C041 GROUT: LATICRETE #43 CHOCOLATE TRUFFLE; MINIMIZE GROUT LINES CONTACT: TAMARA GRANDOSKY PHONE: 415-290-8302
WF-2	MANUFACTURER: DAL TILE PRODUCT/FINISH: COLORSBODY PORCELAIN - KEYSTONES 1'x2" COLOR: BEACH BLEND DKO4 (L335, D317, D161) GROUT: LATICRETE #43 CHOCOLATE TRUFFLE; MINIMIZE GROUT LINES CONTACT: TAMARA GRANDOSKY PHONE: 415-290-8302 NOTES: ON 5/8" WATER RESISTANT GYP BD
WF-3	MANUFACTURER: PRODUCT/FINISH: FRP COLOR: WHITE
WF-4	MANUFACTURER: PRODUCT/FINISH: STAINLESS STEEL PANELS
WF-5	MANUFACTURER: FORMICA PRODUCT/FINISH: LAMINATE WOODGRAINS COLOR: #756 NATURAL MAPLE NOTES: ON 5/8" GYP BD; RUN GRAIN HORIZONTAL EXCEPT ON DOORS
WF-6	MANUFACTURER: DAL TILE PRODUCT/FINISH: CERAMIC - CASTLE METALS 4 1/4"x4 1/4" COLOR: AGED COPPER HAMMERED INSERT #C041 GROUT: LATICRETE #43 CHOCOLATE TRUFFLE; MINIMIZE GROUT LINES
WF-7	MANUFACTURER: DAL TILE PRODUCT/FINISH: CERAMIC - SEMI GLOSS 4 1/4"x4 1/4" COLORS: WHITE #0100 (333K), ALMOND #0125 (333K), URBAN PUTTY #0161 (333K) GROUT: LATICRETE #43 CHOCOLATE TRUFFLE; MINIMIZE GROUT LINES
WF-8	MANUFACTURER: SCHLUTER SYSTEMS PRODUCT/FINISH: ALUM - JOLLY 3/16" COLOR: ANTIQUE BRONZE AB68

Chao & Peterson
Architects Engineers Planners
1925 Prospect Ave. Orlando, FL 32814
(407) 251-9100
(407) 251-9101
www.cpa.com

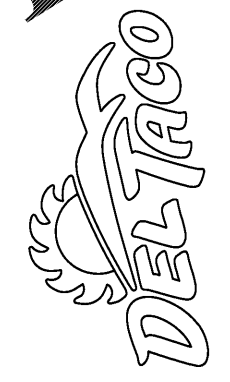

DO NOT SCALE DRAWINGS
CONTRACTOR TO VERIFY
ALL EXISTING CONDITIONS AND
DIMENSIONS-NOTIFY ARCHITECT
OF ANY DISCREPANCIES PRIOR
TO BEGINNING CONSTRUCTION



JULY 5TH, 2018
NO | REVISION

DEL TACO STORE - DT2017
4525 JIMMY LEE SMITH PARKWAY
HIRAM, GA 30141
PAULTON COUNTY
1ST PERMIT SUBMITTAL 05-18-18
1ST BID SUBMITTAL 07-05-18

PROJECT NUMBER
2180148
SHEET NAME
BACK OF HOUSE ELEVATIONS
SHEET NUMBER
A213
DATE OF THIS PRINTING - 7/3/2018

SWED BY: JACOB 7/15/2018 4:45 PM
PRINTED BY: JACOB 7/15/2018 4:51 PM
0700_2180148_A213_Back of House Elevation.dwg