

1 SECTION
3/4" = 1'-0"

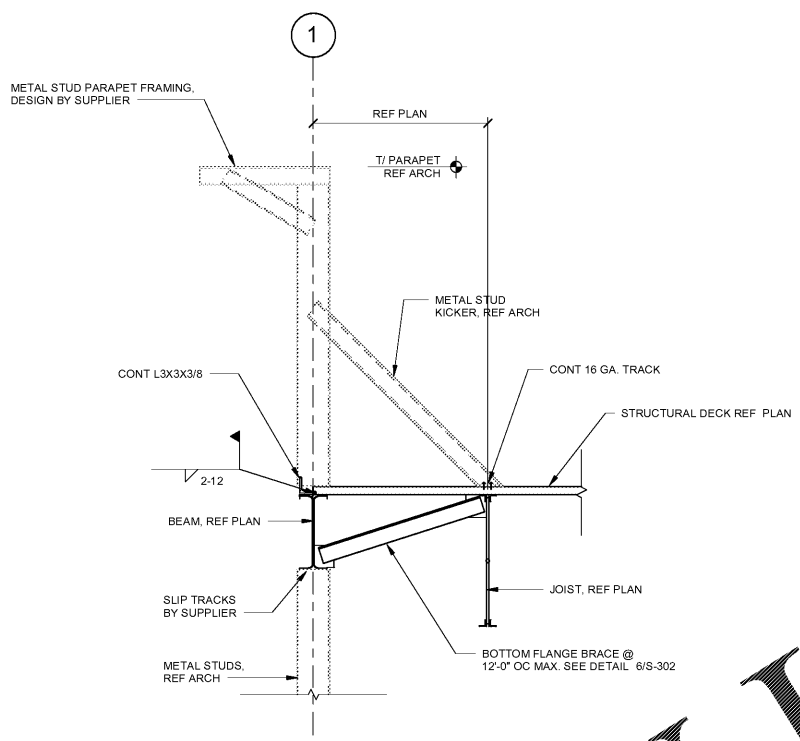

2 SECTION
3/4" = 1'-0"

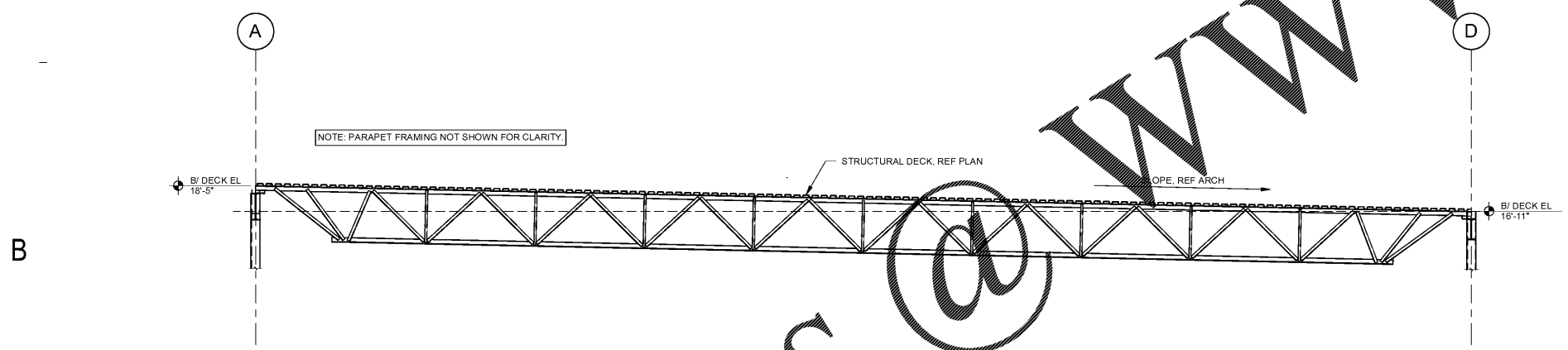

3 SECTION
1/4" = 1'-0"

THIS DOCUMENT HAS BEEN PREPARED BY BRITT, PETERS AND ASSOCIATES, INC. AS AN INSTRUMENT OF SERVICE AND BAA SHALL RETAIN ALL COMMON LAW, STATUTORY AND OTHER RESERVED RIGHTS, INCLUDING THE COPYRIGHT THEREON.

Order Plans @

WWW.LDILine.com

BRITT, PETERS
AND
ASSOCIATES
INC.
consulting engineers

101 Falkland Dr.
Suite 601
Greenville, SC 29601
(864) 771-8869
www.brittpeters.com
BPA Job # 190700
FL COA No. 27497



This document is the property of Britt, Peters and Associates, Inc. It is to be used only for the project and location specified herein. No part of this document may be reproduced, stored in a retrieval system, or transmitted, in any form or by any means, electronic, mechanical, photocopying, recording, or by any information storage and retrieval system, without the prior written permission of Britt, Peters and Associates, Inc. All rights reserved.

ISSUANCE

REVISIONS

NO.	DATE	DESCRIPTION

FILE NUMBER: 78890009
PROJECT MANAGER: _____
PROFESSIONAL: _____
DRAWN BY: Author
CHECKED BY: Checker

THE AUTO CLUB GROUP
AAA - CAR CARE CENTER
TAMPA, FL 33607
1701 NORTH WESTSHORE BLVD.

progressive

PROGRESSIVE ARCHITECTURE ENGINEERING, P.C.
310 South 1st Street, Suite 501, Charlotte, NC 28202 | Tel: 771.8867 | www.progressiveae.com