

Plotted By: hcrison, Also: Street Set/PDI Campus Layout IR-110 IRRIGATION PLAN June 28, 2018 08:56:47cm K:\SAR\_IRG\148299000 - pdi campus improvements\CAD\plansets\IR-110 SURGE IRRIGATION PLAN.dwg  
 This document, together with the concepts and designs presented herein, is intended only for the specific purpose and client for which it was prepared. Reuse of and improper reliance on this document without written authorization and adaptation by Kimley-Horn and Associates, Inc. shall be without liability to Kimley-Horn and Associates, Inc.

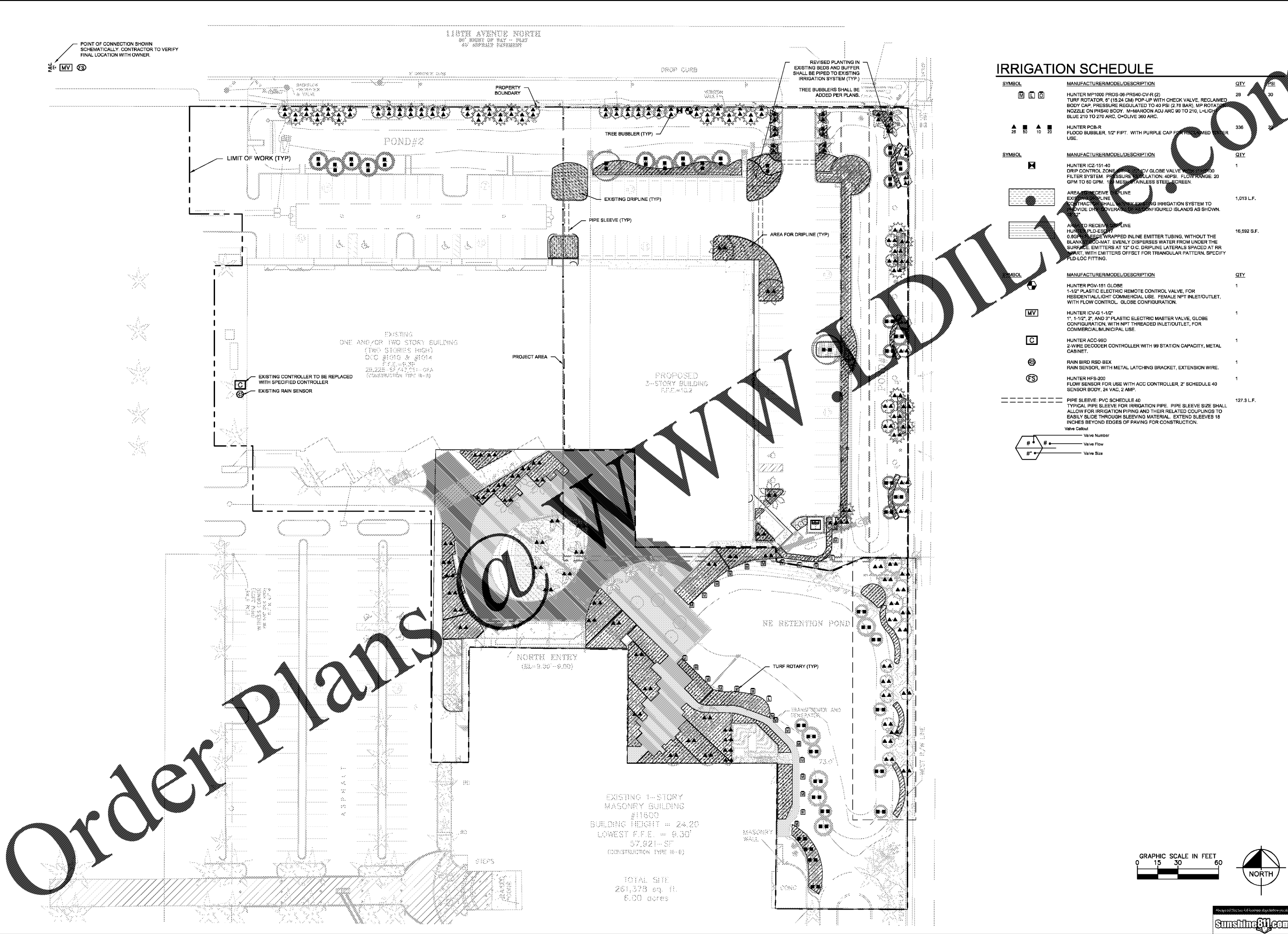

**IRRIGATION SCHEDULE**

SYMBOL	MANUFACTURER/MODEL/DESCRIPTION	QTY	PSI
[Symbol]	HUNTER MP1000 PROS-98-PRS40-CV-R (2) TURF ROTATOR, 8" (15.24 CM) POP-UP WITH CHECK VALVE, RECLAIMED BODY CAP, PRESSURE REGULATED TO 40 PSI (2.76 BAR), MP ROTATOR NOZZLE ON PRAISE BODY, 18" HANDBOOK ADJ ARC 90 TO 210, L-LIGHT BLUE 210 TO 270 ARC, O-OLIVE 360 ARC.	28	30
[Symbol]	HUNTER PCB-R FLOOD BUBBLER, 12" FIPT. WITH PURPLE CAP FOR RECLAIMED WATER USE.	336	
SYMBOL	MANUFACTURER/MODEL/DESCRIPTION	QTY	
[Symbol]	HUNTER IZ-151-40 DRIP CONTROL ZONE 151 PVC GLOBE VALVE FOR 151000 FILTER SYSTEM, PRESSURE REGULATION: 40PSI, FLOW RANGE: 20 GPM TO 60 GPM, 1/2" MESH STAINLESS STEEL SCREEN.	1	
[Symbol]	AREA TO RECEIVE DRIPLINE EXISTING DRIPLINE TO BE REMOVED AND IRRIGATION SYSTEM TO PROVIDE DRAINAGE OVERLAND BY USING IRRIGATION SYSTEMS CONFIGURED ISLANDS AS SHOWN.	1,013 L.F.	
[Symbol]	AREA TO RECEIVE DRIPLINE HUNTER PLS-ES-117 0.8GPH PEEL-AND-REMOVE WRAPPED INLINE EMITTER TUBING, WITHOUT THE BLANK END-CAP MAT, EVENLY DISPERSES WATER FROM UNDER THE SURFACE. EMITTERS AT 12" O.C. DRIPLINE LATERALS SPACED AT 18" APART, WITH EMITTERS OFFSET FOR TRIANGULAR PATTERN. SPECIFY PLS-LOC FITTING.	16,592 S.F.	
SYMBOL	MANUFACTURER/MODEL/DESCRIPTION	QTY	
[Symbol]	HUNTER PGV-151 GLOBE 1-1/2" PLASTIC ELECTRIC REMOTE CONTROL VALVE, FOR RESIDENTIAL/LIGHT COMMERCIAL USE, FEMALE NPT INLET/OUTLET, WITH FLOW CONTROL, GLOBE CONFIGURATION.	1	
[Symbol]	HUNTER CV-G 1-1/2" 1-1/2", 2", AND 3" PLASTIC ELECTRIC MASTER VALVE, GLOBE CONFIGURATION, WITH NPT THREADED INLET/OUTLET, FOR COMMERCIAL/MUNICIPAL USE.	1	
[Symbol]	HUNTER ACC-99D 2-WIRE DECODER CONTROLLER WITH 99 STATION CAPACITY, METAL CABINET.	1	
[Symbol]	RAIN BIRD RSD-BEX RAIN SENSOR, WITH METAL LATCHING BRACKET, EXTENSION WIRE.	1	
[Symbol]	HUNTER HFS-200 FLOW SENSOR FOR USE WITH ACC CONTROLLER, 2" SCHEDULE 40 SENSOR BODY, 24 VAC, 2 AMP.	1	
[Symbol]	PIPE SLEEVE: PVC SCHEDULE 40 TYPICAL PIPE SLEEVE FOR IRRIGATION PIPE. PIPE SLEEVE SIZE SHALL ALLOW FOR IRRIGATION PIPING AND THEIR RELATED COUPLINGS TO EASILY SLIDE THROUGH SLEEVING MATERIAL. EXTEND SLEEVES 18 INCHES BEYOND EDGES OF PAVING FOR CONSTRUCTION.	127.3 L.F.	

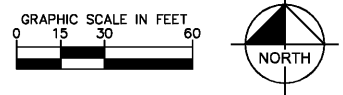
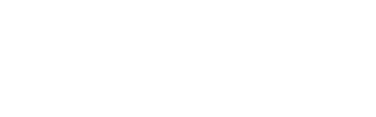

Order Plans @ WWW.WALDILL.COM

**Kimley»Horn**  
 © 2018 KIMLEY-HORN AND ASSOCIATES, INC.  
 1777 MAIN STREET, SUITE 200, SARASOTA, FL 34236  
 PHONE: 941-379-7600  
 WWW.KIMLEY-HORN.COM CA 0000686

**IRRIGATION PLAN**

**PDI CAMPUS**  
 PREPARED FOR  
**POWER DESIGN, INC.**  
 ST. PETERSBURG, FLORIDA

KHA PROJECT: 148299000  
 DATE: JUNE 2018  
 SCALE: AS SHOWN  
 DESIGNED BY: KHA  
 DRAWN BY: KHA  
 CHECKED BY: CDC DATE: 6/28/2018

FLORIDA REGISTERED PROFESSIONAL ARCHITECT  
 LAG66207  
 SITE OF  
 CHRISTOPHER D. CLARK GLOVER

NO. \_\_\_\_\_  
 REVISIONS \_\_\_\_\_  
 DATE \_\_\_\_\_

SHEET NUMBER  
**IR-150**