

This document, together with the concepts and designs presented herein, is intended only for the specific purpose and client for which it was prepared. Reuse of and improper reliance on this document without written authorization and adaptation by Kimley-Horn and Associates, Inc. shall be without liability to Kimley-Horn and Associates, Inc.

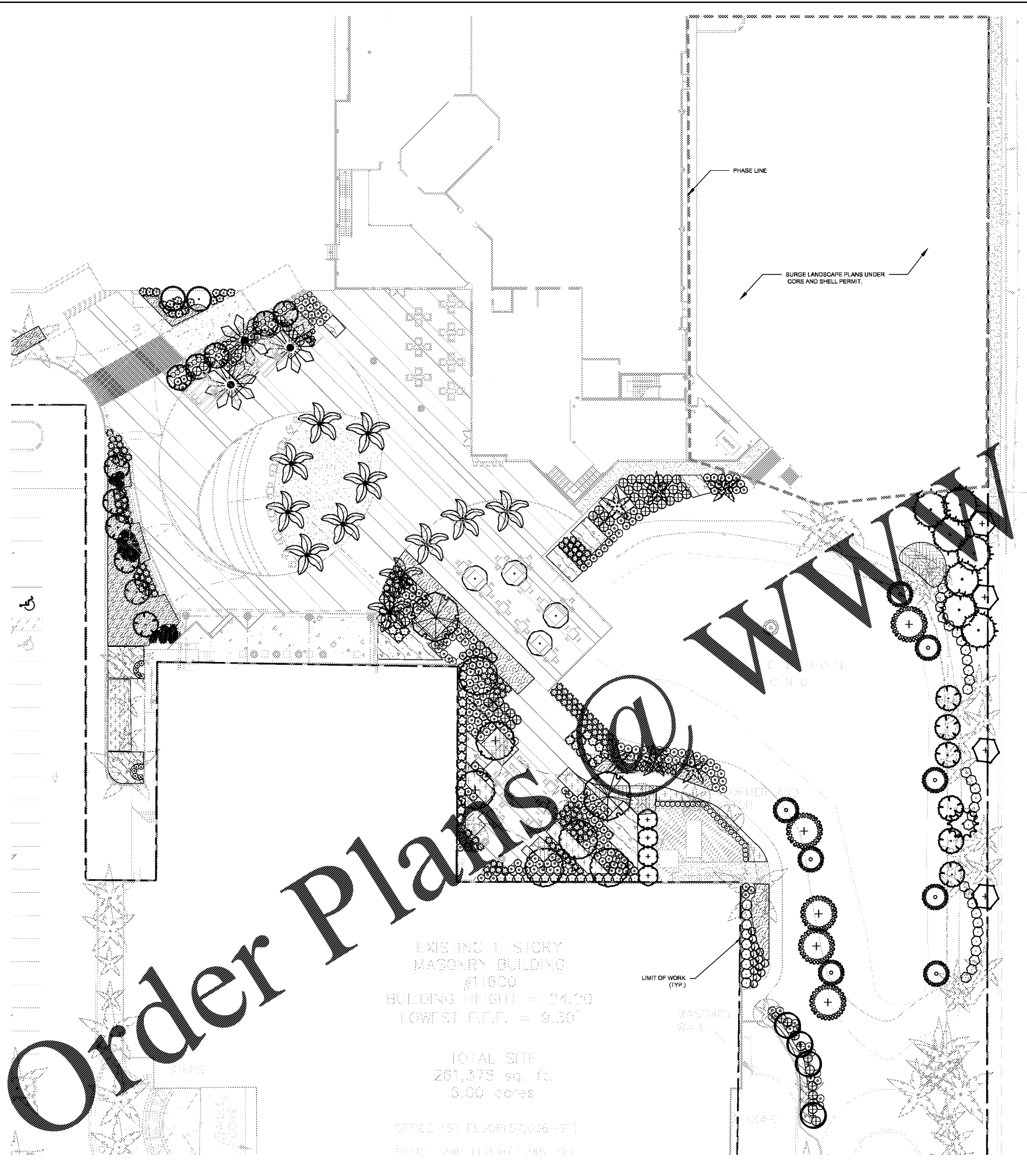

Order Plans

EXISTING 1-STORY  
MASONRY BUILDING  
#11600  
BUILDING HEIGHT = 24.20  
LOWEST F.F.E. = 9.30'

TOTAL SITE  
261,378 sq. ft.  
5.00 acres

OFFICE 1ST FLOOR (07,026-57)  
PHONE 408.424.1000 FAX 408.424.1001

**PLANT SYMBOL KEY**

TREES	CODE	COMMON NAME
	AC	ARECA PALM
	CE	SILVER BUTTWOOD
	ED	JAPANESE BLUEBERRY TREE
	IC	DAHON HOLLY
	IV	WEeping YAUPON HOLLY
	JS	SOUTHERN RED CEDAR
	LI	JAPANESE PRIVET
	PMZ	DATE PALM
	PR	PIGMY DATE PALM MULTITRUNK
	RE	FLORIDA ROYAL PALM
	SP	CABBAGE PALMETTO
	TC	SILVER TREMBLET
	TD	OLD CYPRESS
	TDZ	BALDY CYPRESS
	FOXT	FOXTAIL PALM
	SHUB	SHRUB
	COD	COMMON NAME
	AO	ORANGEADE BROMELIAD
	AL	'AUNTIE LOU' TI PLANT
	CP	BRAVO CROTON
	CR	RED SISTER TI PLANT
	CS2	STOP LIGHT CROTON
	NF	SUPER FIREBALL BROMELIAD
	PA	WHITE LEAVED FOUNTAIN GRASS
	PX	XANADU PHILODENDRON
	SV	DWARF VARIEGATED SCHEFFLERA
	VA	AWABUKI VIBURNUM
	VO	SWEET VIBURNUM
	FG	GREEN ISLAND FICUS
	IN	RED IKORA
	SR	SAW PALMETTO
	LB	BIG BLUE LILYTURF
	TM	MINIMA VARIEGATED JASMINE

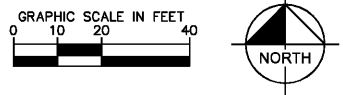

<p><b>Kimley»Horn</b>  <small>© 2018 KIMLEY-HORN AND ASSOCIATES, INC.          1777 MAIN STREET, SUITE 200, SARASOTA, FL 34236          WWW.KIMLEY-HORN.COM CA 0000686</small></p>	<p>REGISTERED LANDSCAPE ARCHITECT          STATE OF FLORIDA          LAA667207          CHRISTOPHER D. CLARK-GILGIONE</p>	<p>KHA PROJECT 148299000</p>	<p>DATE JUNE 2018</p>	<p>SCALE AS SHOWN</p>	<p>DESIGNED BY KHA</p>	<p>DRAWN BY KHA</p>	<p>CHECKED BY CDC</p>	<p>DATE 6/28/2018</p>
	<p><b>PLAZA LANDSCAPE PLAN</b></p>	<p><b>PDI CAMPUS</b> PREPARED FOR <b>POWER DESIGN, INC.</b></p>	<p>ST. PETERSBURG</p>	<p>SHEET NUMBER <b>L-100</b></p>	<p>REVISIONS</p>	<p>DATE</p>	<p>BY</p>	