

Plotted By: hcrison, Also: Street Set: PDI\_CAMPUS\_Layout\TM-100 OVERALL TREE MITIGATION PLAN - June 28, 2018 - 08:52:30am - c:\saw\_urb\148299000 - pcf\campus\_improvements\CAD\plansets\TM-100 OVERALL TREE MITIGATION PLAN.dwg  
 This document, together with the concepts and designs presented herein, is intended only for the specific purpose and client for which it was prepared. Reuse of and improper reliance on this document without written authorization and adoption by Kinley-Horn and Associates, Inc. shall be without liability to Kinley-Horn and Associates, Inc.

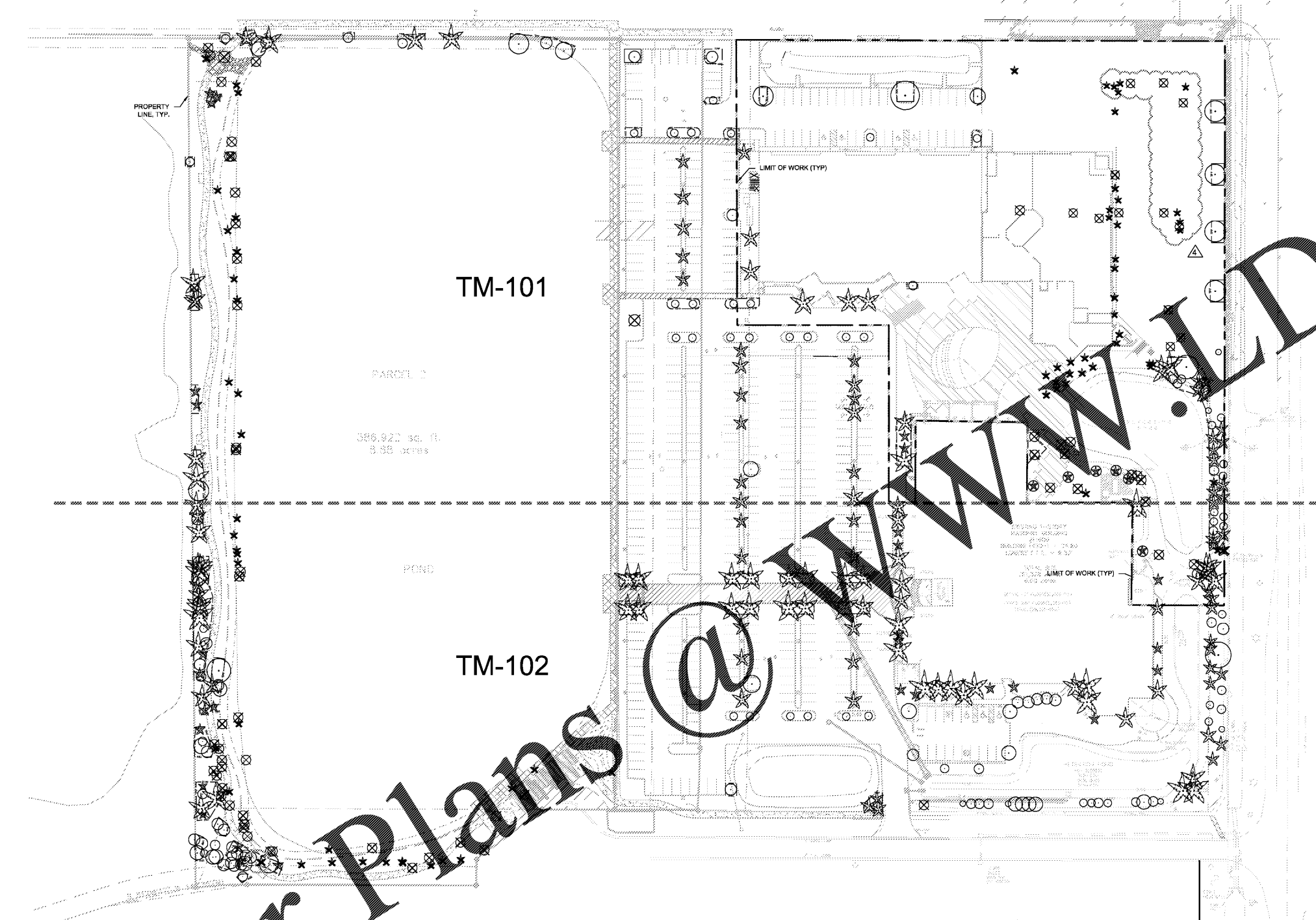

Order Plans @ UNAWAILED ONLINE.COM

**TREE SYMBOL KEY**

- TREE TO REMAIN
- ⊗ TREE TO BE REMOVED
- ★ PALM TO REMAIN
- ✱ PALM TO BE REMOVED
- ⊗ PALM TO BE RELOCATED
- TREE PROTECTION FENCING

**NOTES**

1. SEE SHEET TM-103 FOR TREE MITIGATION DATA AND CALCULATIONS.
2. SEE SHEET TM-150 FOR TREE MITIGATION NOTES AND DETAILS.
3. SEE PROTECTION FENCING (TYP.) IS SHOWN APPROXIMATE LOCATIONS ON THE PLANS. ANY WORK DONE WITHIN THE LIMITS OF THE DRIPLINE SHALL BE DONE IN ACCORDANCE WITH THE TREE MITIGATION NOTES, SHEET TM-103.
4. T.P. POINTS SHALL REMAIN INTACT THROUGHOUT CONSTRUCTION. UPON COMPLETION OF EXISTING CONDITIONS DEMOLITION, CONTRACTOR SHALL ADJUST POINTS SO THAT TREES TO REMAIN ARE FULLY PROTECTED DURING CONSTRUCTION.
5. EXISTING TREES SHALL BE PRUNED UNDER THE DIRECTION OF AN ISA CERTIFIED ARBORIST ACCORDING TO CITY OF PORT CHARLOTTE STANDARDS.
6. SEE LANDSCAPE PLANS FOR ALL PROPOSED REPLACEMENT TREES.
7. ALL POOR HEALTH TREES LISTED IN THE TREE OBSERVATION DATA HAVE BEEN EXCLUDED FROM THE REPLACEMENT CALCULATIONS.
8. TREE MITIGATION PLANS PREPARED BY CERTIFIED ARBORIST LICENSE #FL6527A.

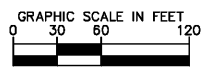

No.	REVISIONS	DATE	BY

**Kimley»Horn**  
 © 2018 KIMLEY-HORN AND ASSOCIATES, INC.  
 1777 MAIN STREET, SUITE 200, SARASOTA, FL 34236  
 PHONE: 941-379-7600  
 WWW.KIMLEY-HORN.COM CA 0000686

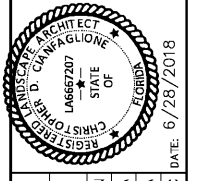

KHA PROJECT: 148299000  
 DATE: JUNE 2018  
 SCALE: AS SHOWN  
 DESIGNED BY: KHA  
 DRAWN BY: KHA  
 CHECKED BY: CDC DATE: 6/28/2018

**OVERALL TREE MITIGATION PLAN**

**PDI CAMPUS**  
 PREPARED FOR  
**POWER DESIGN, INC.**  
 ST. PETERSBURG FLORIDA

SHEET NUMBER  
**TM-100**

