

5/2/2018 1:48:32 PM C:\Users\daniel.green\Documents\Starbucks_Cypress Gardens & Roosevelt_FL_2017_daniel.green@interbrand.com.rvt

SHEET NOTES

1. INSTALL ELECTRICAL PANEL AS INDICATED ON ELECTRICAL DRAWINGS.
2. INSTALL CASEWORK ITEMS AS INDICATED ON CASEWORK PLAN.
3. INSTALL CONDIMENT CART AS INDICATED ON CASEWORK PLAN.
4. INSTALL PLUMBING ITEMS AS INDICATED ON FF&E PLAN.
5. INSTALL EQUIPMENT AS INDICATED ON FF&E PLAN.
6. INSTALL MISCELLANEOUS DISPLAY ITEMS AS INDICATED ON FF&E PLAN.
7. INSTALL FURNITURE AS INDICATED ON FF&E PLAN.
8. PRIME AND PAINT CEILING OR SOFFIT AS INDICATED ON REFLECTED CEILING PLAN.
9. INSTALL GRAPHICS AS INDICATED ON INTERIOR ELEVATIONS.
10. INSTALL WALL FINISH THROUGHOUT AS INDICATED ON INTERIOR ELEVATIONS AND WALL FINISH PLAN.
11. INSTALL FLOOR FINISH AS INDICATED ON FLOOR FINISH PLAN.
12. INSTALL LIGHT FIXTURES AS INDICATED ON REFLECTED CEILING AND DIMENSIONED LIGHTING PLAN.
13. INSTALL CEILING FINISHES AS INDICATED ON REFLECTED CEILING AND DIMENSIONED CEILING PLANS.
14. PRIME AND PAINT WALLS AS INDICATED ON WALL FINISH PLAN AND INTERIOR ELEVATIONS.
15. EXISTING BUILDING SHELL BY LL.
16. INSTALL WALK-OFF MAT AS INDICATED ON FLOOR FINISH PLAN.
17. CONSTRUCT INTERIOR PARTITION WALLS AS INDICATED ON FLOOR PLAN.
18. INSTALL ESPRESSO BAR AS INDICATED ON CASEWORK PLAN.
19. INSTALL ELECTRICAL OUTLETS AS INDICATED ON PENETRATION PLAN AND ELECTRICAL DRAWINGS.
20. INTERIOR CONCRETE SLAB BY GC.
21. EXISTING PATIO RAILING.



STARBUCKS
 2401 UTAH AVENUE SOUTH
 SEATTLE, WASHINGTON 98134
 (206) 318-1575

THESE DRAWINGS AND SPECIFICATIONS ARE CONFIDENTIAL AND SHALL REMAIN THE SOLE PROPERTY OF STARBUCKS CORPORATION, WHICH IS THE OWNER OF THE COPYRIGHT IN THIS WORK. THEY SHALL NOT BE REPRODUCED (IN WHOLE OR IN PART), SHARED WITH THIRD PARTIES OR USED IN ANY MANNER ON OTHER PROJECTS OR EXTENSIONS TO THIS PROJECT WITHOUT THE PRIOR WRITTEN CONSENT OF STARBUCKS CORPORATION. THESE DRAWINGS AND SPECIFICATIONS ARE INTENDED TO EXPRESS DESIGN INTENT FOR A PROTOTYPICAL STARBUCKS STORE (WHICH IS SUBJECT TO CHANGE AT ANYTIME) AND DO NOT REFLECT ACTUAL SITE CONDITIONS. NEITHER PARTY SHALL HAVE ANY OBLIGATION NOR LIABILITY TO THE OTHER (EXCEPT STATED ABOVE) UNTIL A WRITTEN AGREEMENT IS FULLY EXECUTED BY BOTH PARTIES.

STARBUCKS TEMPLATE VERSION | 2018.01.26

Design Forum Architects Inc.

700 W. Pale Rose Way, Suite 400
 Cincinnati, OH 45203
 Tel: (513) 421-2210

Donald J. Rehrman
 Architect in Charge
 License: AR0017303

Design Forum Engineering

700 W. Pale Rose Way, Suite 400
 Cincinnati, OH 45203
 Tel: (513) 421-2210

Timothy L. Raderding, PE
 Professional Engineer
 License: 62078

PROJECT NAME:
**CYPRESS GARDENS
 BLVD & ROOSEVELT**

PROJECT ADDRESS:
**5709 CYPRESS GARDENS BLVD
 WINTER HAVEN, FL 33884**

STORE #: 50175
 PROJECT #: 73763-001
 ISSUE DATE: 04/20/2018
 DESIGN PROGRAM: LAIS BRITO
 MANAGER:
 LEEDO AP: STARBUCKS
 PRODUCTION DESIGNER: MICHAEL B. SARKA
 CHECKED BY: ANA COSTANZO

Revision Schedule			
Rev	Date	By	Description

SHEET TITLE:
SCOPE OF WORK

SCALE: 1/4" = 1'-0"

SHEET NUMBER:

APX-100

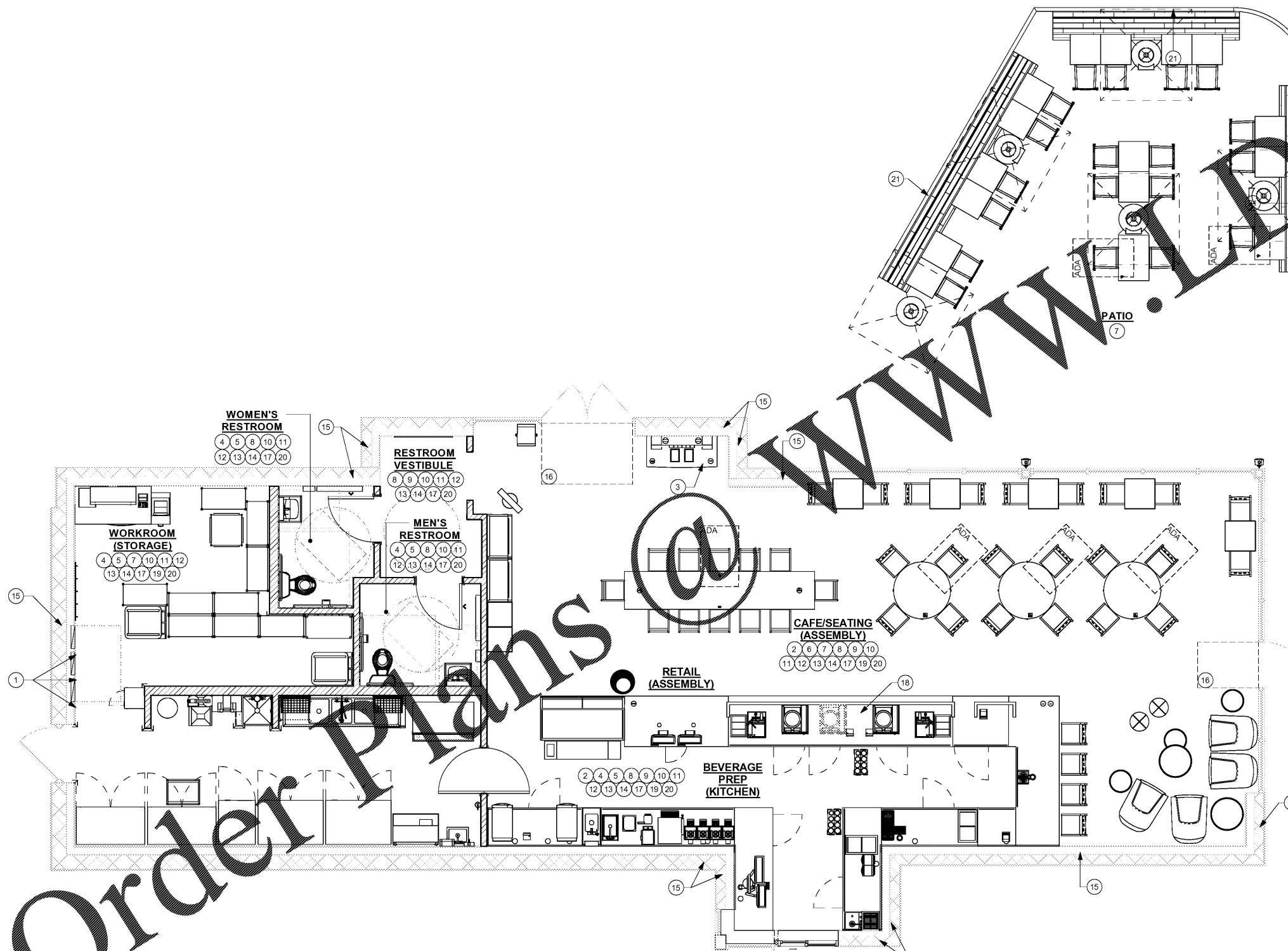

1 SCOPE OF WORK
 Scale: 1/4" = 1'-0"

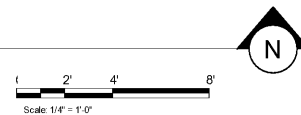

Order Plans

www.dline.com