

WALL TYPES LEGEND

- 1 Existing Wall - 8" CMU Block wall with 7/8" Stucco on the Exterior Wall and Interior to have 20 Ga 6" (92 mm) metal studs w/ R-19 batt insulation at 16" (406 mm) O.C. with 5/8" (16 mm) gypsum board.
- 2 Existing Wall - 12" CMU Block wall with 7/8" Stucco on the Exterior Wall and Interior to have 20 Ga 6" (92 mm) metal studs w/ R-19 batt insulation at 16" (406 mm) O.C. with 5/8" (16 mm) gypsum board.
- 3 New Partition Wall to Structure Above
20 Ga 3-5/8" (92 mm) metal studs 16" (406 mm) O.C. to structure with 5/8" (16 mm) moisture resistant gypsum board on one side to underside of gypsum board ceiling and type "X" gypsum board on other side to structure above. Secure gypsum board to studs with drywall screws at 10" (254 mm) O.C. at panel edges and 12" (305 mm) O.C. at intermediate supports.
- 4 New Furred Wall to structure above
20 Ga 3-5/8" (92 mm) metal studs 16" (406 mm) O.C. to structure with 5/8" (16 mm) Type "X" gypsum board on one side to underside of gypsum board ceiling. Secure gypsum board to studs with drywall screws at 10" (254 mm) O.C. at panel edges and 12" (305 mm) O.C. at intermediate supports.
- 5 New Partition Wall to Structure Above
20 Ga 3-5/8" (92 mm) metal studs 16" (406 mm) O.C. to structure with 5/8" (16 mm) Type "X" gypsum board on both sides to underside of gypsum board ceiling. Secure gypsum board to studs with drywall screws at 10" (254 mm) O.C. at panel edges and 12" (305 mm) O.C. at intermediate supports.
- 6 New Furred Wall to 6" Above Ceiling
20 Ga 3-5/8" (92 mm) metal studs 16" (406 mm) O.C. with 5/8" (16 mm) moisture resistant gypsum board on both sides to 6" above ceiling and other side to structure above. Secure gypsum board to studs with drywall screws at 10" (254 mm) O.C. at panel edges and 12" (305 mm) O.C. at intermediate supports.
- 7 New Furred Wall to 6" Above Ceiling
20 Ga 3-5/8" (92 mm) metal studs 16" (406 mm) O.C. with 5/8" (16 mm) moisture resistant gypsum board on one side to underside of gypsum board ceiling. Secure gypsum board to studs with drywall screws at 10" (254 mm) O.C. at panel edges and 12" (305 mm) O.C. at intermediate supports.
- 8 New Partition Wall to 6" above ceiling
20 Ga 3-5/8" (92 mm) metal studs 16" (406 mm) O.C. with 5/8" (16 mm) Type "X" gypsum board on one side and moisture resistant gypsum board on other side to underside of gypsum board ceiling. Secure gypsum board to studs with drywall screws at 10" (254 mm) O.C. at panel edges and 12" (305 mm) O.C. at intermediate supports. Provide 45 degree metal stud Diagonal Bracing @ 48" (1219 mm) O.C. from top of stud wall to structure above.
- 9 New Partition Wall to 6" Above Ceiling
20 Ga 3-5/8" (92 mm) metal studs 16" (406 mm) O.C. with 5/8" (16 mm) moisture resistant gypsum board on both sides to underside of gypsum board ceiling. Secure gypsum board to studs with drywall screws at 10" (254 mm) O.C. at panel edges and 12" (305 mm) O.C. at intermediate supports. Provide 45 degree metal stud Diagonal Bracing @ 48" (1219 mm) O.C. From top of stud wall to structure above.
- 10 New Plumbing Wall to 6" Above Ceiling
20 Ga 6" (152 mm) metal studs 16" (406 mm) O.C. with 5/8" (16 mm) moisture resistant gypsum board on both sides to drywall ceiling above And/ OR to min. 6" above lay-in ceiling as applicable. Secure moisture resistant gypsum board to studs with drywall screws at 10" (254 mm) O.C. at panel edges and 12" (305 mm) O.C. at intermediate supports. Provide 45 degree metal stud Diagonal Bracing @ 48" (1219 mm) O.C. From top of stud wall to structure above.
- 11 New Partial Height Wall - Heavier Gauge Stud To 4'-0"
16 Ga 3-5/8" (92 mm) metal studs 16" (406 mm) O.C. with 5/8" (16 mm) moisture resistant gypsum board on both sides. Drywall screws @ 12" (305 mm) O.C.
- 12 New Partition Wall to structure Above
20 Ga 3-5/8" (92 mm) metal studs 16" (406 mm) O.C. to structure with 5/8" (16 mm) plywood substrate on one side to structure above and moisture resistant gypsum board on other side to 6" above ceiling. Secure gypsum board and plywood substrate to studs with drywall screws at 10" (254 mm) O.C. at panel edges and 12" (305 mm) O.C. at intermediate supports.
- 13 New Furred Wall to 6" Above Ceiling
20 Ga 3-5/8" (92 mm) metal studs 16" (406 mm) O.C. with 5/8" (16 mm) moisture resistant gypsum board on one side to underside of gypsum board ceiling. Secure gypsum board to studs with drywall screws at 10" (254 mm) O.C. at panel edges and 12" (305 mm) O.C. at intermediate supports.
- 14 New Partition Wall to Structure Above
20 Ga 3-5/8" (92 mm) metal studs 16" (406 mm) O.C. to structure with 5/8" (16 mm) moisture resistant gypsum board on one side to 6" above ceiling and other side to structure above. Secure gypsum board to studs with drywall screws at 10" (254 mm) O.C. at panel edges and 12" (305 mm) O.C. at intermediate supports.

- 15 New Partition Wall to 6" Above Ceiling
20 Ga 3-5/8" (92 mm) metal studs 16" (406 mm) O.C. with 5/8" (16 mm) moisture resistant gypsum board on one side to 6" above ceiling and other side to underside of gypsum board ceiling. Secure gypsum board to studs with drywall screws at 10" (254 mm) O.C. at panel edges and 12" (305 mm) O.C. at intermediate supports. Provide 45 degree metal stud Diagonal Bracing @ 48" (1219 mm) O.C. From top of stud wall to structure above.
- 16 New Partition Wall to 6" Above Ceiling
20 Ga 6" (152 mm) metal studs 16" (406 mm) O.C. with 5/8" (16 mm) moisture resistant gypsum board on both sides to 6" above ceiling. Secure gypsum board to studs with drywall screws at 10" (254 mm) O.C. at panel edges and 12" (305 mm) O.C. at intermediate supports. Provide 45 degree metal stud Diagonal Bracing @ 48" (1219 mm) O.C. From top of stud wall to structure above.

NOTE:
SEE SHEET A-501 & A-502 FOR WALL CONSTRUCTION DETAILS.

WALL BLOCKING KEY

SYMBOL	ITEM	WEIGHT	HEIGHT	APPROXIMATE WIDTH
A	Workroom Handsink	125LBS	3'-0" to 3'-4"	5'-7" in front of 3-Comp Sink
B	Shelves Above 3-Comp Sink	200LBS	5'-8" to 6'-0"	6'-0" Above 3-Comp Sink
C	Shelves and Data Rack at Manager's Desk	300LBS	3'-9" to 7'-2"	7'-0" Centered Above Manager's Desk Data Rack
D	Restroom Grab Bars	250LBS	2'-6" to 3'-0"	5'-0" Around WC
E	Restroom Hand Sink	200LBS	3'-0" to 3'-4"	2'-6" Behind Sink
F	Restroom Hand Dryer	200LBS	3'-0" to 4'-0"	3'-0" Starting 6" From Corner
G	Water Filtration System	200LBS	4'-0" to 6'-6"	See Restroom Details
H	Diaper Changing Station	50LBS	3'-4" to 4'-0"	See Restroom Details
I	CBE Shelves	300LBS	5'-0" to 5'-6"	Extent of Backbar Upper Casework
J	DT Cubby	200LBS	3'-0" to 7'-6"	Extent of Backbar Upper Casework
K	Work/Community	100LBS	3'-4" to 8'-8"	Extent of Art/Mural Frame

- Provide 2x6 or 2x8 wood stud blocking as required to support any wall attachments.
See interior elevations for correct locations.

INTERIOR FLOOR PLAN NOTES

- A. GENERAL CONTRACTOR TO VERIFY ALL DIMENSIONS AND NOTIFY STARBUCKS CONSTRUCTION MANAGER OF ANY DISCREPANCIES PRIOR TO CONSTRUCTION. ALL DIMENSIONS TO BE TAKEN FROM DESIGNATED DATUM POINT.
 - B. GENERAL CONTRACTOR TO PROVIDE FIRE TREATED WOOD STUD BLOCKING, OR EQUIVALENT TO SUPPORT ANY WALL ATTACHMENT AND/OR SIGNAGE.
 - C. ALL DOORS TO PROVIDE 32" MINIMUM CLEAR OPENING WHEN OPENED TO 90 DEGREE POSITION UNLESS OTHERWISE NOTED.
 - D. VERIFY ALL EXISTING DOORS, HARDWARE AND FRAMES MEET STARBUCKS AND/OR CODE REQUIREMENTS.
 - E. INSTALL 5/8" MOISTURE RESISTANT GYPSUM BOARD ON BACKBAR WALL PER SPECIFICATION.
 - F. ALL DIMENSIONS ARE TO FINISHED FACE UNLESS SHOWN OTHERWISE.
 - G. STARBUCKS VENDOR TO PROVIDE HARDWARE SCHEDULE AND HARDWARE COMPONENTS TO INSTALL.
 - H. "PRIOR TO WALL CUTTING, CALL THROUGH SLAB TO DETERMINE THE THICKNESS. IF THICKNESS EXCEEDS 5", DRILL THROUGH CUT. REPORT FINDINGS TO ARCHITECT FOR FURTHER EVALUATION."
- EXISTING STOREFRONT DOOR.
ELECTRICAL PANELS TO GC CONFIRM WITH WL AS INDICATED. MAINTAIN MINIMUM CLEARANCES AS REQUIRED BY CODE. REFER TO ELECTRICAL DWGS.
EXISTING 42" SERVICE DOOR.
ALIGN FACE OF FINISHED WALL.
EXISTING STOREFRONT WINDOW SYSTEM.
GC TO INSTALL REINFORCED CONCRETE FLOOR SLAB AND VAPOR BARRIER OVER EXISTING COMPACTED FILL. SEE SPECIFICATIONS.
CONSTRUCT NEW 4'-0" HIGH PARTIAL-HEIGHT WALL AS INDICATED. PROVIDE KNEE BRACE KIT #SKB AS MANUFACTURED BY PITCON INDUSTRIES @ 4'-0" O.C. MAXIMUM FINISH ALL EXPOSED EDGES.
EXISTING DT WINDOW.
PROVIDE FRT PLYWOOD BACKING FOR WOOD PANELING AS REQUIRED, REFER TO INTERIOR ELEVATIONS.

INTERIOR WALL LEGEND

- NEW FULL HEIGHT WALL
- NEW PARTIAL HEIGHT WALL
- EXISTING WALL
- EXISTING COLUMN
- WALL TAG
- WALL BLOCKING KEY

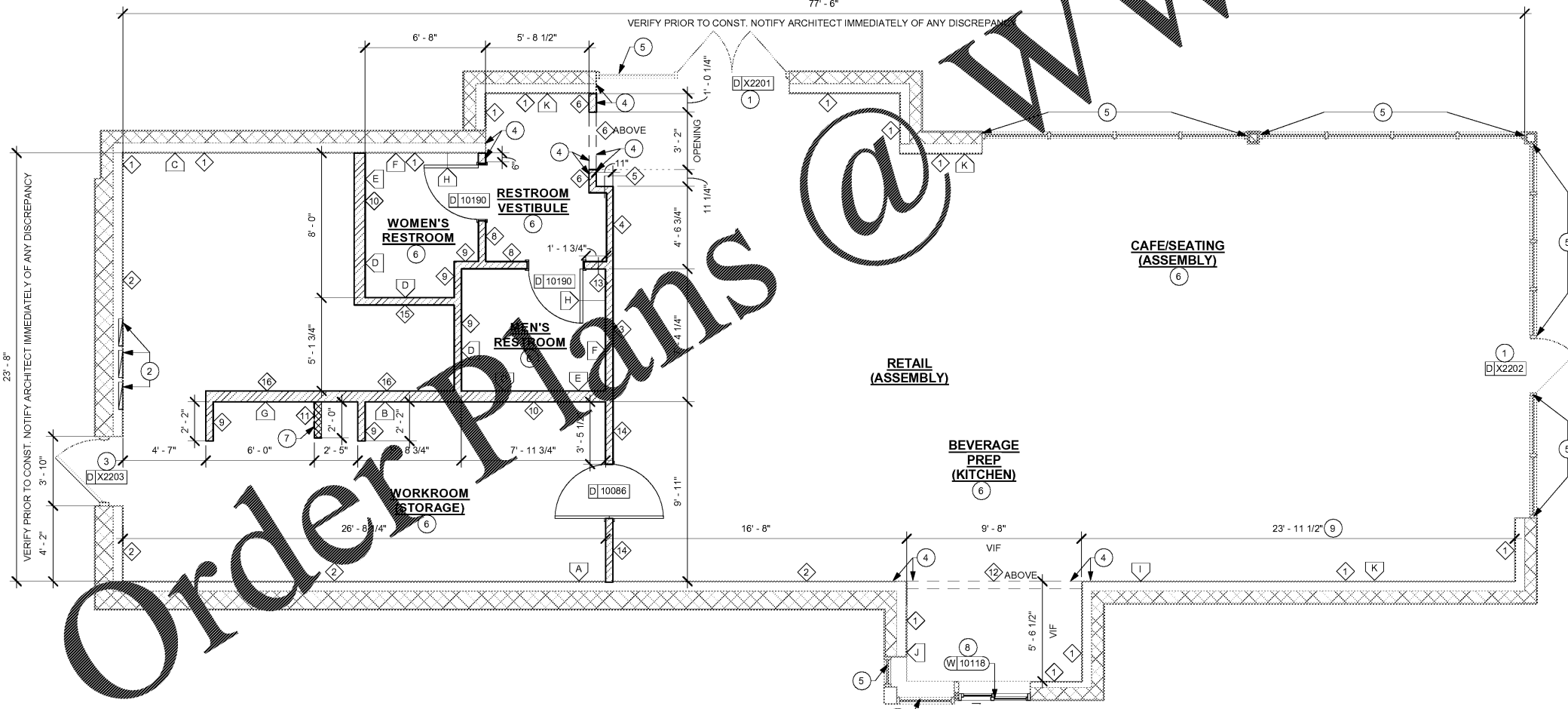

1 FLOOR PLAN
Scale: 1/4" = 1'-0"

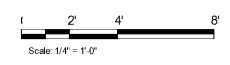

STARBUCKS
2401 UTAH AVENUE SOUTH
SEATTLE, WASHINGTON 98134
(206) 318-1575

THESE DRAWINGS AND SPECIFICATIONS ARE CONFIDENTIAL AND SHALL REMAIN THE SOLE PROPERTY OF STARBUCKS CORPORATION, WHICH IS THE OWNER OF THE COPYRIGHT IN THIS WORK. THEY SHALL NOT BE REPRODUCED (IN WHOLE OR IN PART), SHARED WITH THIRD PARTIES OR USED IN ANY MANNER ON OTHER PROJECTS OR EXTENSIONS TO THIS PROJECT WITHOUT THE PRIOR WRITTEN CONSENT OF STARBUCKS CORPORATION. THESE DRAWINGS AND SPECIFICATIONS ARE INTENDED TO EXPRESS DESIGN INTENT FOR A PROTOTYPICAL STARBUCKS STORE (WHICH IS SUBJECT TO CHANGE AT ANY TIME) AND DO NOT REFLECT ACTUAL SITE CONDITIONS. NEITHER PARTY SHALL HAVE ANY OBLIGATION NOR LIABILITY TO THE OTHER (EXCEPT STATED ABOVE) UNTIL A WRITTEN AGREEMENT IS FULLY EXECUTED BY BOTH PARTIES.

STARBUCKS TEMPLATE VERSION I2018.01.26

Design Forum Architects Inc.
700 W. Pale Rose Way, Suite 400
Cincinnati, OH 45203
Tel: (513) 421-2210
Donald J. Rehrman
Architect License
License: AR0017303

Design Forum Engineering
700 W. Pale Rose Way, Suite 400
Cincinnati, OH 45203
Tel: (513) 421-2210
Timothy L. Rabinovich
Professional Engineer
License: 62078

PROJECT NAME:
**CYPRESS GARDENS
BLVD & ROOSEVELT**

PROJECT ADDRESS:
**5709 CYPRESS GARDENS BLVD
WINTER HAVEN, FL 33884**

STORE #: 50175
PROJECT #: 73763-001
ISSUE DATE: 04/20/2018
DESIGN PROGRAM: LAIS BRITO
MANAGER: STARBUCKS
LEEDO AP: STARBUCKS
PRODUCTION DESIGNER: MICHAEL B. SARKA
CHECKED BY: ANA COSTANZO

Revision Schedule			
Rev	Date	By	Description

SHEET TITLE:
FLOOR PLAN

SCALE: 1/4" = 1'-0"

SHEET NUMBER:
A-101