

LEGEND:

- Travel Distance
- Exit Light (See Reflected Ceiling Plan)
- Wall Mounted Emergency Light (See Reflected Ceiling Plan)
- ADA
- Clear Floor Space for Accessibility

FLAME SPREAD RATING:

Flame spread rating for all proposed interior finishes shall comply with local building code.

INTERIOR FINISH NOTES:

- Interior wall and ceiling finish materials shall be Class C with a flame spread rating less than 200 and smoke developed less than 450.
- Floor Coverings in the exit path of all common areas shall meet Class A requirements.

OCCUPANCY TYPE LEGEND

PROJECT DESCRIPTION: NEW TENANT IMPROVEMENT

BUILDING HEIGHT: 1 STORY

BUILDING AREA: 2247 SF

BUILDING USE: COFFEE SHOP

ZONING: C-3 COMMERCIAL HIGHWAY - PROPOSED PUD

TYPE OF USE: COFFEE SHOP

TYPE OF OCCUPANCY: A-2 ASSEMBLY

OCCUPANCY LOAD:

RETAIL (ASSEMBLY):	103 SF / 5	=	21
CAFE/SEATING (ASSEMBLY):	548 SF / 15	=	37
BEVERAGE/PREP (KITCHEN):	190 SF / 20	=	1
WORKROOM (STORAGE):	471 SF / 300	=	2
TOTAL OCCUPANCY:			41

TOTAL SQUARE FOOTAGE: 2247 SF

TOTAL INTERIOR SEATS: 42

EXTERIOR SEASONAL SEATING: 52

EXIT CAPACITY:

EXIT 1: 72" WIDE
EXIT 2: 36" WIDE
EXIT 3: 42" WIDE
TOTAL EXIT WIDTH PROVIDED: 150 IN
1.2 X TOTAL OCCUPANTS = 12.2 IN REQUIRED

TRAVEL DISTANCE: ALLOWED TRAVEL DISTANCE: 200'-0"
ACTUAL TRAVEL DISTANCE: 86'-8"
86'-8" < 200'-0" THEREFORE COMPLIES

NUMBER OF EXITS: MIN. NUMBER OF EXITS REQUIRED: 2
NUMBER OF EXITS PROVIDED: 3



STARBUCKS
2401 UTAH AVENUE SOUTH
SEATTLE, WASHINGTON 98134
(206) 318-1575

THESE DRAWINGS AND SPECIFICATIONS ARE CONFIDENTIAL AND SHALL REMAIN THE SOLE PROPERTY OF STARBUCKS CORPORATION, WHICH IS THE OWNER OF THE COPYRIGHT IN THIS WORK. THEY SHALL NOT BE REPRODUCED (IN WHOLE OR IN PART), SHARED WITH THIRD PARTIES OR USED IN ANY MANNER ON OTHER PROJECTS OR EXTENSIONS TO THIS PROJECT WITHOUT THE PRIOR WRITTEN CONSENT OF STARBUCKS CORPORATION. THESE DRAWINGS AND SPECIFICATIONS ARE INTENDED TO EXPRESS DESIGN INTENT FOR A PROTOTYPICAL STARBUCKS STORE (WHICH IS SUBJECT TO CHANGE AT ANYTIME) AND DO NOT REFLECT ACTUAL SITE CONDITIONS. NEITHER PARTY SHALL HAVE ANY OBLIGATION NOR LIABILITY TO THE OTHER (EXCEPT STATED ABOVE) UNTIL A WRITTEN AGREEMENT IS FULLY EXECUTED BY BOTH PARTIES.

STARBUCKS TEMPLATE VERSION |2018.01.26

Design Forum Architects Inc.
700 W. Pete Rose Way, Suite 400
Cincinnati, OH 45203
Tel: (513) 421-2210

Donald J. Reithman
Architect in Charge
License: AR0017303

Design Forum Engineering
700 W. Pete Rose Way, Suite 400
Cincinnati, OH 45203
Tel: (513) 421-2210

Timothy L. Rasterding, PE
Professional Engineer
License: 62078

PROJECT NAME:
CYPRESS GARDENS
BLVD & ROOSEVELT

PROJECT ADDRESS:
5709 CYPRESS GARDENS BLVD
WINTER HAVEN, FL 33884

STORE #: 50175
PROJECT #: 73763-001
ISSUE DATE: 04/20/2018
DESIGN PROGRAM MANAGER: LAIS BRITO
LEEDO AP: STARBUCKS
PRODUCTION DESIGNER: MICHAEL B. SARKA
CHECKED BY: ANA COSTANZO

Revision Schedule

Rev	Date	By	Description

SHEET TITLE:
LIFE SAFETY PLAN

SCALE: 1/4" = 1'-0"

SHEET NUMBER:
G-002

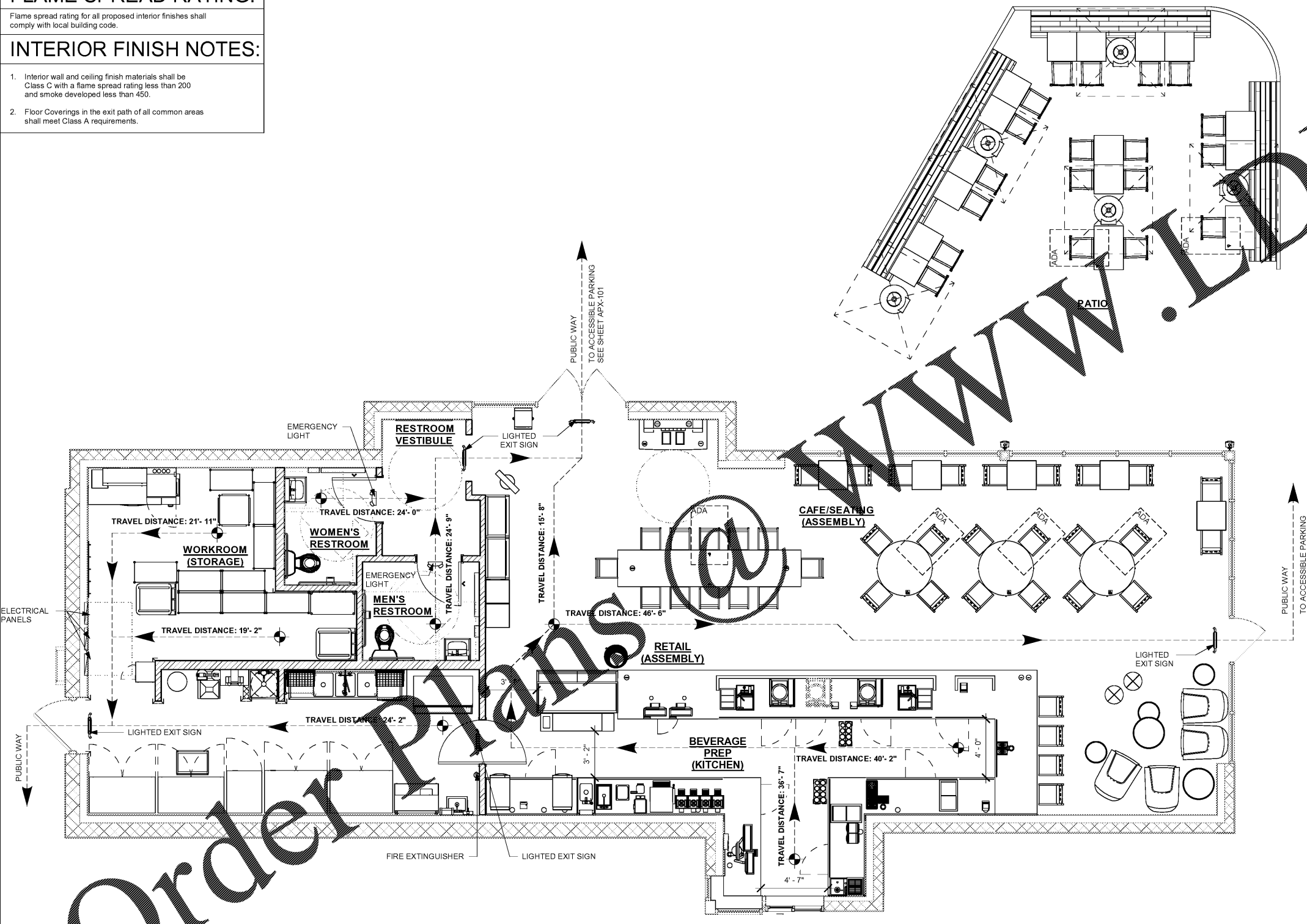

1 LIFE SAFETY PLAN
Scale: 1/4" = 1'-0"

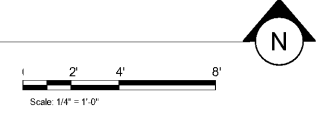

5/2/2018 12:06:25 PM C:\Users\daniel.green\Documents\Starbucks_Cypress Gardens & Roosevelt_FL_2017_daniel.green@interbrand.com.rvt