

GENERAL NOTES

1. ALL SITE WIRING SHALL BE MINIMUM #10 AWG (UNLESS OTHERWISE NOTED).
2. WIRE MASTER/SLAVE DIESEL DISPENSERS FOR SIMULTANEOUS OPERATION.
3. ALL ELECTRICAL ON THIS SHEET SHALL BE PROVIDED BY FUEL CONTRACTOR.
4. ALL WIRING TO BOTH U/L SUBMERSIBLE PUMPS SHALL BE SHIELDED, ANIXTER PVC NYLON INSULATION SHIELDED, #2A-1404S (14 GA.), #2A-1204S (12 GA.) USE 14 GA. FOR RUNS UP TO 200 FEET, AND 12 GA. FOR RUNS OVER 200 FEET.
5. CONNECT J-BOXES AT SUBMERSIBLE PUMPS TO INTEGRAL DISCONNECT.
6. WIRING SHALL BE ANIXTER SHIELDED
IF DISTANCE IS SHORTER THAN 200' USE #14 GA.
IF DISTANCE IS GREATER THAN 200' USE #12 GA.
7. THE ENTIRE RUN OF CONDUITS SERVING HAZARDOUS AREAS SHALL BE RIGID AND SHALL MEET THE GROUNDING AND BONDING REQUIREMENTS OF NEC 250.100. PVC CONDUIT WILL ONLY BE ALLOWED IN UNDERGROUND POSITIONS IF ALL PROVISIONS OF NEC 514.8 EXC. 2 ARE MET.

⊗ SHEET KEYNOTES

1. GASOLINE OR DIESEL FUEL SYSTEM EMERGENCY SHUT OFF (ESO). FIELD VERIFY FINAL LOCATIONS WITH FIRE MARSHAL. INSTALL AT EXTERIOR CANOPIES ONLY IF REQUIRED BY FIRE MARSHAL.
2. SEE NOTED.
3. REFER TO SHEET E-4.1 FOR EXACT LOCATIONS.
4. PROVIDE AND INSTALL 3/4" CONDUIT WITH 4-#12 WIRES FROM WATER PROOF J-BOX TO BUILDING FOR OIL/WATER SEPARATOR ALARM PANEL. SEE SHEET E-4.1 FOR CONNECTION.
5. PROVIDE CONNECTION TO H-VALVE SUMP. PROVIDE A 1" CONDUIT FOR POWER AND A 1" CONDUIT WITH PULL STRING FOR DATA. SEE FUEL ELECTRICAL DRAWING FE-3 FOR DETAILS.
6. VERIFY LOCATION OF BIO-DIESEL CONTROL PEDESTAL WITH SYSTEM INSTALLER. PROVIDE A 1" CONDUIT FOR 120V POWER AND A 1" CONDUIT TO ELEC. ROOM FOR DATA CABLES.
7. INSTALL FIELD CIRCUITS SHOWN FOR FUEL EQUIPMENT FROM ISO-FUEL PANEL 'FP' TO THE EQUIPMENT. SEE FUEL ELECTRICAL DRAWING FE-3 FOR SPECIFIC DETAILS.

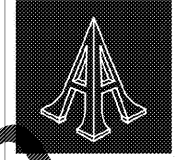

Pascal Aughtry & Associates, PC

405.463.3434
 Fax 405.463.3493
 937 East Britton Road
 Oklahoma City, OK 73114
 pascalarch.com



Love's
Travel Stops

A NEW TRAVEL STOP
 STORE NO. 735
 CALHOUN, GA

Revisions:	
No.	Date

Project No.: LVS - 18735
 Date: 05-22-18
 Sheet No.:

E-1.2
 OF:

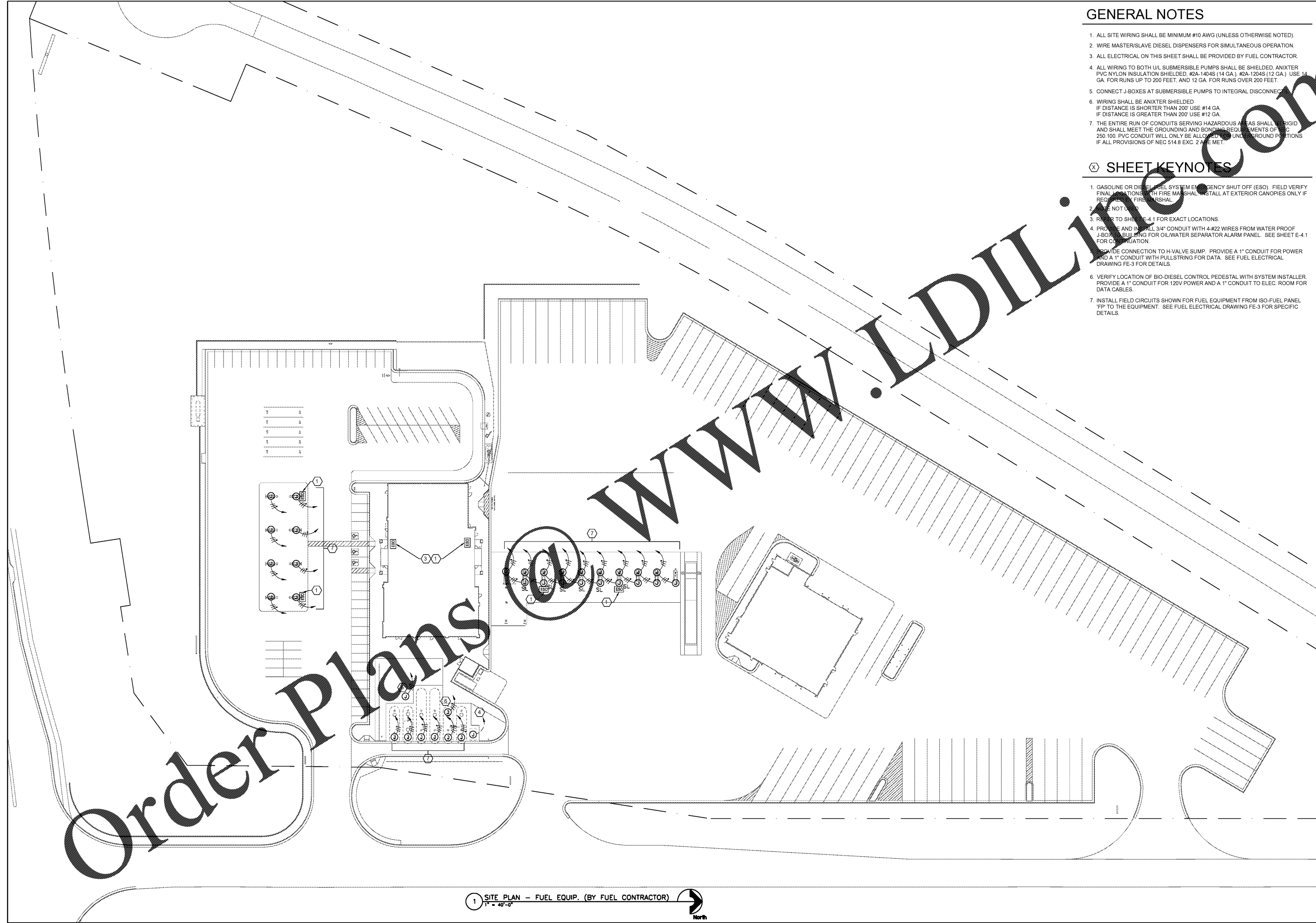

Order Plans

1 SITE PLAN - FUEL EQUIP. (BY FUEL CONTRACTOR)
 1" = 40'-0"