

**EXISTING LEGEND**

□	EXISTING BUILDING	○	EXISTING MANHOLE
□	EXISTING DRIVE	○	EXISTING CURB
□	EXISTING SIDEWALK	○	EXISTING GUTTER
□	EXISTING STORM SEWER	○	EXISTING STORM INLET
□	EXISTING WATER MAIN	○	EXISTING WATER VALVE
□	EXISTING GAS MAIN	○	EXISTING GAS VALVE
□	EXISTING ELECTRIC MAIN	○	EXISTING ELECTRIC VALVE
□	EXISTING TELEPHONE MAIN	○	EXISTING TELEPHONE VALVE
□	EXISTING CABLE MAIN	○	EXISTING CABLE VALVE
□	EXISTING FENCE	○	EXISTING SIGN
□	EXISTING LIGHT FIXTURE	○	EXISTING LIGHT POLE
□	EXISTING SIGN	○	EXISTING SIGN POLE
□	EXISTING TREE	○	EXISTING TREE
□	EXISTING BUSH	○	EXISTING BUSH
□	EXISTING GRASS	○	EXISTING GRASS
□	EXISTING ASPHALT	○	EXISTING ASPHALT
□	EXISTING CONCRETE	○	EXISTING CONCRETE
□	EXISTING BRICK	○	EXISTING BRICK
□	EXISTING STONE	○	EXISTING STONE
□	EXISTING SAND	○	EXISTING SAND
□	EXISTING GRAVEL	○	EXISTING GRAVEL
□	EXISTING DIRT	○	EXISTING DIRT
□	EXISTING ROCK	○	EXISTING ROCK
□	EXISTING WATER	○	EXISTING WATER

**LEGEND FOR PROPOSED IMPROVEMENTS**

---	PROPERTY LINE / R.O.W.
▬	PROPOSED BUILDING
▬	PROPOSED CURB AND GUTTER
▬	PROPOSED INLET
▬	PROPOSED CURB INLET
▬	PROPOSED STORM SEWER
12.10	PROPOSED ELEVATION
—S—	PROPOSED SLOPE

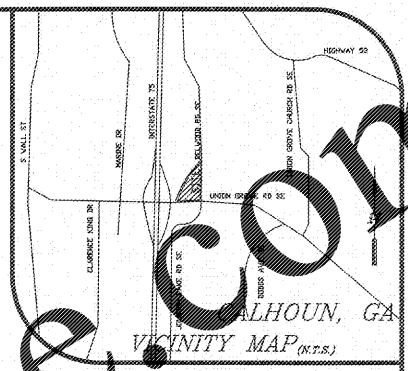

**RESOURCECONSULTING**  
 CIVIL ENGINEERING

6700 Jefferson Highway - Suite 4A  
 Baton Rouge, Louisiana 70806  
 ResourceConsulting@att.net  
 Tel: (225) 761-9909; Fax (225) 766-6672

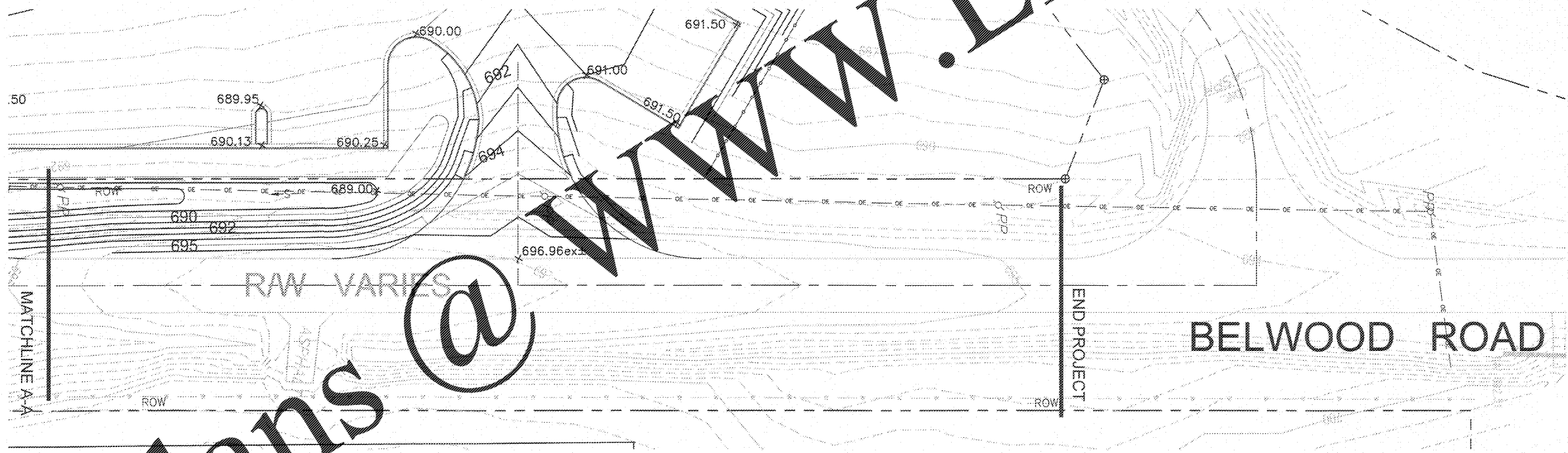

**Order Plans @**

**BELWOOD ROAD IMPROVEMENTS**

**DRIVEWAY PLAN**

**DW-4**



THIS DRAWING IS NOT VALID WITHOUT AN ORIGINAL BLUE INK SIGNATURE AND ORIGINAL HANDWRITTEN DATE OF A LICENSED PROFESSIONAL ENGINEER.

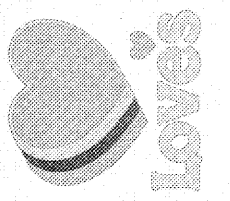

**LOVE'S TRAVEL STOP**  
 I-75 EXIT 310 @ UNION GROVE ROAD  
 CALHOUN, GEORGIA

031 - Calhoun GA I-75 exit 310@Union Glen NECDesign161031v11 RIP.dwg, 5/22/2018 8:12:37 AM, Dustyn, copyright Resource Consulting, LLC