

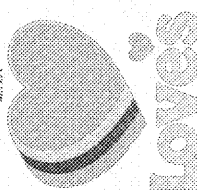

LOVE'S TRAVEL STOP
 I-75 EXIT 310 @ UNION GROVE ROAD
 CALHOUN, GEORGIA

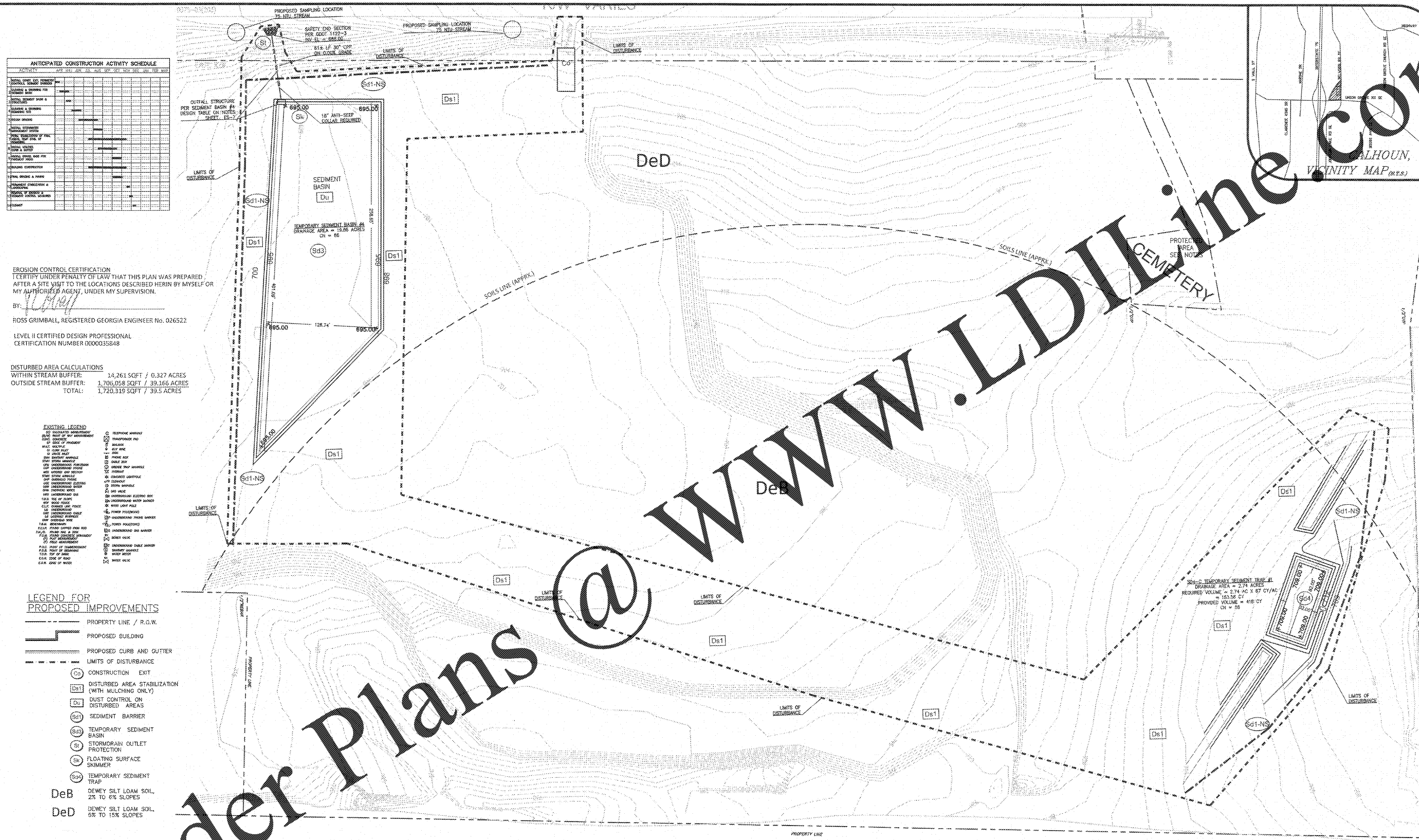

ES-1B



ANTICIPATED CONSTRUCTION ACTIVITY SCHEDULE

ACTIVITY	START DATE	END DATE
Site Preparation	05/22/2018	06/15/2018
Clearing	06/15/2018	07/15/2018
Grading	07/15/2018	08/15/2018
Structural Work	08/15/2018	09/15/2018
Final Site Work	09/15/2018	10/15/2018

EROSION CONTROL CERTIFICATION
 I CERTIFY UNDER PENALTY OF LAW THAT THIS PLAN WAS PREPARED AFTER A SITE VISIT TO THE LOCATIONS DESCRIBED HEREIN BY MYSELF OR MY AUTHORIZED AGENT, UNDER MY SUPERVISION.
 BY: *[Signature]*
 ROSS GRIMBALL, REGISTERED GEORGIA ENGINEER No. 026522
 LEVEL II CERTIFIED DESIGN PROFESSIONAL
 CERTIFICATION NUMBER 0000035848

DISTURBED AREA CALCULATIONS
 WITHIN STREAM BUFFER: 14,261 SQFT / 0.327 ACRES
 OUTSIDE STREAM BUFFER: 1,706,058 SQFT / 39.166 ACRES
 TOTAL: 1,720,319 SQFT / 39.5 ACRES

- EXISTING LEGEND**
- Existing Building
 - Existing Curb and Outlet
 - Existing Limits of Disturbance
 - Existing Construction Exit
 - Existing Disturbed Area Stabilization
 - Existing Dust Control on Disturbed Areas
 - Existing Sediment Barrier
 - Existing Temporary Sediment Basin
 - Existing Stormdrain Outlet Protection
 - Existing Floating Surface Skimmer
 - Existing Temporary Sediment Trap

- LEGEND FOR PROPOSED IMPROVEMENTS**
- Property Line / R.O.W.
 - Proposed Building
 - Proposed Curb and Outlet
 - Limits of Disturbance
 - Construction Exit
 - Disturbed Area Stabilization (with mulching only)
 - Dust Control on Disturbed Areas
 - Sediment Barrier
 - Temporary Sediment Basin
 - Stormdrain Outlet Protection
 - Floating Surface Skimmer
 - Temporary Sediment Trap
 - DeB DEWEY SILT LOAM SOIL, 2% TO 6% SLOPES
 - DeD DEWEY SILT LOAM SOIL, 6% TO 15% SLOPES



81
 Know what's below.
 Call before you dig.



THIS DRAWING IS NOT VALID WITHOUT AN ORIGINAL BLUE INK SIGNATURE AND ORIGINAL HANDWRITTEN DATE OF A LICENSED PROFESSIONAL ENGINEER.

ES&PC CLEARING PHASE

ES-1B